

Legend

- Project Boundary
- Land in respect of which rights only are being created
- Land to be acquired
- Land Excluded

Reproduced from Ordnance Survey digital map data © Crown copyright 2023.
All rights reserved. OS Licence number 0100059731.

Coordinate System: British National Grid	Plan center
Projection: Transverse Mercator	Eastings: 438239
Datum: OSGB 1936	Northings: 390314
Units: metre	OS Grid: SK 382 903

A	22/11/2023	FINAL	MEW	NS
Version	Date	Remarks	Author	Checked

Scale at A1: 1:1250
Scale at A3: 1:2500
Paper Size: A1



The National Grid Electricity Transmission plc (Pitsmoor-Wincobank-Templeborough 275 kV Cable Replacement Scheme)
Compulsory Purchase Order 2023
Certified by the Secretary of State for the Department for Energy Security and Net Zero

Date:
Signature:

The common seal of National Grid Electricity Transmission plc was affixed on the day of in the presence of

.....
(Member of the Board Sealing Committee and Authorised Signatory)

Dated

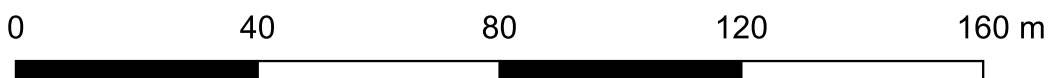

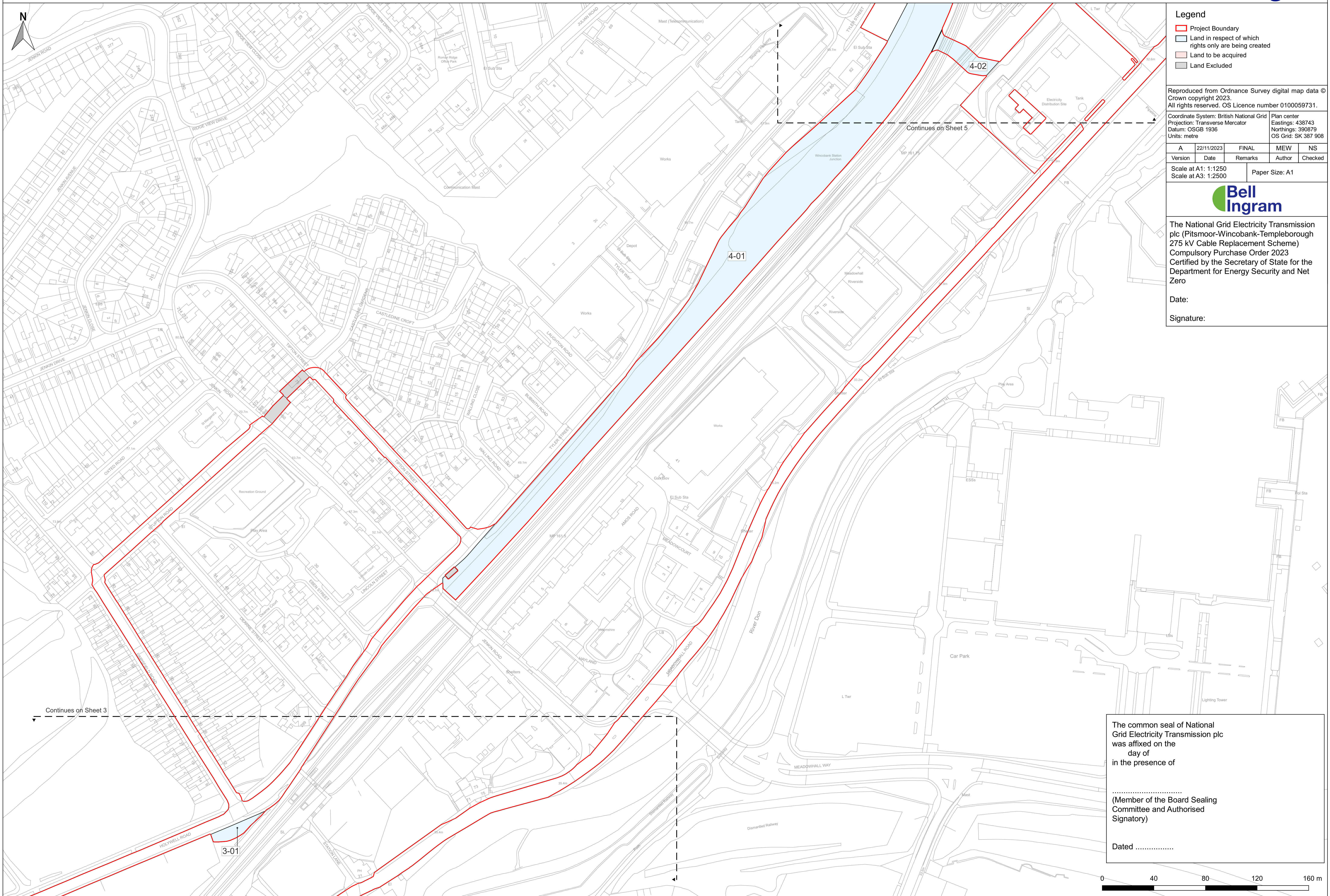

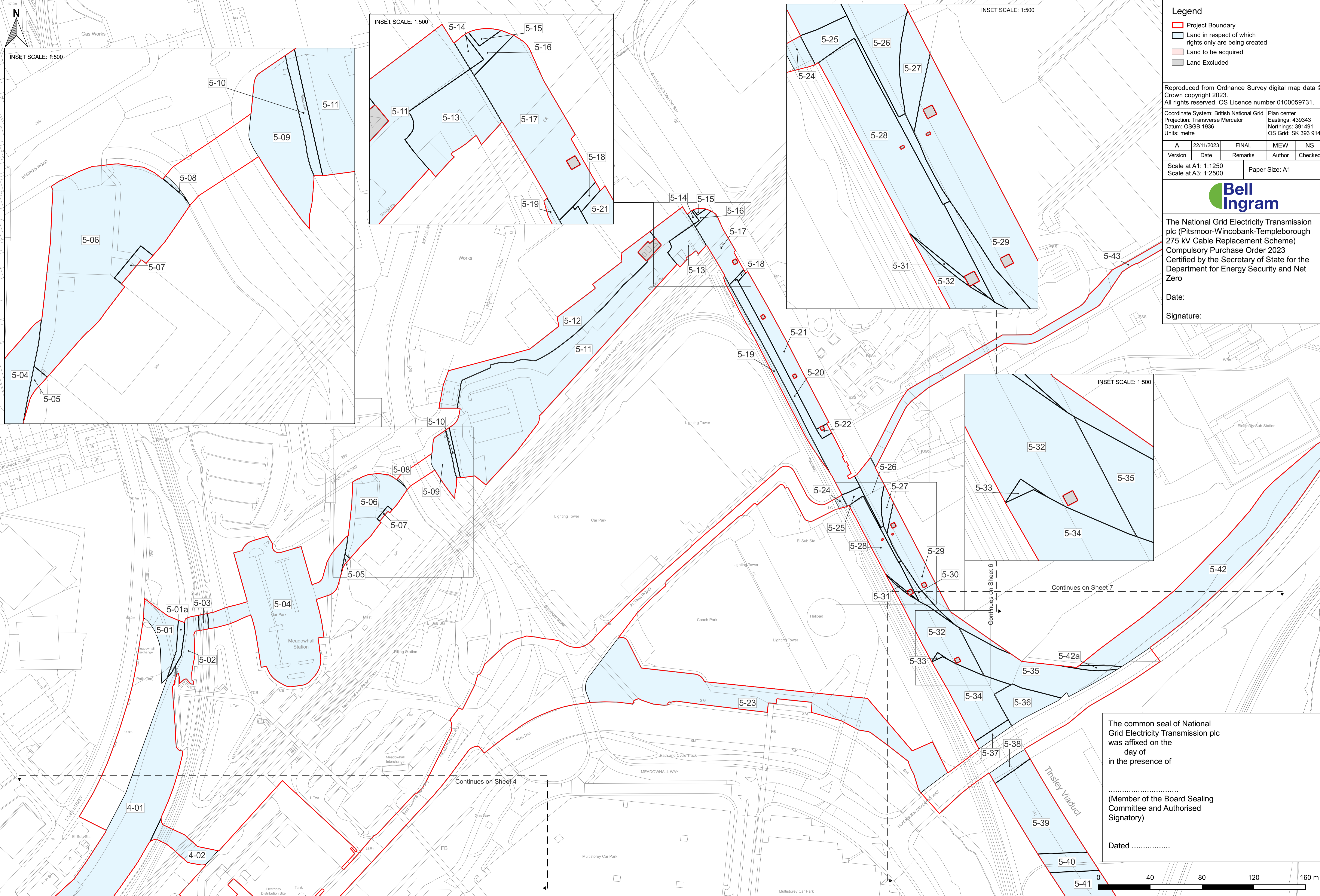

Legend

- Project Boundary
- Land in respect of which rights only are being created
- Land to be acquired
- Land Excluded

Reproduced from Ordnance Survey digital map data © Crown copyright 2023.
All rights reserved. OS Licence number 0100059731.

Coordinate System: British National Grid	Plan center Eastings: 439343
Projection: Transverse Mercator	Northings: 391491
Datum: OSGB 1936	OS Grid: SK 393 914
Units: metre	

A	22/11/2023	FINAL	MEW	NS
Version	Date	Remarks	Author	Checked

Scale at A1: 1:1250
Scale at A3: 1:2500
Paper Size: A1



The National Grid Electricity Transmission plc (Pitsmoor-Wincobank-Templeborough 275 kV Cable Replacement Scheme) Compulsory Purchase Order 2023
Certified by the Secretary of State for the Department for Energy Security and Net Zero

Date: _____
Signature: _____

The common seal of National Grid Electricity Transmission plc was affixed on the _____ day of _____ in the presence of _____
(Member of the Board Sealing Committee and Authorised Signatory)
Dated _____

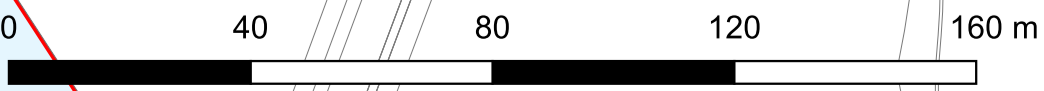

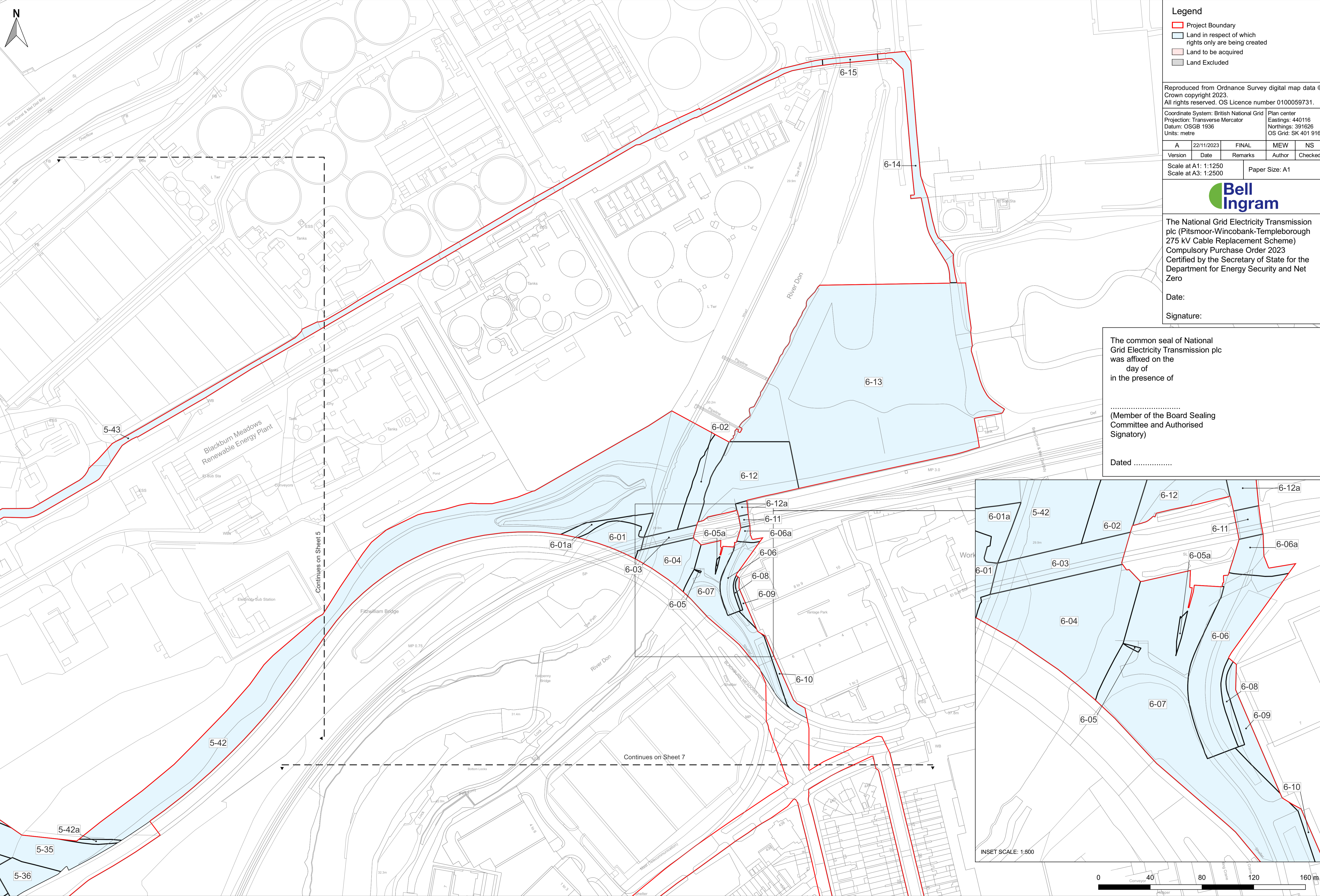

Legend

- Project Boundary
- Land in respect of which rights only are being created
- Land to be acquired
- Land Excluded

Reproduced from Ordnance Survey digital map data © Crown copyright 2023.
All rights reserved. OS Licence number 0100059731.

Coordinate System: British National Grid
Projection: Transverse Mercator
Datum: OSGB 1936
Units: metre

Plan center
Eastings: 440116
Northings: 391626
OS Grid: SK 401 916

A	22/11/2023	FINAL	MEW	NS
Version	Date	Remarks	Author	Checked

Scale at A1: 1:1250
Scale at A3: 1:2500

Paper Size: A1



The National Grid Electricity Transmission plc (Pitsmoor-Wincobank-Templeborough 275 kV Cable Replacement Scheme) Compulsory Purchase Order 2023
Certified by the Secretary of State for the Department for Energy Security and Net Zero

Date:

Signature:

The common seal of National Grid Electricity Transmission plc was affixed on the day of in the presence of

(Member of the Board Sealing Committee and Authorised Signatory)

Dated

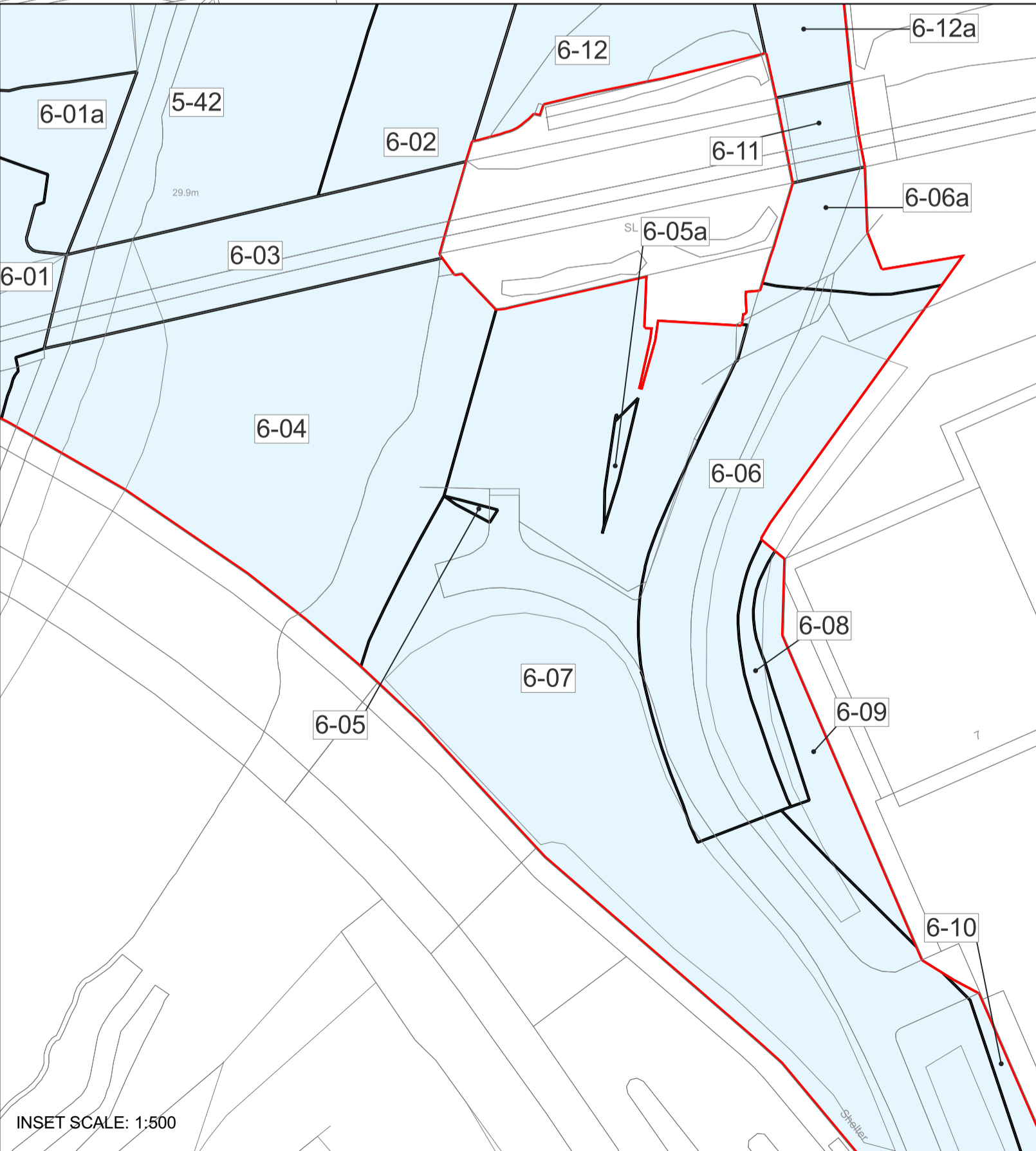

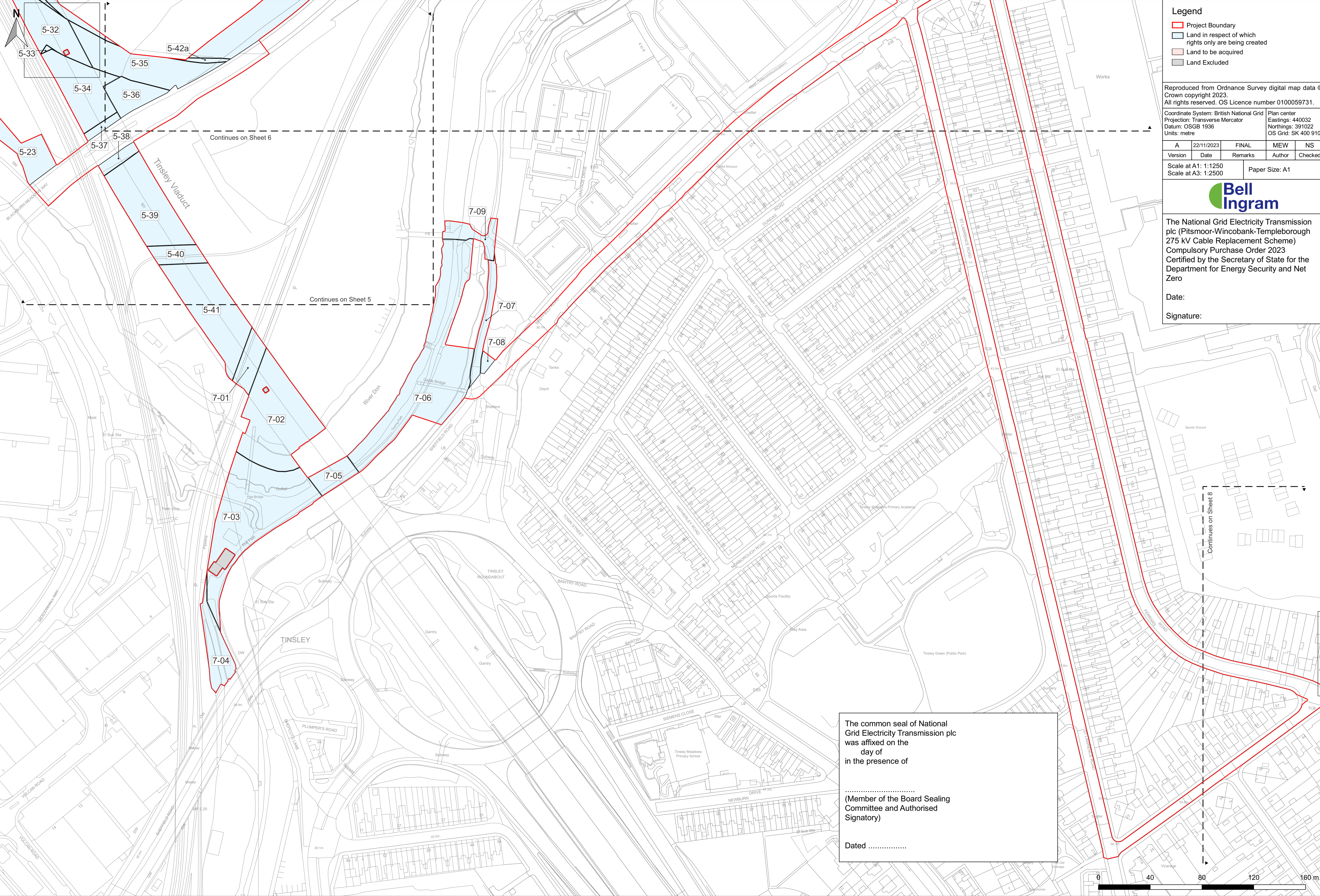

Legend

- Project Boundary
- Land in respect of which rights only are being created
- Land to be acquired
- Land Excluded

Reproduced from Ordnance Survey digital map data © Crown copyright 2023.
All rights reserved. OS Licence number 0100059731.

Coordinate System: British National Grid	Plan center
Projection: Transverse Mercator	Eastings: 440032
Datum: OSGB 1936	Northing: 391022
Units: metre	OS Grid: SK 400 910

Version	Date	Remarks	Author	Checked
A	22/11/2023	FINAL	MEW	NS

Scale at A1: 1:1250
Scale at A3: 1:2500
Paper Size: A1



The National Grid Electricity Transmission plc (Pitsmoor-Wincobank-Templeborough 275 kV Cable Replacement Scheme) Compulsory Purchase Order 2023
Certified by the Secretary of State for the Department for Energy Security and Net Zero

Date: _____
Signature: _____

The common seal of National Grid Electricity Transmission plc was affixed on the _____ day of _____ in the presence of _____
(Member of the Board Sealing Committee and Authorised Signatory)
Dated _____

