

The Great Grid Upgrade

Proposed Electricity Substation and Overhead Line Works at Weston Marsh

Habitat Classification Survey Report

June 2026

nationalgrid

Proposed Electricity Substation and Overhead Line Works at Weston Marsh

Document control

Document Properties			
Organisation	Arup AECOM		
Approved by	National Grid		
Title	Habitat Classification Survey Report		
Document Register ID	GWNC-ARU-SS50-XXXXXX-RPT-ES-000013		
Data Classification	Public		

Version History			
Document	Version	Status	Description / Changes
May 2026	1.0	Final	First Issue
June 2026	2.0	Final	Second Issue - minor update to cross references

Contents

1.	Introduction	1
1.1	Overview	1
1.2	Summary of the Scheme	1
1.3	Purpose of this report	2
2.	Legislative and Policy Framework	4
2.1	Legislation and National Policy	4
	Natural Environment and Rural Communities Act 2006	4
	The Habitats Regulations	4
	Wildlife and Countryside Act 1981	5
	The Hedgerows Regulations	5
2.2	Regional and Local Policy	5
3.	Methodology	7
3.1	Desk Study	7
3.2	Survey Approach and Strategy	7
3.3	Field Surveys	7
	Habitat Classification	8
	Botanical recording	8
	Condition scoring	9
	Recording of trees	9
	Hedgerow Surveys	9
3.4	Assumptions and limitations	11
4.	Baseline and Evaluation	12
4.1	Desk Study	12
4.2	Field Surveys	12
	Ancient, veteran and notable trees	12
	Notable plants	12
	UK Habitat classification	12
	Hedgerow Survey	16
5.	Summary	18

Table 1.1	Components of the Proposed Development	1
Table 3.1	UK habitat classification hierarchy division - adapted from Butcher, B (et al.)	8
Table 4.1	Habitats of Principal Importance associated with the Scheme Site Boundary.	12
Table 4.2	Summary table of habitats identified within the Scheme Site Boundary	13
Table A.1	Summary table of habitats identified within the Scheme Site Boundary as shown on Figures 1A-1D	38

References	20
------------	----

Figure 1	Scheme Site Boundary	24
Figure 2A	UK Habitat Classification Plan – Substation Works	26
Figure 2B	UK Habitat Classification Plan – S37 4ZM Overhead Line Works	29
Figure 2C	UK Habitat Classification Plan – S37 2WS Overhead Line Works	32
Figure 2D	UK Habitat Classification Plan – Exempt Overhead Line Works	35

Appendix A	Habitats Identified within the Scheme Site Boundary
------------	---

1. Introduction

1.1 Overview

- 1.1.1 This Habitat Classification Survey Report has been prepared by National Grid Electricity Transmission plc (National Grid).
- 1.1.1 National Grid are proposing to undertake works to construct a new electricity substation, new sections of overhead line and modification of existing overhead lines west of the Spalding Tee-Point in the Weston Marsh area, within the administrative boundary of South Holland District Council (SHDC) in Lincolnshire.

1.2 Summary of the Scheme

- 1.2.1 In totality, the Scheme consists of four components, each planned to be progressed via separate consenting routes. These are summarised in **Table 1.1**.

Table 1.1 Components of the Proposed Development

Works Required	Consenting Regime
Construction of the new Air Insulated Substation (AIS) – 400kV Weston Marsh Substation A, associated landscaping and environmental mitigation works, drainage, highways and other associated works	Town and Country Planning Act 1990 (TCPA) (Ref 1) Component referred to as ' Substation Works '
Construction of new sections of overhead line to connect the new substation into the existing 4ZM overhead line. Removal of a section of the existing 4ZM overhead line. Other associated works.	Section 37 of the Electricity Act 1989 (Ref 2) and deemed consent pursuant to section 90(2) of the Town and Country Planning Act 1990 Component referred to as ' 4ZM Overhead Line Works '
Construction of a new section of overhead line to connect the existing 2WS overhead line into the new substation. Removal of a section of the existing 2WS overhead line Other associated works	Section 37 of the Electricity Act 1989 and deemed consent pursuant to section 90(2) of the Town and Country Planning Act 1990 Component referred to as ' 2WS Overhead Line Works '
Reconductoring works required on the existing 4ZM overhead line Two spans of temporary overhead lines	The Town and Country Planning (General Permitted Development) (England) Order 2015 (Ref 3) and The Overhead Lines (Exemption) (England and Wales) Regulations 2009 (Ref 4) Component referred to as ' Exempt Overhead Line Works '

- 1.2.2 The Substation Works will require consent from SHDC under the TCPA.
- 1.2.3 The S37 4ZM Overhead Line Works and S37 2WS Overhead Line Works (collectively referred to as the S37 Overhead Line Works) will require consent from the Secretary of State for Energy Security and Net Zero under Section 37 of the Electricity Act 1989 (Section 37) (Ref 2).
- 1.2.4 The Exempt Overhead Line Works constitute permitted development under Part 15 Class B of the Town and Country Planning (General Permitted Development) (England) Order 2015 (Ref 3) and The Overhead Lines (Exemption) (England and Wales) Regulations 2009 (Ref 4).
- 1.2.5 The Scheme Site Boundary, which consists of the land required to construct and operate the Scheme in its entirety, is illustrated on **Figure 1**. The areas of land required to construct and operate each individual component described in **Table 1.1** are also illustrated on **Figure 1**.
- 1.2.6 The Scheme in its totality is a standalone development to enable connection of the Outer Dowsing Offshore Wind Farm to the national electricity transmission system. Each component stated in **Table 1.1** above is required for the Scheme to fully function as part of the national electricity transmission system (NETS).

1.3 Purpose of this report

- 1.3.1 The purpose of this report is to present the results of habitat classification surveys undertaken and to inform the ecology baseline for the Scheme.
- 1.3.2 This Habitat Classification Survey Report has been prepared in support of the necessary consent applications required to deliver the Scheme. It has been informed by engagement between National Grid and the relevant consenting authorities.
- 1.3.3 The habitat classification survey data has been collected across the Scheme Site Boundary in its entirety. However, the survey results in **Section 4** and illustrated on **Figures 2A-2D** are presented in relation to each component of the Scheme as outline in **Table 1.1**. This approach enables the relevant consenting authority to readily identify and consider only those survey results that are associated with the application before them, whilst also maintaining a clear understanding of the Scheme in its wider context. It is noted that figures 2B and 2C illustrate temporary works which will be used to construct the S37 Overhead Line Works, namely localised highway improvements, the temporary on-site haul road from Stone Gate, construction compounds and associated temporary drainage. However, where these temporary works are also required to construct the Substation Works, the necessary consent is proposed to be secured via the TCPA Application for the Substation Works.
- 1.3.4 The objectives of this report are to:
- 1) Present desk study information of relevance to habitat classifications;
 - 2) detail the results of habitat classification surveys;
 - 3) detail the results of the hedgerow survey; and
 - 4) provide sufficient information to inform an assessment of potential impacts to habitats as a result of the Scheme.

- 1.3.5 The assessment of potential impacts to habitats and mitigation (where required) will be reported within the **Ecological Impact Assessment** [document number GWNC-ARU-SS50-XXXXXX-RPT-ES-000005].

2. Legislative and Policy Framework

2.1.0 Legislation and national and local planning policy relevant to the Scheme is described in the Planning, Design and Access Statement (TCPA application) and the Section 37 Statement (S37 applications). Key legislation and policy specifically relevant to habitat classification is summarised in the following sections.

2.1 Legislation and National Policy

2.1.1 A framework of international, national and local legislation and planning policy guidance exists to protect and conserve wildlife and habitats. Legislation relevant to and discussed within this report comprises:

- 1) Natural Environment and Rural Communities (NERC) Act 2006 (Ref 5);
- 2) The Conservation of Habitats and Species Regulations 2017 (the 'Habitats Regulations') (Ref 6);
- 3) Wildlife and Countryside Act 1981 (Ref 7); and
- 4) The Hedgerows Regulations (Ref 8).

Natural Environment and Rural Communities Act 2006

2.1.2 Section 40 of the NERC Act 2006 (Ref 5) requires public authorities, including local authorities, to consider what action they can take to further the conservation and enhancement of biodiversity in England through the exercise of their functions. The local planning authority, therefore, must consider the impact on biodiversity of the Scheme. The NERC Act 2006 identifies habitats and species of 'principal importance for the conservation of biodiversity in England' (Habitats of Principle Importance (HPI) and Species of Principle Importance (SPI) respectively) to guide public bodies in implementing their duty. This priority list includes a range of habitat types encountered throughout lowland England.

The Habitats Regulations

2.1.3 Annex I of the Habitats Directive (Ref 9) (whose protections have been retained in domestic law as at 31 December 2020 through the Conservation of Habitats and Species (Amendment) (EU Exit) Regulations 2019) comprises a list of 189 habitat types for which Member States must consider designation of Special Areas of Conservation (SAC) for each of the features which occurs in their European territory. This includes the designation of extensive or exceptional areas of Annex I habitats as SAC.

2.1.4 In the context of the UK, 78 Annex I habitat types are believed to occur (Ref 9). A sub-set of the Annex I habitat types are defined as being 'priority' because they are considered to be particularly vulnerable and are mainly, or exclusively, found within the European Union (Article 1d).

Wildlife and Countryside Act 1981

- 2.1.5 Under the Wildlife and Countryside Act (Ref 7), it is an offence to:
- a) Intentionally or recklessly pick, uproot or destroy any wild plant included on Schedule 8 of the Act; or
 - b) Be an unauthorised person intentionally or recklessly uprooting any wild plant not included in Schedule 8 of the Act.
- 2.1.6 Plants listed on Schedule 8 of the Act are those species which due to their rarity and/or conservation status receive additional protection from picking, uprooting or destruction, and a licence to sell.

The Hedgerows Regulations

- 2.1.7 The Hedgerows Regulations 1997 (Ref 8) exist to protect 'Important' hedgerows in the countryside by controlling their removal by a system of notification. An 'Important' hedge can only be removed under planning permission, or by a specific Hedgerow Removal Notice to be issued by the local authority.

2.2 Regional and Local Policy

- 2.2.1 Regional and local plans or policies relevant to this survey report are as follows:
- 1) South Holland District (Lincolnshire): South East Lincolnshire Local Plan 2011-2036 (Ref 10):
 - a) Policy 28 The Natural Environment: supports protecting, managing and enhancing a high quality, comprehensive ecological network of interconnected designated sites, sites of nature conservation importance and wildlife-friendly greenspace; and
 - b) Policy 31 Climate Change and Renewable and Low Carbon Energy: notes that all development proposals will be required to demonstrate that the consequences of current climate change have been addressed, minimised and mitigated by (amongst other measures) incorporating measures which promote and enhance green infrastructure and provide an overall net gain in biodiversity. This policy also stipulates that the development of renewable energy facilities and associated infrastructure will be permitted provided that individually or cumulatively, there would be no significant harm to the natural environment.
 - 2) Lincolnshire Biodiversity Action Plan (BAP) 2011-2020 (3rd edition) (Ref 11) lists the following action plans, which are considered relevant:
 - a) Saltmarsh;
 - b) Arable field margins;
 - c) Grazing marsh;
 - d) Hedgerows and hedgerow trees;
 - e) Lowland meadows;

- f) Fens;
 - g) Ponds, lakes and reservoirs;
 - h) Reedbeds and bittern;
 - i) Rivers, canals and drains;
 - j) Lowland mixed deciduous woodland;
 - k) Traditional orchards;
 - l) Wet woodland;
 - m) Wood-pasture and parkland;
 - n) Brownfield;
 - o) Churchyards and cemeteries;
 - p) Gardens and allotments; and
 - q) Parks and open spaces.
- 3) The Greater Lincolnshire Nature Recovery Strategy (Ref 12) identifies local people's priorities and potential opportunities for recovering and improving biodiversity. This strategy includes 58 priorities and 184 actions across the following themes:
- a) Woodland and Trees;
 - b) Grassland and Heathland;
 - c) Freshwater Wetlands;
 - d) Coastal and Estuarine;
 - e) Rivers and Streams;
 - f) Lowland Fen and Raised Bog;
 - g) Farmland;
 - h) Nature in Built Environments; and
 - i) Landscape Scale and Ecological Networks.

3. Methodology

3.1 Desk Study

- 3.1.1 A desk study was completed as part of the Ecological Appraisal (Ref 13) and has been reviewed to inform this report.
- 3.1.2 A detailed desk study exercise was undertaken on the Scheme Site Boundary, in order to determine the presence of HPI, ancient woodlands and ancient and veteran trees within the Scheme Site Boundary. The following sources of data were utilised:
- 1) Multi-Agency Geographic Information for the Countryside (MAGIC) (Ref 14);
 - 2) Ancient Woodland - Revised (England) - Completed Counties (Ref 15);
 - 3) Priority River Habitat Map (Ref 16);
 - 4) Woodland Trust Ancient Tree Inventory (Ref 17); and
 - 5) Arboricultural Impact Assessment [document number GWNC-WSP-SS50-XXXXXX-RPT-ES-000005].
- 3.1.3 As part of the desk study, Greater Lincolnshire Nature Partnership (GLNP) were contacted in February 2026 to obtain desk study data within 2 km of the Scheme Site Boundary. For the purposes of this report, GLNP data was used to identify ancient and veteran trees, protected and/or notable flora and fungi, as well as to review non-statutory designated sites where the designating features potentially relate to habitat classification. GLNP have completed a review of ancient woodland mapping for the county, accounting for smaller blocks than previous publicly available datasets showed. This data is present within the Ancient Woodland - Revised (England) - Completed Counties dataset and was reviewed as part of this desk study.

3.2 Survey Approach and Strategy

- 3.2.1 The Survey Area was defined as the Scheme Site Boundary plus a 50 m buffer, where access allowed. All areas were surveyed as described below within section 3.3. Where access was not granted, UK Habitat Classification (UKHab) (version 2.0) (Ref 19) was derived from aerial imagery. The only exception to this approach was for the hedgerow survey where only hedgerows within the Substation Works Site Boundary were surveyed.
- 3.2.2 Further surveys of hedgerows within the wider S37 4ZM Works Site Boundary, S37 2WS Works Site Boundary and the Exempt Overhead Line Works Site Boundary will be undertaken where required in 2026. However, it is noted that permanent loss of existing hedgerows as a result of these overhead line works is not anticipated and therefore they have not been surveyed at the time of writing this report.

3.3 Field Surveys

- 3.3.1 The field surveys were conducted at various dates between May 2024 and September 2025, within the optimal period for botanical identification (Ref 18).

3.3.2 Each survey was completed by survey teams consisting of two ecologists, with the lead ecologists being experienced in all the botanical species identification techniques required for habitat classification. Handheld electronic devices were utilised to capture geospatial data for individual habitat parcels accurately in the field.

Habitat Classification

3.3.3 Habitats were classified using the UKHab, which is listed in good practice guidance by the Chartered Institute of Ecology and Environmental Management (CIEEM) (Ref 20), provides a comprehensive approach to classification of terrestrial, coastal and freshwater habitats. Habitat definitions are given in the UKHab (version 2.0), and provide the basis for habitat types within the Statutory Biodiversity Metric (Ref 21) used for Biodiversity Net Gain (BNG).

3.3.4 The UKHab classification is based on a hierarchical system suitable for use in terrestrial, freshwater and coastal areas of the UK. The system comprises a principal hierarchy (the primary habitats); which include ecosystems, broad habitats, HPI and Annex 1 habitats, as well as non-hierarchical secondary codes (Ref 22). The habitat divisions at each level of the hierarchy are provided in **Table 3.1** below.

Table 3.1 UK habitat classification hierarchy division - adapted from Butcher, B (et al.)

Level 1	Level 2	Level 3	Level 4	Level 5
Major ecosystem, covering terrestrial, freshwater and coastal ecosystems	Nine ecosystem types, based upon major habitat types within the EUNIS classification	20 broad habitat types, corresponding with UK Biodiversity Action Plan Broad Habitats and closely to EUNIS	80 habitats, including 47 UK Biodiversity Action Plan Habitats, and further splits of level 3 habitats	104 habitats, including 69 Habitats Directive Annex 1 habitats and further splits of Level 4 habitats

3.3.5 Habitats were recorded to at least Level 4 of the hierarchy (except for modified grassland – Level 3), with further recording to level 5 if appropriate.

3.3.6 Non-hierarchical secondary codes are also used in addition to the primary codes to provide further contextual information relating to habitat mosaics and complexes within mapped primary habitats.

3.3.7 Additional relevant information outside of the UKHab classification or too small to be mapped as a defined habitat parcel, including identification of field signs of protected and/or notable species, has been recorded as target notes. These are included within the relevant species report where relevant.

Botanical recording

3.3.8 As part of the UKHab survey, surveyors recorded key botanical species present within habitats, particularly any species indicative of the named habitat type, as well as their relative abundance and structural composition. Any protected and/or notable plant species were also recorded and mapped separately to broader habitats.

- 3.3.9 The Vascular Plant Red List for England (Ref 23) was used to determine which species identified during field surveys were of particular conservation concern at a national level (England). Vascular plant species identified were also checked against Species of Principal Importance (SPI) lists and Schedule 8 of the Wildlife and Countryside Act 1981 (Ref 7).

Condition scoring

- 3.3.10 Condition is a measure of the current status and functionality of a defined area of habitat, resulting from environmental and anthropogenic factors, such as management, and is not a reflection of the intrinsic biodiversity value of the habitat. Condition scoring of habitats for BNG was undertaken concurrently with UKHab classification for the majority of the site, using the standardised condition scoring criteria (Ref 20) that accompany the Statutory Biodiversity Metric. The condition scoring information relevant to BNG is detailed within the **BNG Report** (document number GWNC-ARU-SS50-XXXXXX-RPT-ES-000015).
- 3.3.11 Condition scoring of watercourses is considerably more complex and requires specialist surveys. The results of this survey type are provided as an Appendix in the BNG Report.

Recording of trees

- 3.3.12 Individual trees were mapped within the Scheme Site Boundary where these are not an intrinsic component of a wider habitat type. Individual trees were mapped with details recorded on species, position in a rural or urban environment, as well as broad size & condition (criteria required for the Statutory Biodiversity Metric). Where the trees are intrinsic to the classification of the wider habitat type, such as woodland, they are not mapped or recorded individually.
- 3.3.13 Additionally, as irreplaceable habitat features, ancient and veteran trees frequently form an important element of the biodiversity value of lowland Britain. Where trees displaying features associated with veteran specimens were identified, either as individual features or within broader habitats such as woodlands or treelines, these trees were mapped as potential veterans. Features used to identify these trees broadly aligned with those from the Recognition of Ancient, Veteran & Notable Trees (RAVEN) methodology (Ref 25).
- 3.3.14 Any trees identified as potential native black poplar *Populus nigra* subsp. *Betulifolia* were recorded. Full details of the assessment in relation to ancient, veteran and notable trees are provided within the **Arboricultural Impact Assessment**.
- 3.3.15 Whilst the focus of this exercise was to map trees which may constitute irreplaceable habitat, it also aimed to broadly capture any further trees of considerable biodiversity value through their age or decay features. These trees could then be prioritised for avoidance throughout the design development process.

Hedgerow Surveys

- 3.3.16 An assessment of hedgerows impacted within the Substation Works Site Boundary was undertaken to determine if they are deemed "Important" under The Hedgerows Regulations 1997 (Ref 8). An 'Important' hedgerow can only be removed under planning permission, or by a specific Hedgerow Removal Notice to be issued by the local planning authority. Hedgerows are considered 'Important' in accordance with

The Hedgerow Regulations 1997 (Ref 8), which provides wildlife and landscape criteria. Hedgerows can also qualify as 'Important' through meeting criteria in the 'Archaeology and history' section of Part II of Schedule 1 of the Hedgerow Regulations, however this is not assessed within this report; these are assessed within the **Historic Environment Desk-based Assessment** [document number GWNC-ARU-SS50-XXXXXX-RPT-ES-000017].

- 3.3.17 For the purposes of this report and in accordance with the Hedgerow Survey Handbook (Ref 26), a hedgerow has been defined as "any boundary line of trees or shrubs over 20 m long and less than 5 m wide at the base, provided that at one time the trees or shrubs were more or less continuous". To qualify as 'Important' under the Hedgerows Regulations 1997, a hedgerow must be at least 30 years old and meet at least one of the three wildlife and landscape criteria, as detailed within the Methodology section of this report.
- 3.3.18 The entire length of the hedgerow was surveyed, to ensure its full structure was documented for assessing its importance. The survey included recording information on the botanical composition of the hedgerows and their associated habitat features, in accordance with the criteria described below.
- 3.3.19 To qualify as 'Important' a hedgerow must be over 30 years old and satisfy at least one of the following criteria (numbering as listed in Schedule 1, Part II of the Hedgerow Regulations):
- 6) The hedgerow contains a species listed in the Wildlife and Countryside Act 1981 (Ref 7), either in Part I of Schedule 1 (birds protected by special penalties), or Schedule 5 (other animals) or Schedule 8 (plants). In addition, any species listed in British Red Data Books qualify;
 - 7) The 30 m length of hedgerow includes, on average¹, one of the following:
 - a) at least seven 'woody²' species;
 - b) at least six 'woody' species and has at least three associated features; or
 - c) at least six 'woody' species including a black poplar, large-leaved lime *Tilia platyphyllos*, small-leaved lime *Tilia cordata* or wild service tree *Sorbus torminalis*;
 - 8) The hedgerow runs alongside a bridleway, footpath, road used as a public path or as a byway open to all traffic, and includes at least four 'woody' species, on average, in a 30 m length, and has at least two associated features. The following are considered as associated features:
 - a) a bank or wall supporting the hedgerow along at least half of its length;
 - b) less than 10% gaps within the hedgerow;
 - c) on average, at least one tree per 50 m of hedgerow;
 - d) at least three species from a list of 57 herbaceous 'woodland' plant species are noted as being present;

¹ The 'average' is calculated by averaging the number of woody species across 30m sections within the whole length of hedgerow.

² 'Woody' species are certain native trees and shrubs that are listed on Schedule 2 of the Hedgerows Regulations 1997.

- e) a ditch along at least a half of the length of the hedge;
 - f) a number of connections with other hedgerows, ponds or woodland; and
 - g) a parallel hedge within 15 m of the hedgerow.
- 3.3.20 Where hedgerows are under 30 years old, they are classified as unimportant regardless of other qualifying criteria.
- 3.3.21 It should be noted that ‘Important’ hedgerows are distinct from ‘species rich hedgerows’, which in themselves are afforded no legal protection, and are defined within the Hedgerow Survey Handbook (Ref 26) as:

“hedgerows where the structural species making up the 30m section of hedgerow include at least five (or at least four in northern and eastern England, upland Wales and Scotland) woody species that are either native somewhere in the UK, or which are archaeophytes”.

3.4 Assumptions and limitations

- 3.4.1 The aim of the desk study was to help characterise the baseline context of the Scheme and provide valuable background information that would not be captured by site surveys alone. Information obtained during the desk study was dependent upon people and organisations having made and submitted records for the area of interest. As such, lack of records for a particular species does not necessarily mean that species does not occur in the Survey Area. Likewise, the presence of records of species does not automatically mean that these will still occur within the area of interest or are relevant in the context of the Scheme.
- 3.4.2 The majority of the Scheme Site Boundary has been surveyed with the exception of the area to the east of Lords Drain, where access was not available. In addition, access was constrained within the floodplain to the north of the River Welland. Areas which could not be accessed are shown in **Figure 2** and were appraised using aerial photography.
- 3.4.3 Not all individual trees have been surveyed, especially along the access routes within the Substation Works Site Boundary.
- 3.4.4 The Hedgerow survey only considered the wildlife and landscape criteria (criteria 6, 7 and 8), in order to define a hedgerow as ‘Important’ or ‘Not Important’.

4. Baseline and Evaluation

4.1 Desk Study

4.1.1 Habitats of Principal Importance identified within the Scheme Site Boundary are summarised in **Table 4.1**.

Table 4.1 Habitats of Principal Importance associated with the Scheme Site Boundary.

HPI type	Broad distribution within and adjacent to the Scheme Site Boundary	Relevant Component of the Scheme
Coastal saltmarsh	Present on both banks of the River Welland.	Within the Exempt Overhead Line Works Site Boundary only.
Mudflats	Present on both banks of the River Welland.	Within the Exempt Overhead Line Works Site Boundary only.
Coastal and floodplain grazing marsh (CFGM)	Present on northern floodplain of the River Welland.	Within the Exempt Overhead Line Works Site Boundary only.
Rivers	The River Welland.	Within the Exempt Overhead Line Works Site Boundary only.

4.1.2 No notable or protected plant species were present within the Scheme Site Boundary.

4.2 Field Surveys

Ancient, veteran and notable trees

4.2.1 No ancient, veteran or notable trees were noted within the Scheme Site Boundary.

Notable plants

4.2.2 No notable plants were recorded as part of the UKHab surveys within the Scheme Site Boundary.

UK Habitat classification

4.2.3 A summary table for each habitat type identified within the Scheme Site Boundary is provided in **Table 4.2**. This includes confirmation of whether each habitat type is present within the Substation Works Site Boundary subject to consent under the TCPA.

Table 4.2 Summary table of habitats identified within the Scheme Site Boundary

UKHab code (lowest level of UKHab recorded)	Habitat type (lowest level of UKHab recorded)	Recorded within the Scheme Site Boundary	Recorded within the Substation Works Site Boundary ⁺
c1c	Cereal crops	Yes	Yes
c1c7	Other cereal crops	Yes	Yes
c1d	Non-cereal crops	Yes	Yes
c1d8	Other non-cereal crops	Yes	Yes
f2e	Reedbeds	Yes	No
g3c	Other neutral grassland	Yes	No
g3c6	<i>Lolium-Cynosurus</i> neutral grassland	Yes	Yes
g4	Modified grassland	Yes	No
h2a6	Hedgerow (priority habitat)	Yes	Yes
h3h	Mixed scrub	Yes	No
r1g	Other standing water	Yes	Yes
r2a	Rivers (priority habitat)	Yes	No
r2b	Other rivers and streams	Yes	Yes
t2a	Coastal saltmarsh	Yes	No
u1b	Developed land; sealed surface	Yes	Yes
u1b5	Buildings	Yes	Yes
u1b6	Other developed land	Yes	Yes
u1e	Built linear feature	Yes	Yes
w1f*	Lowland mixed deciduous woodland	Yes	No
w1gg (33)	Line of trees	Yes	Yes

*Precautionary assumption made based on aerial photography.

+A more detailed breakdown for within each boundary for the Scheme is provided in **Appendix A**.

c1c – Cereal crop, c1c7 - Other cereal crops, c1d – Non-cereal crops and other non-cereal crops

4.2.4 Cereal crops and non-cereal crops cover the majority of land within the Scheme Site Boundary. Crops recorded include wheat *Triticum aestivum* and other cereal crops,

while non-cereal crops seemed to be mainly brassicas. Many of these arable fields are bordered by shallow ditches which were observed to likely be dry for the majority of the year.

- 4.2.5 Given the intensively managed nature of many of these arable fields, the associated species were common arable weeds, with no notable species recorded within the Scheme Site Boundary.

f2e – Reedbeds

- 4.2.6 Wetlands meeting the criteria for reedbed priority habitat (Ref 27) was identified in only a single location within the Scheme Site Boundary to the north west of the School House. This small area of homogenous common reed *Phragmites australis* is located within a depression at the edge of an arable field. This area does not appear to be actively managed.

g3c – Other neutral grassland

- 4.2.7 Other neutral grasslands of moderate diversity, neither meeting lowland meadow priority habitat criteria, nor being highly modified in nature, were patchily distributed throughout the Scheme Site Boundary. One significant area of this grassland type was identified within the Scheme Site Boundary located to the north of the River Welland forming part of the CFGM within the floodplain of the River Welland. This area also contains part of the Surfleet Bank County Wildlife Site (CWS) (a former disused railway). The majority of the grassland is grazed by cattle.
- 4.2.8 Species present include sweet vernal grass *Anthoxanthum odoratum*, red fescue *Festuca rubra* agg., cock's-foot *Dactylis glomerata*, perennial rye-grass *Lolium perenne*, meadow fescue *Schedonorus pratensis*, Yorkshire-fog *Holcus lanatus* soft brome *Bromus hordeaceus*, common couch *Elymus repens*, rough meadow-grass *Poa trivialis*, musk thistle *Carduus nutans*, common vetch *Vicia angustifolia*, yarrow *Achillea millefolium*, dandelion *Taraxacum officinale* agg, wild mignonette *Reseda lutea*, white campion *Silene latifolia*, creeping thistle *Cirsium arvense*, common nettle *Urtica dioica*, common hogweed *Heracleum sphondylium*, meadow buttercup *Ranunculus acris*, ribwort plantain *Plantago lanceolata*, broad-leaved dock *Rumex obtusifolius*, red clover *Trifolium arvense*, field bindweed *Convolvulus arvensis*, field horsetail *Equisetum arvense*, common mouse-ear *Cerastium fontanum*, hoary cress *Lepidium draba* and Soft brome *Bromus hordeaceus*.
- 4.2.9 There is a smaller strip of other neutral grassland to the north west of Shepherds Farm, it is presumed that the grassland is subject to an annual or bi-annual cut. Species present within the grassland include cock's-foot, perennial rye-grass, red fescue, soft brome, Yorkshire-fog, false oat grass *Arrhenatherum elatius*, rough meadow-grass *Poa trivialis*, creeping thistle, common bird's-foot-trefoil *Lotus corniculatus*, common knapweed *Centaurea nigra*, broadleaved dock, ribwort plantain, musk mallow *Malva moschata*, yarrow and oxeye daisy *Leucanthemum vulgare*.

g3c6 *Lolium-Cynosurus* neutral grassland

- 4.2.10 A small paddock grazed by cattle adjacent to the west of Crowtree farm. Species present within the grassland include perennial rye-grass, crested dog's-tail *Cynosurus cristatus*, cock's-foot, red fescue, Yorkshire-fog, creeping thistle, broadleaved dock, ribwort plantain and yarrow.

g4 – Modified grassland

- 4.2.11 A small strip of modified grassland is located adjacent to a large arable field within the Scheme Site Boundary to the west of Top Yard.
- 4.2.12 Species present within the modified grassland include barren brome *Bromus sterilis*, cock's-foot, perennial rye-grass, creeping thistle, dandelion, common hogweed, cleavers *Galium aparine*, false oat grass, common nettle and common knapweed.

h2a – Hedgerow (priority habitat)

- 4.2.13 Hedgerows constitute one of the primary biodiversity features within the Scheme Site Boundary. These hedgerows meet the criteria for priority habitat; comprising over 80% of native woody species (Ref 8)
- 4.2.14 The hedgerow to the north of the River Welland comprises mainly of common hawthorn *Crataegus monogyna*, with occasional wild privet *Ligustrum vulgare* and elder *Sambucus nigra*. Ground flora species include cock's-foot, false oat grass, common nettle, creeping thistle, common ragwort *Senecio jacobaea* and comfrey *Symphytum officinale*.
- 4.2.15 A hedgerow is present within fields to the west of a track between Top Yard and Bottom Yard. This hedgerow comprises of wild privet *Ligustrum vulgare*, hawthorn, blackthorn *Prunus spinosa* and elder. Ground flora species include common nettle, common orache *Atriplex patula*, common mayweed *Anthemis cotula* and false oat-grass.
- 4.2.16 A small section of hedgerow is present to the north of Top Yard, this mainly comprises blackthorn with ash *Fraxinus excelsior* trees present along the length.

h3h – Mixed scrub

- 4.2.17 A small patch of mixed scrub is present underneath a pylon to the north of the River Welland. Species encountered include bramble *Rubus fruticosus* L. agg, dogwood, elder, hawthorn, hairy willowherb *Epilobium hirsutum*, common hogweed, creeping thistle, cock's-foot, common ragwort, hedge bindweed *Calystegia sepium* and false oat grass.

r1g – Other standing water

- 4.2.18 An agricultural drainage ditch runs north to south through the Scheme Site Boundary, the steep banks on either side are regularly cut and the ditch seems to maintain a small amount of water throughout the majority of the year. Emergent species are scattered along the ditch and include water forget me not *Myosotis scorpioides* and common reed. Algae is present throughout the ditch. The vegetation on the ditch bank comprises Yorkshire fog, dead nettle, common nettle and hogweed.

r2a – Rivers (priority habitat)

- 4.2.19 The River Welland runs through the Scheme Site Boundary. This section of River Welland has been historically channelised so that it is navigable. To either side of the River Welland is a thin strip of salt marsh, as described below. Mudflats are also associated with this habitat type however have not been mapped separately due to their small extent and overlap with the extent of the River Welland. This habitat was not surveyed as part of the UKHab survey and therefore does not appear on the various figures within this report. It was however surveyed as part of the River

Condition Assessment surveys and a more detailed description of this watercourse can be found within the **Biodiversity Net Gain (BNG) Report**.

r2b – Other rivers and streams

- 4.2.20 Lord's Drain runs through the Scheme Site Boundary, this is a heavily channelised and modified water course, with the vegetation on the banks regularly managed.
- 4.2.21 Other smaller watercourses run through the Scheme Site Boundary, these are generally heavily modified and straightened, with the embankments regularly cut.
- 4.2.22 These habitats were not surveyed as part of the UKHab survey and therefore does not appear on the various figures within this report. It was however surveyed as part of the River Condition Assessment surveys and a more detailed description of this watercourse can be found within the **Biodiversity Net Gain (BNG) Report**.

t2a – Coastal saltmarsh

- 4.2.23 A thin strip of coastal saltmarsh priority habitat (Ref 29) was identified on the south bank of the River Welland, between the watercourse and the embankment, this area is subject to periodic submergence by brackish water. The habitat is dominated by sea couch *Elymus athericus*, with occasional common reed.

u1b – Developed land; sealed surface, u1b5 – Buildings, u1b6 – Other developed land, u1e – Built linear feature

- 4.2.24 Various urban habitats are present throughout the Scheme Site Boundary, in the form of highways, buildings, areas of hardstanding and farm tracks.

w1f – Lowland mixed deciduous woodland (from aerial imagery)

- 4.2.25 Lowland mixed deciduous woodland, corresponding to the woodland priority habitat type found most commonly in lowland England (Ref 30), occurs within one location within the Scheme Site Boundary.
- 4.2.26 The woodland to the east of Lords Drain has been classified as Lowland mixed deciduous woodland on a precautionary basis as this area has not been surveyed.

w1g (33) – Line of trees

- 4.2.27 A line of trees is present along the track between Top Yard and Bottom Yard, directly south of Bottom Yard. Species encountered include Sycamore *Acer pseudoplatanus*, alder *Alnus glutinosa*, ash, wild cherry *Prunus avium* and rowan *Sorbus aucuparia*.
- 4.2.28 A line of generally young ash and horse chestnut *Aesculus hippocastanum* trees is present to the north of Top Yard.
- 4.2.29 A line of mature ash trees is located along Marsh Road, to the north of Crowtree Farm.
- 4.2.30 A line of ash and common hawthorn trees is present along Stone Gate Road.

Hedgerow Survey

- 4.2.31 The hedgerow present within fields to the west of a track between Top Yard and Bottom Yard (shown on **Figure 2A**), was not assessed as 'Important' under the

Hedgerow Regulations as it did not comprise the relevant number of woody species required. This hedgerow averaged only 3 woody species per 30 m section with only the only associated hedgerow feature being less than 10% gaps within the hedgerow.

- 4.2.32 This hedgerow is still classified as an HPI, even though it was not assessed as 'Important' under the Hedgerow Regulations.
- 4.2.33 Only hedgerows within the Substation Works Site Boundary were assessed as described in **Paragraph 3.3.16**, given permanent habitat loss is predominantly associated with the Substation Works component of the Scheme. Therefore, no other hedgerows are discussed within this section.

5. Summary

5.1.1 The following habitat types were identified within the Scheme Site Boundary:

- 1) Cereal crops;
- 2) Other cereal crops;
- 3) Non-cereal crops;
- 4) Other non-cereal crops;
- 5) Reedbeds;
- 6) Other neutral grassland;
- 7) *Lolium-Cynosurus* neutral grassland;
- 8) Modified grassland;
- 9) Hedgerow;
- 10) Mixed scrub;
- 11) Other standing water;
- 12) Rivers (The River Welland);
- 13) Other rivers and streams;
- 14) Coastal saltmarsh;
- 15) Developed land; sealed surface;
- 16) Buildings;
- 17) Other developed land;
- 18) Built linear feature;
- 19) Lowland mixed deciduous woodland; and
- 20) Line of trees.

5.1.2 This included the following priority habitat types:

- 1) Hedgerow;
- 2) Lowland mixed deciduous woodland;
- 3) Rivers (The River Welland);
- 4) Reedbed;
- 5) Saltmarsh; and
- 6) CFGM.

5.1.3 In general, the landscape within the Scheme Site Boundary was dominated by agricultural land, with the majority of notable habitats generally being associated with the floodplain of the River Welland. The River Welland, saltmarsh and CFGM are all

outside the Substation Works Site Boundary. A full breakdown of the habitat types found within each boundary for the Scheme are shown within **Figures 2A-2D** and in **Appendix A**.

- 5.1.4 Hedgerows and the small area of Reedbed (both priority habitat types) are located within the Substation Works Site Boundary.
- 5.1.5 Within the wider extent of agricultural land, habitats of higher biodiversity value habitats are generally scattered and comprise other woodland (lines of trees), other neutral grassland and ditches.

References

- Ref 1 Town and Country Planning Act 1990. Available online: https://www.legislation.gov.uk/ukpga/1990/8/pdfs/ukpga_19900008_en.pdf [Accessed 30 April 2026]
- Ref 2 Electricity Act 1989. Available online: <https://www.legislation.gov.uk/ukpga/1989/29/contents> [Accessed 30 April 2026]
- Ref 3 The Town and Country Planning (General Permitted Development) (England) Order 2015. Available online: <https://www.legislation.gov.uk/uksi/2015/596/contents> [Accessed 30 April 2026]
- Ref 4 The Overhead Lines (Exemption) (England and Wales) Regulations 2009. Available online: <https://www.legislation.gov.uk/uksi/2009/640/contents/made> [Accessed 30 April 2026]
- Ref 5 UK Government, (2006). Natural Environment and Rural Communities Act 2006 Chapter 16," Natural England and the Commission for Rural Communities, 2006. Available online: <https://www.legislation.gov.uk/ukpga/2006/16/contents> [Accessed 9 March 2026].
- Ref 6 UK Government, (2017). The Conservation of Habitats and Species Regulations," 2017. Available online: <https://www.legislation.gov.uk/uksi/2017/1012/contents> [Accessed 9 March 2026].
- Ref 7 UK Government, (1981). Wildlife and Countryside Act," 1981 [online]. Available online: <https://www.legislation.gov.uk/ukpga/1981/69> [Accessed 9 March 2026].
- Ref 8 The Hedgerows Regulations 1997. Available online: <https://www.legislation.gov.uk/uksi/1997/1160/schedule/1> [Accessed 9 March 2026].
- Ref 9 Joint Nature Conservation Committee (2009) The Habitats Directive: selection of Special Areas of Conservation in the UK - Part 1: Background to site selection. Available online: <https://data.jncc.gov.uk/data/5d20b480-9cc1-490f-9599-da6003928434/sac-selection-background-t37-v4.pdf> [Accessed 9 March 2026].
- Ref 10 South East Lincolnshire District Council, (2019). South East Lincolnshire Local Plan 2011-2036 [online]. Available online: <https://southeastlincslocalplan.org/media/21941/South-East-Lincolnshire-Local-Plan-2011-2036/pdf/Local-Plan-text-March-2019.pdf?m=1720710748483> [Accessed 9 March 2026].
- Ref 11 Lincolnshire Biodiversity Partnership, (2011). Lincolnshire Biodiversity Action Plan (BAP) 2011-2020 (3rd edition). Available online: <https://www.nelincs.gov.uk/wp-content/uploads/2016/02/201110-LincolnshireBAP-3rd-edition.pdf> [Accessed 9 March 2026].
- Ref 12 Greater Lincolnshire Local Nature Recovery Strategy. Available online: <https://www.glinclns.org.uk/content/uploads/Greater%20Lincolnshire%20Nature%20Recovery%20Strategy.pdf> [Accessed 9 March 2026].

- Ref 13 National Grid, (2026). Proposed Electricity Substation Works at Weston Marsh. TCPA Ecological Impact Assessment.
- Ref 14 Defra, (2026). Multi-Agency Geographic Information for the Countryside. Available online: <https://magic.defra.gov.uk/home.htm> [Accessed 9 March 2026].
- Ref 15 Natural England, (2026). Ancient Woodland (England) [online]. Available online: <https://naturalengland-defra.opendata.arcgis.com/datasets/Defra::ancient-woodland-revised-england-completed-counties-1/about> [Accessed 9 March 2026].
- Ref 16 Natural England, (2023). Priority River Habitat – Rivers (England) [online]. Available online: <https://hub.arcgis.com/datasets/7e5dd3c72f424fd5bc6f013d18dd770c/explore?location=52.823273%2C-1.967810%2C6.31> [Accessed 9 March 2026].
- Ref 17 Woodland Trust. Ancient tree inventory [online]. Available online: <https://ati.woodlandtrust.org.uk> [Accessed 9 March 2026].
- Ref 18 Joint Nature Conservation Committee (2010) *Handbook for Phase 1 habitat survey - a technique for environmental audit*. Available online: <https://data.jncc.gov.uk/data/9578d07b-e018-4c66-9c1b-47110f14df2a/Handbook-Phase1-HabitatSurvey-Revised-2016.pdf> [Accessed 24 March 2026].
- Ref 19 UKHab Limited, (2023). UK Habitat Classification Version 2.0 [online]. Available online: <https://www.ukhab.org/> [Accessed 24 March 2026].
- Ref 20 CIEEM (2021) *Good Practice Guidance for Habitats and Species*. Available online: <https://cieem.net/wp-content/uploads/2021/05/Good-Practice-Guide-2023-edit.pdf> [Accessed 9 March 2026].
- Ref 21 Natural England, (2025). Statutory biodiversity metric tools and guide. Available online: <https://www.gov.uk/government/publications/statutory-biodiversity-metric-tools-and-guides> (Accessed 9 March 2026).
- Ref 22 Council Directive 92/43/EEC (1992) ANNEX 1: Natural habitat types of community interest whose conservation requires the designation of special areas of conservation. Available online: <https://www.legislation.gov.uk/eudr/1992/43/annex/> [Accessed 9 March 2026].
- Ref 23 Stroth, P.A. et al. (2014) A Vascular Plant Red List for England. Botanical Society of Britain and Ireland, Bristol.
- Ref 24 National Grid, (2026). Proposed Electricity Substation Works at Weston Marsh. TCPA Biodiversity Net Gain Report.
- Ref 25 Recognition of Ancient, Veteran & Notable Trees (RAVEN) [online]. Available online: <https://www.flac.uk.com/wp-content/uploads/2018/08/RAVEN.> [Accessed 9 March 2026].
- Ref 26 Defra (2007) Hedgerow Survey Handbook. A standard procedure for local surveys in the UK. Defra, London. Available online: <https://www.gov.uk/government/publications/hedgerow-survey-handbook> [Accessed 9 March 2026].
- Ref 27 Joint Nature Conservation Committee (2008) *UK Biodiversity Action Plan Priority Habitat Descriptions – Reedbeds*. Available online:

<https://data.jncc.gov.uk/data/6fe22f18-fff7-4974-b333-03b0ad819b88/UKBAP-BAPHabitats-44-Reedbeds.pdf> [Accessed 9 March 2026].

- Ref 28 Joint Nature Conservation Committee (2008) *UK Biodiversity Action Plan Priority Habitat Descriptions - Hedgerows*. Available online: <https://data.jncc.gov.uk/data/ca179c55-3e9d-4e95-abd9-4edb2347c3b6/UKBAP-BAPHabitats-17-Hedgerows.pdf> [Accessed 9 March 2026].
- Ref 29 Joint Nature Conservation Committee (2008) *UK Biodiversity Action Plan Priority Habitat Descriptions - Coastal Saltmarsh*. Available online: <https://data.jncc.gov.uk/data/6e4e3ed1-117d-423c-a57d-785c8855f28c/UKBAP-BAPHabitats-08-CoastSaltmarsh.pdf> [Accessed 9 March 2026].
- Ref 30 Joint Nature Conservation Committee (2008) *UK Biodiversity Action Plan Priority Habitat Descriptions – Lowland Mixed Deciduous Woodland*. Available online: Lowland mixed deciduous woodland (UK BAP Priority Habitat description) [Accessed 9 March 2026].

Figures

Figure 1 Scheme Site Boundary

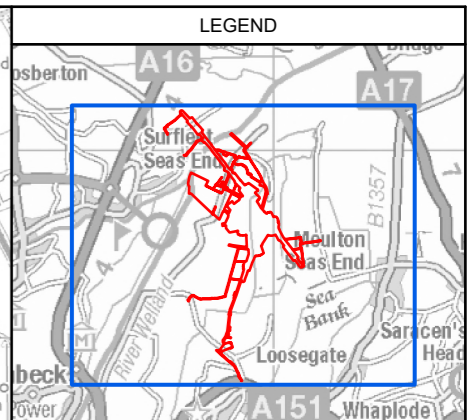
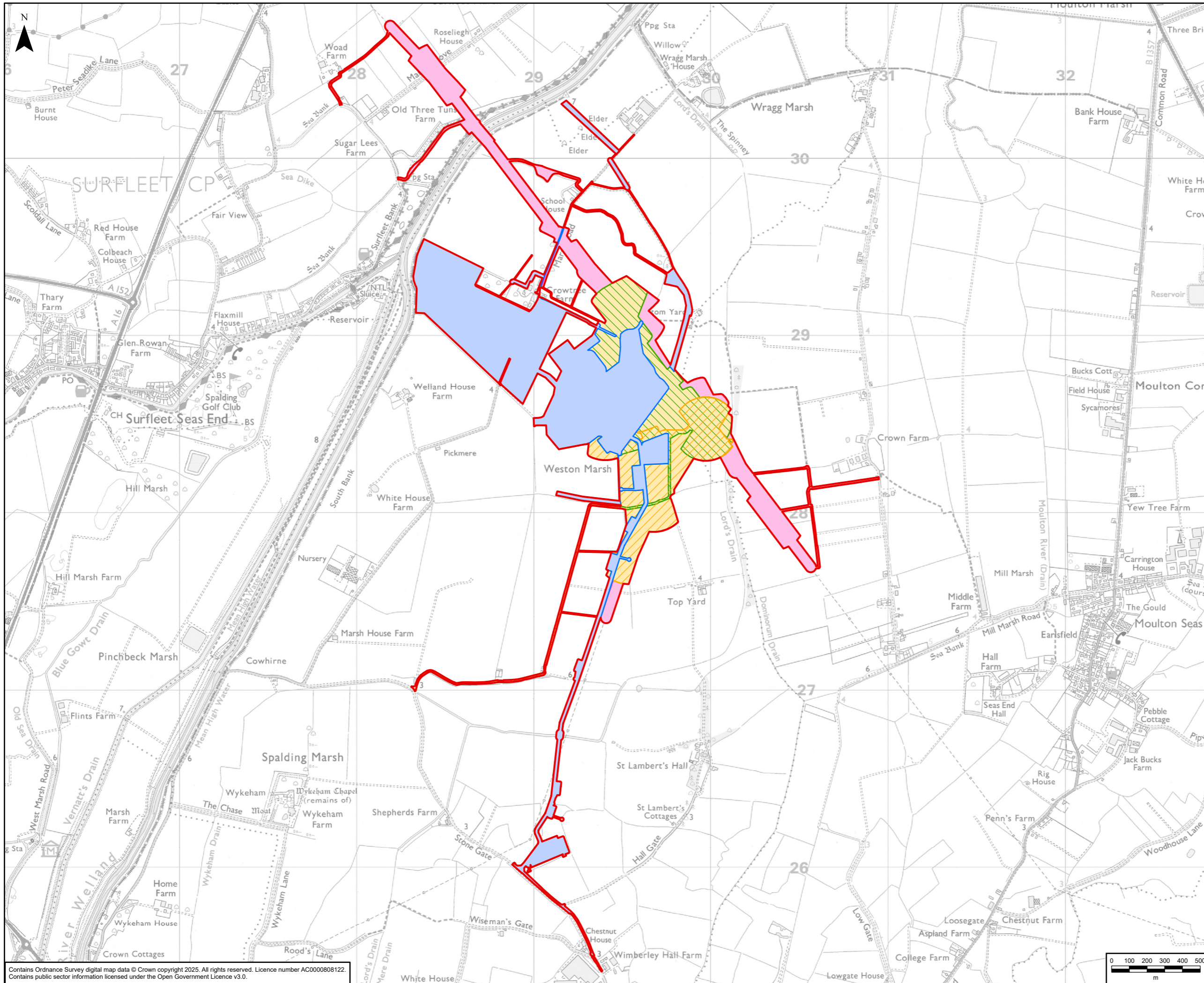

- Legend**
- Scheme Site Boundary
 - Substation Works Site Boundary
 - S37 OHL Works Site Boundary
 - Exempt Overhead Line Works Site Boundary
 - S37 - 4ZM - OHL Works Site Boundary
 - S37 - 2WS - OHL Works Site Boundary

A	05/05/2026	First Issue	ER	DF	SM
Rev	Date	Description	GIS	Chk	App

nationalgrid					
Purpose: HABITAT CLASSIFICATION REPORT					
Scheme: PROPOSED ELECTRICITY SUBSTATION AND OVERHEAD LINE WORKS AT WESTON MARSH					
Document Title: FIGURE 1 SCHEME SITE BOUNDARY					
Creator:	Date:	Checker:	Date:	Approver:	Date:
ER	05/05/2026	DF	05/05/2026	SM	05/05/2026
Document Type:	Scale:	Format:	Sheets:	Rev:	
FIGURE	1:20,000	A3	OF	A	

Contains Ordnance Survey digital map data © Crown copyright 2025. All rights reserved. Licence number AC000808122. Contains public sector information licensed under the Open Government Licence v3.0.

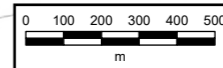
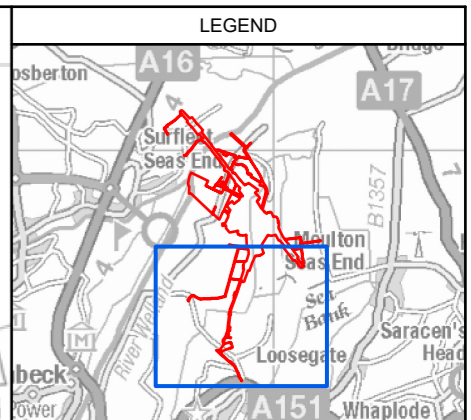
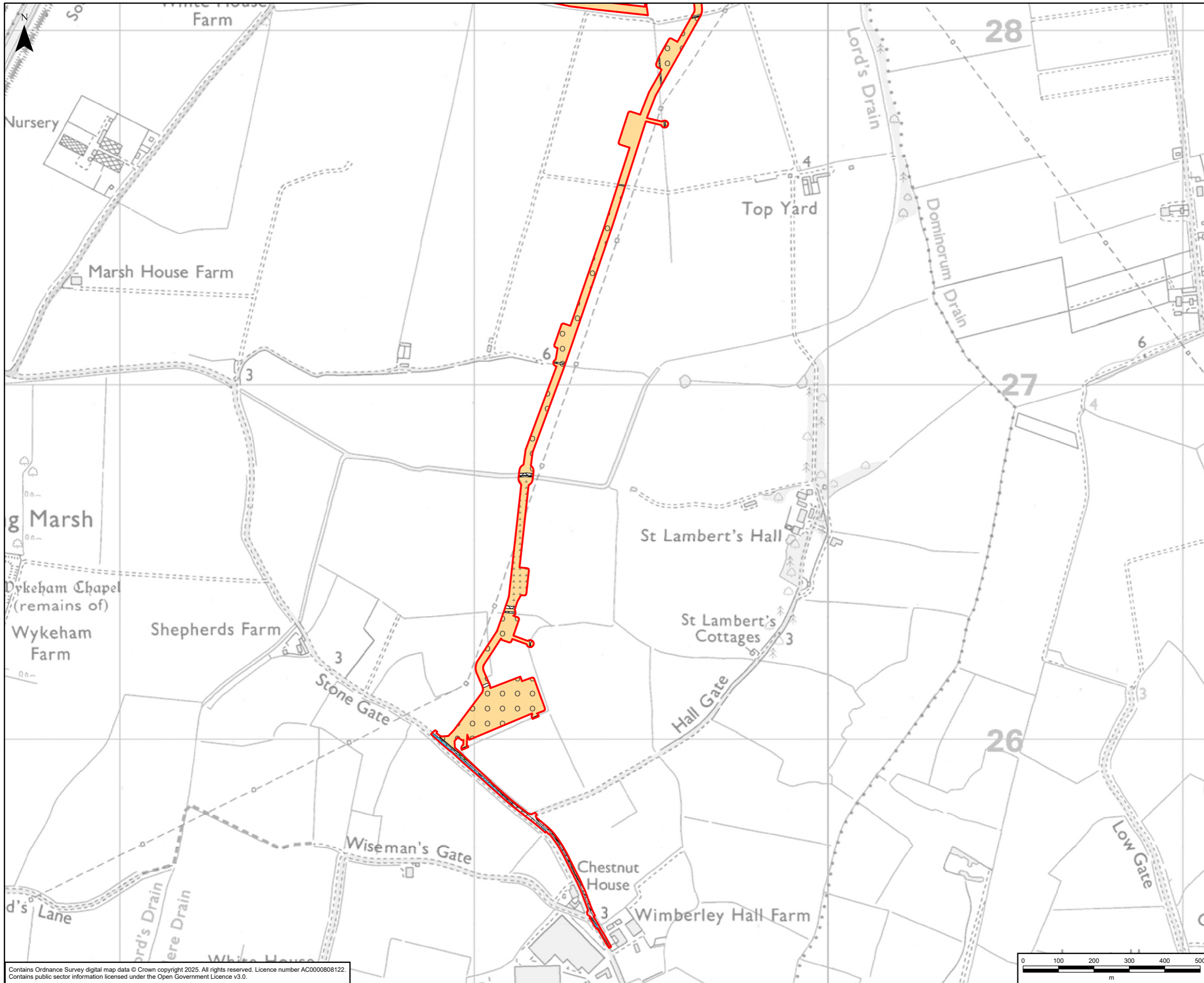

Figure 2A UK Habitat Classification Plan – Substation Works



Legend

TCPA Substation Site Boundary

UK Habitat Type

- r1g - Other standing water
- w1g (33) - Line of trees
- c1c - Cereal crops
- c1c7 - Other cereal crops
- c1d8 - Other non-cereal crops
- u1b - Developed land; sealed surface
- Not Surveyed

A	05/05/2026	First Issue	MM	DF	SM
Rev	Date	Description	GIS	Chk	App

nationalgrid

Purpose: HABITAT CLASSIFICATION REPORT

Scheme: PROPOSED ELECTRICITY SUBSTATION AND OVERHEAD LINE WORKS AT WESTON MARSH

Document Title: FIGURE 2A UK HABITAT CLASSIFICATION PLAN - TPCA

Creator:	Date:	Checker:	Date:	Approver:	Date:
MM	05/05/2026	DF	05/05/2026	SM	05/05/2026
Document Type:	Scale:	Format:	Sheets:	Rev:	
FIGURE	1:10,000	A3	2 OF 2	A	

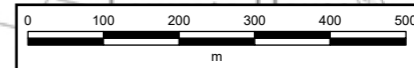

Contains Ordnance Survey digital map data © Crown copyright 2025. All rights reserved. Licence number AC000808122. Contains public sector information licensed under the Open Government Licence v3.0.

Figure 2B UK Habitat Classification Plan – S37 4ZM Overhead Line Works

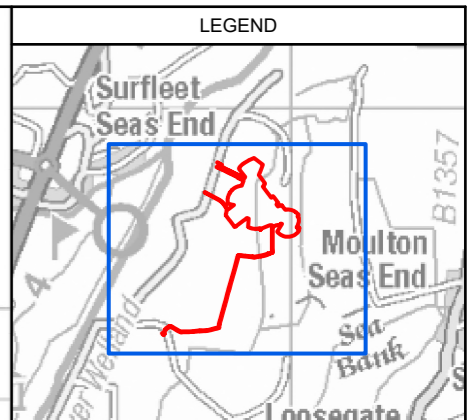
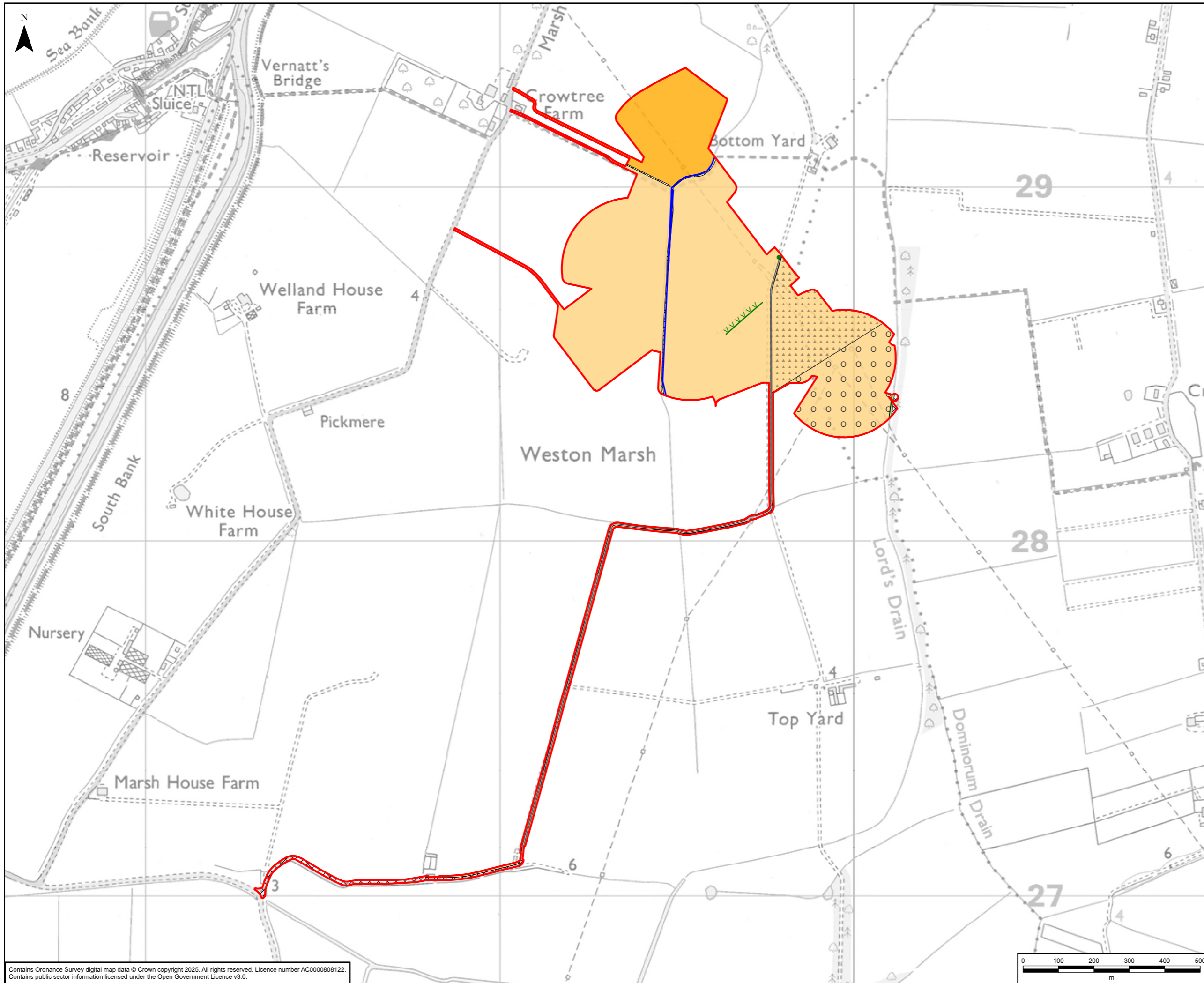

LEGEND

Legend

- S37 4ZM Site Boundary
- UK Habitat Type**
- VVV h2a6 - Other native hedgerow
- r2b - Other rivers and streams
- w1g (33) - Line of trees
- c1 - Arable and horticulture
- c1c - Cereal crops
- c1c7 - Other cereal crops
- c1d8 - Other non-cereal crops
- g4 - Modified grassland
- u1b - Developed land; sealed surface
- u1b6 - Other developed land
- Not Surveyed

A	15/06/2026	First Issue	MM	DF	SM
Rev	Date	Description	GIS	Chk	App

nationalgrid					
Purpose: HABITAT CLASSIFICATION REPORT					
Scheme: PROPOSED ELECTRICITY SUBSTATION AND OVERHEAD LINE WORKS AT WESTON MARSH					
Document Title: FIGURE 1B UK HABITAT CLASSIFICATION PLAN - S37 4ZM					
Creator:	Date:	Checker:	Date:	Approver:	Date:
MM	15/06/2026	DF	15/06/2026	SM	15/06/2026
Document Type:	Scale:	Format:	Sheets:	Rev:	
FIGURE	1:10,000	A3	OF	A	

Contains Ordnance Survey digital map data © Crown copyright 2025. All rights reserved. Licence number AC0000808122. Contains public sector information licensed under the Open Government Licence v3.0.

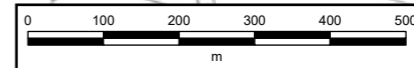

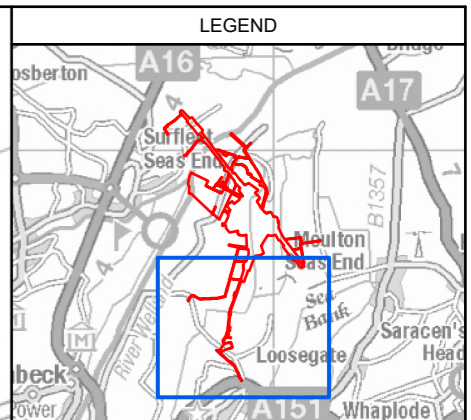
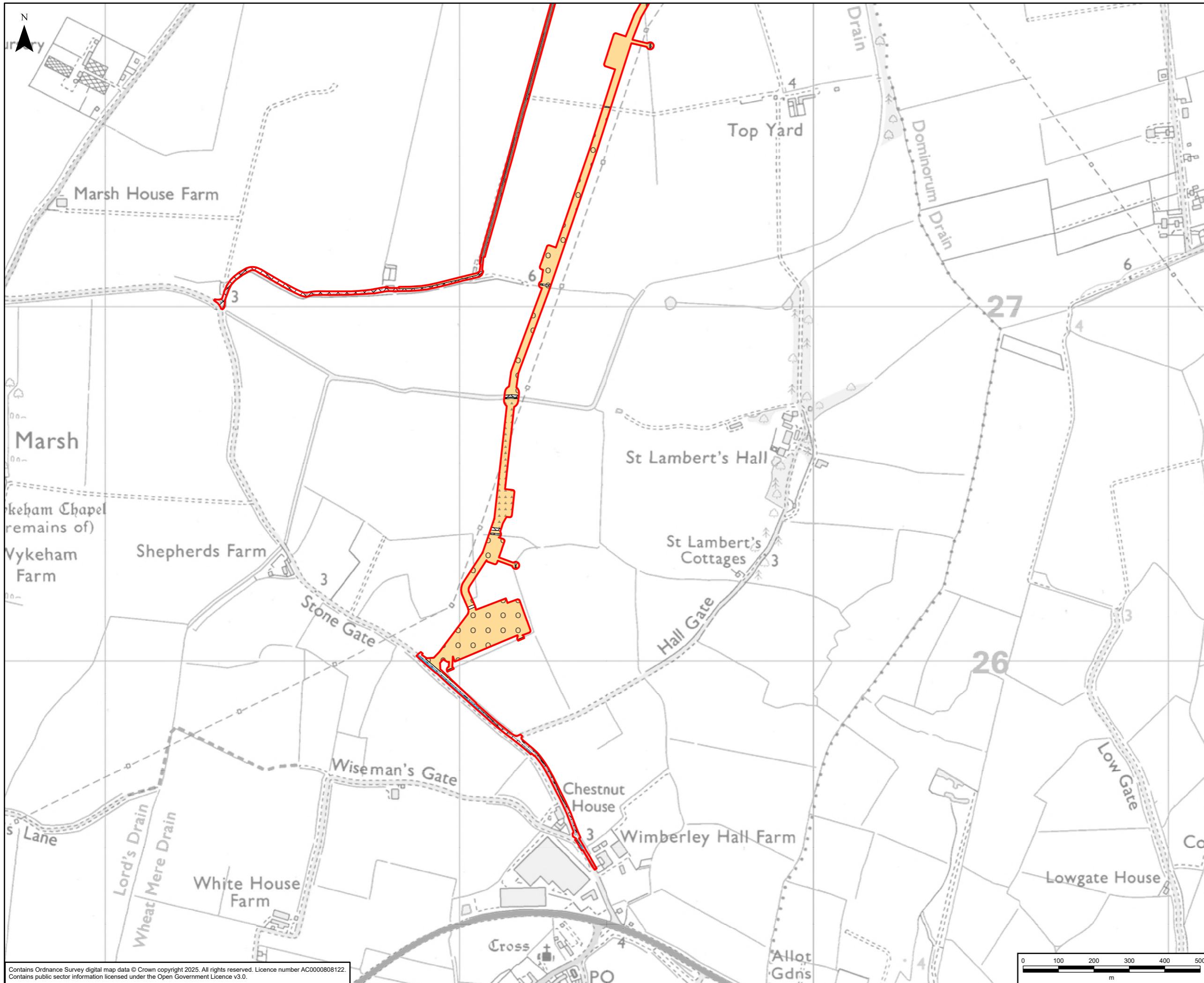

Legend

S37 4ZM Site Boundary

UK Habitat Type

- r1g - Other standing water
- w1g (33) - Line of trees
- c1c - Cereal crops
- c1c7 - Other cereal crops
- c1d8 - Other non-cereal crops
- u1b - Developed land; sealed surface
- u1b6 - Other developed land
- Not Surveyed

A	05/05/2026	First Issue	MM	DF	SM
Rev	Date	Description	GIS	Chk	App

nationalgrid

Purpose: HABITAT CLASSIFICATION REPORT

Scheme: PROPOSED ELECTRICITY SUBSTATION AND OVERHEAD LINE WORKS AT WESTON MARSH

Document Title: FIGURE 1B UK HABITAT CLASSIFICATION PLAN - S37 4ZM

Creator:	Date:	Checker:	Date:	Approver:	Date:
MM	05/05/2026	DF	05/05/2026	SM	05/05/2026
Document Type:	Scale:	Format:	Sheets:	Rev:	
FIGURE	1:10,000	A3	2 OF 2	A	

Contains Ordnance Survey digital map data © Crown copyright 2025. All rights reserved. Licence number AC0000808122. Contains public sector information licensed under the Open Government Licence v3.0.

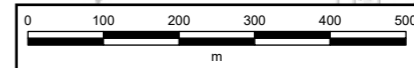
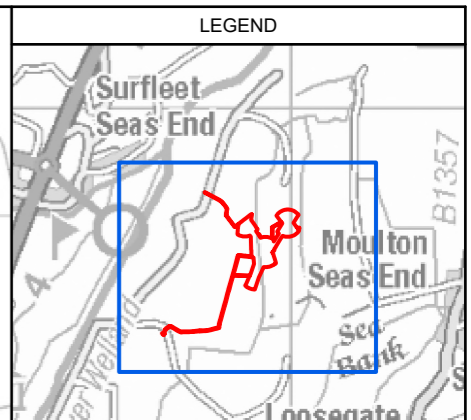
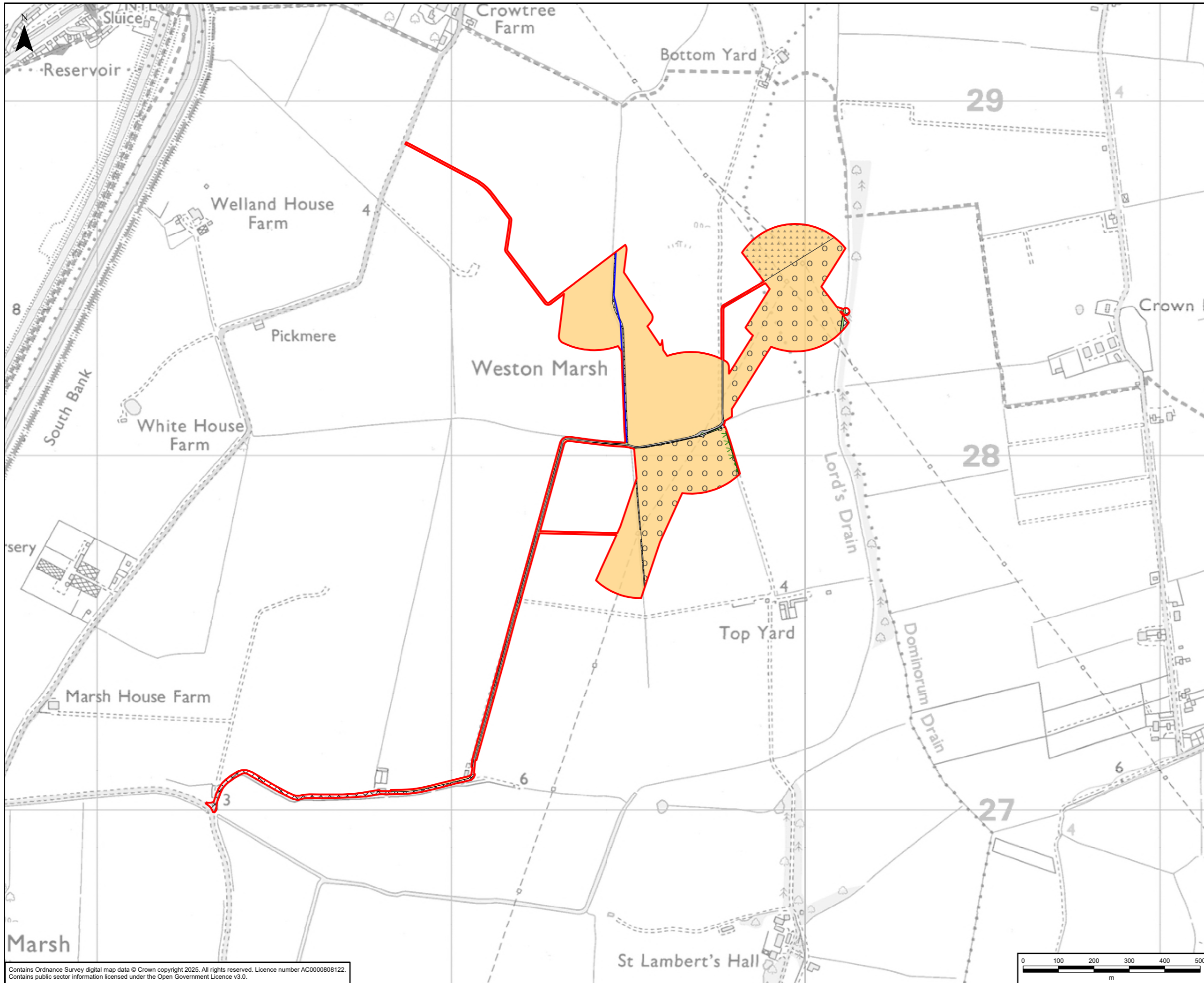

Figure 2C UK Habitat Classification Plan – S37 2WS Overhead Line Works



Legend

S37 2WS Site Boundary

UK Habitat Type

- VVV h2a6 - Other native hedgerow
- r2b - Other rivers and streams
- w1g (33) - Line of trees
- c1c - Cereal crops
- c1c7 - Other cereal crops
- c1d8 - Other non-cereal crops
- g4 - Modified grassland
- u1b - Developed land; sealed surface
- u1b6 - Other developed land
- Not Surveyed

A	15/06/2026	First Issue	MM	DF	SM
Rev	Date	Description	GIS	Chk	App

nationalgrid

Purpose: HABITAT CLASSIFICATION REPORT

Scheme: PROPOSED ELECTRICITY SUBSTATION AND OVERHEAD LINE WORKS AT WESTON MARSH

Document Title: FIGURE 2C
UK HABITAT CLASSIFICATION PLAN - S37 2WS

Creator:	Date:	Checker:	Date:	Approver:	Date:
MM	15/06/2026	DF	15/06/2026	SM	15/06/2026
Document Type:	Scale:	Format:	Sheets:	Rev:	
FIGURE	1:10,000	A3	OF	A	

Contains Ordnance Survey digital map data © Crown copyright 2025. All rights reserved. Licence number AC0000808122.
Contains public sector information licensed under the Open Government Licence v3.0.

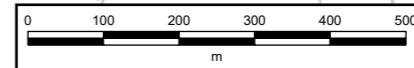

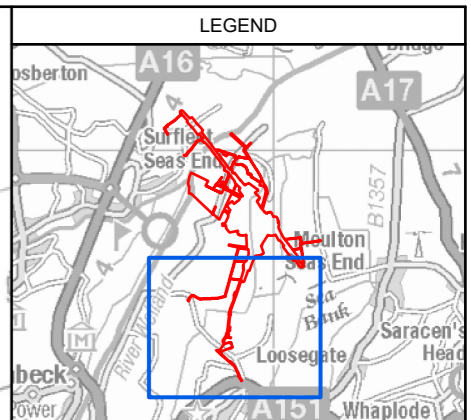
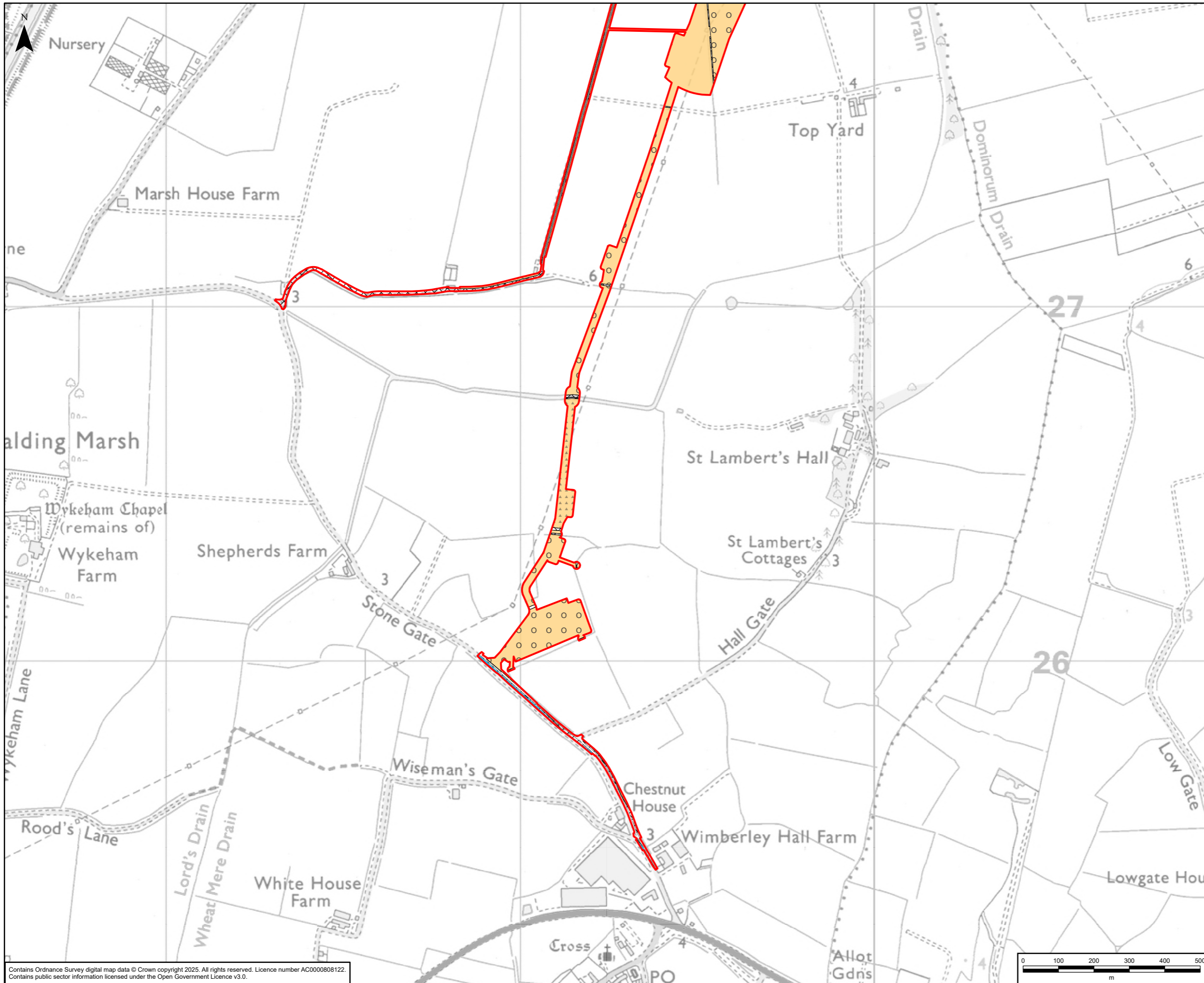

LEGEND

Legend

- S37 2WS Site Boundary
- UK Habitat Type**
- r1g - Other standing water
- w1g (33) - Line of trees
- c1c - Cereal crops
- c1c7 - Other cereal crops
- c1d8 - Other non-cereal crops
- u1b - Developed land; sealed surface
- u1b6 - Other developed land
- Not Surveyed

A	05/05/2026	First Issue	MM	DF	SM
Rev	Date	Description	GIS	Chk	App

nationalgrid

Purpose: HABITAT CLASSIFICATION REPORT

Scheme: PROPOSED ELECTRICITY SUBSTATION AND OVERHEAD LINE WORKS AT WESTON MARSH

Document Title: **FIGURE 2C
UK HABITAT CLASSIFICATION PLAN - S37 2WS**

Creator:	Date:	Checker:	Date:	Approver:	Date:
MM	05/05/2026	DF	05/05/2026	SM	05/05/2026
Document Type:	Scale:	Format:	Sheets:	Rev:	
FIGURE	1:10,000	A3	2 OF 2	A	

Contains Ordnance Survey digital map data © Crown copyright 2025. All rights reserved. Licence number AC0000808122.
Contains public sector information licensed under the Open Government Licence v3.0.

Figure 2D UK Habitat Classification Plan – Exempt Overhead Line Works

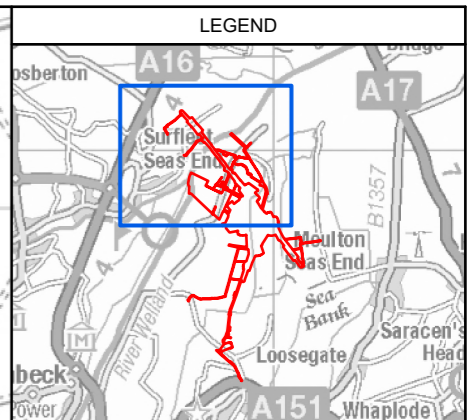
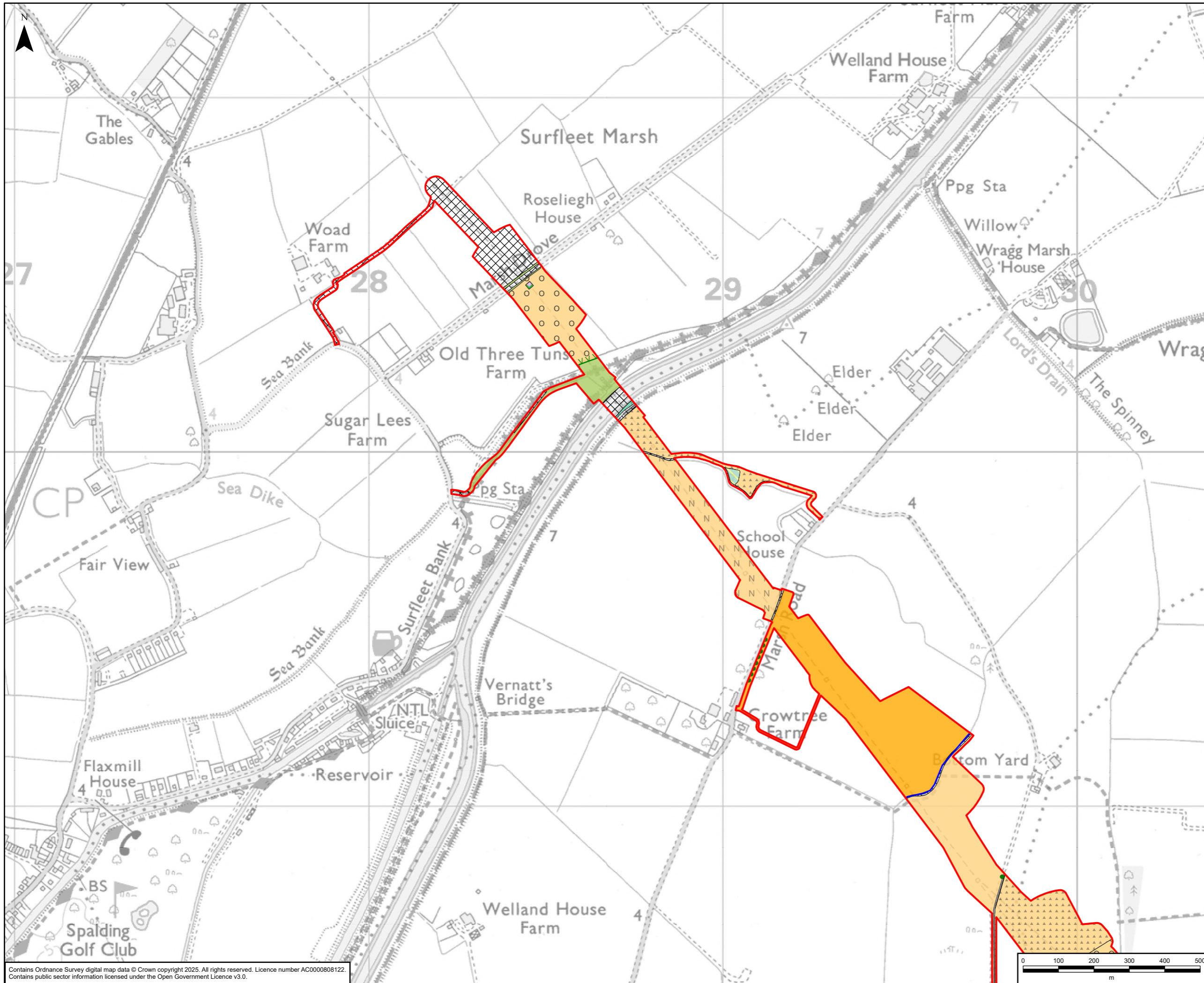

LEGEND

Legend

- S37 Exemptions Site Boundary
- UK Habitat Type**
- VVV h2a6 - Other native hedgerow
- r2b - Other rivers and streams
- w1g (33) - Line of trees
- c1 - Arable and horticulture
- c1c - Cereal crops
- c1c7 - Other cereal crops
- c1d - Non-cereal crops
- c1d8 - Other non-cereal crops
- f2e - Reedbeds
- g3c - Other neutral grassland
- g4 - Modified grassland
- h3h - Mixed scrub
- t2a - Coastal saltmarsh
- u1b - Developed land; sealed surface
- Not Surveyed

A	05/05/2026	First Issue	MM	DF	SM
Rev	Date	Description	GIS	Chk	App

nationalgrid					
Purpose: HABITAT CLASSIFICATION REPORT					
Scheme: PROPOSED ELECTRICITY SUBSTATION AND OVERHEAD LINE WORKS AT WESTON MARSH					
Document Title: FIGURE 2D UK HABITAT CLASSIFICATION PLAN - S37 EXEMPTIONS					
Creator:	Date:	Checker:	Date:	Approver:	Date:
MM	05/05/2026	DF	05/05/2026	SM	05/05/2026
Document Type:	Scale:	Format:	Sheets:	Rev:	
FIGURE	1:10,000	A3	1 OF 2	A	

Contains Ordnance Survey digital map data © Crown copyright 2025. All rights reserved. Licence number AC0000808122.
 Contains public sector information licensed under the Open Government Licence v3.0.

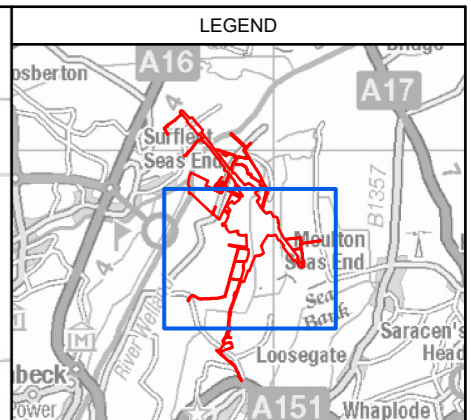
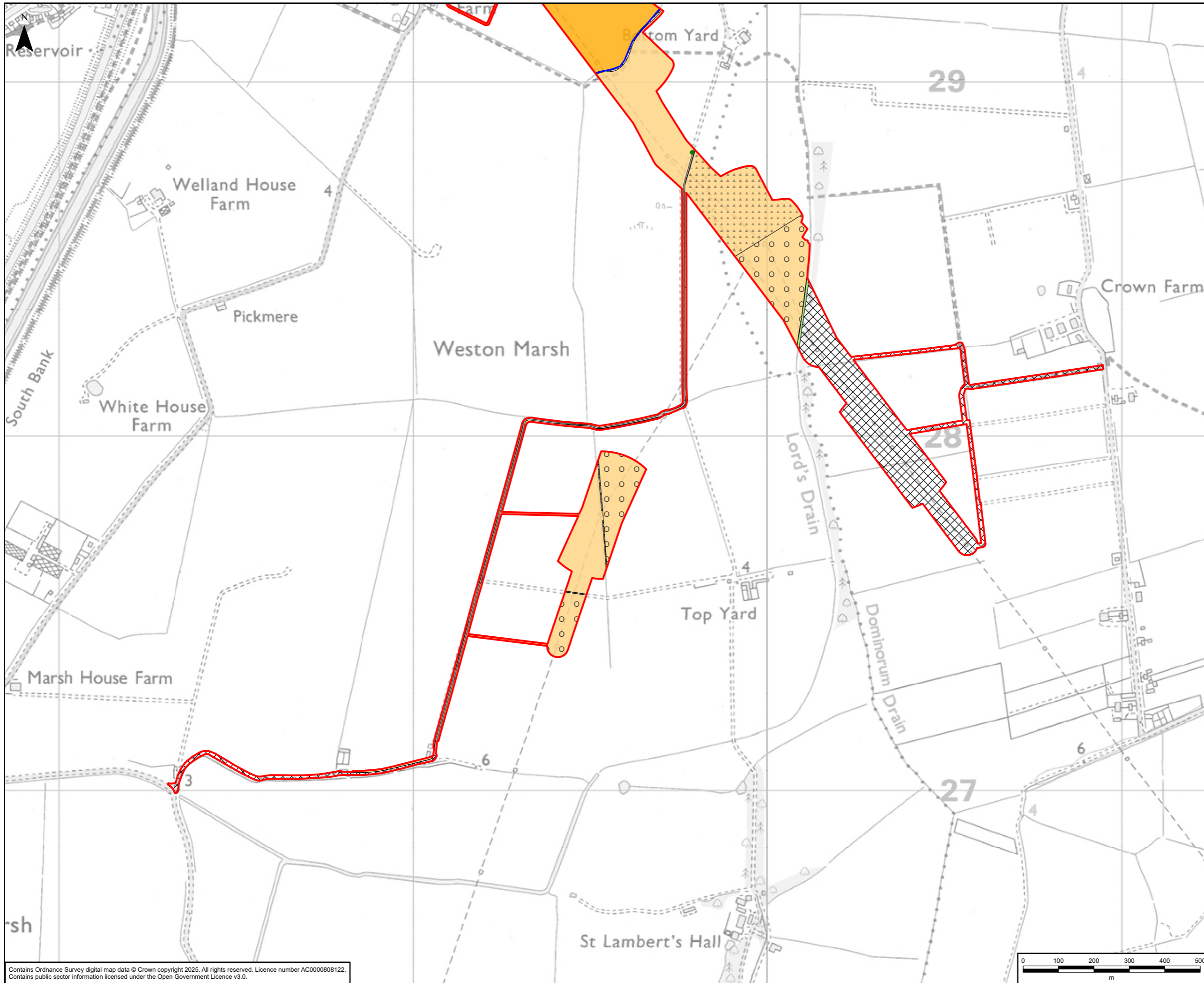

LEGEND

Legend

S37 Exemptions Site Boundary

UK Habitat Type

- r2b - Other rivers and streams
- w1g (33) - Line of trees
- c1 - Arable and horticulture
- c1c - Cereal crops
- c1c7 - Other cereal crops
- c1d8 - Other non-cereal crops
- g4 - Modified grassland
- u1b - Developed land; sealed surface
- u1b6 - Other developed land
- Not Surveyed

A	05/05/2026	First Issue	MM	DF	SM
Rev	Date	Description	GIS	Chk	App

nationalgrid

Purpose: HABITAT CLASSIFICATION REPORT

Scheme: PROPOSED ELECTRICITY SUBSTATION AND OVERHEAD LINE WORKS AT WESTON MARSH

Document Title: FIGURE 2D UK HABITAT CLASSIFICATION PLAN - S37 EXEMPTIONS

Creator:	Date:	Checker:	Date:	Approver:	Date:
MM	05/05/2026	DF	05/05/2026	SM	05/05/2026
Document Type:	Scale:	Format:	Sheets:	Rev:	
FIGURE	1:10,000	A3	2 OF 2	A	

Contains Ordnance Survey digital map data © Crown copyright 2025. All rights reserved. Licence number AC0000808122. Contains public sector information licensed under the Open Government Licence v3.0.

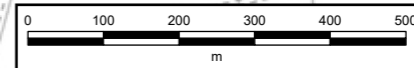

Appendix A Habitats Identified within the Scheme Site Boundary

Table A.1 Summary table of habitats identified within the Scheme Site Boundary as shown on Figures 1A-1D

UKHab code (lowest level of UKHab recorded)	Habitat type (lowest level of UKHab recorded)	Recorded within the Substation Works Site Boundary	Recorded within the S37 2WS Overhead Line Works Site Boundary	Recorded within the S37 4ZM Overhead Line Works Site Boundary	Recorded within the Exempt Overhead Line Works Site Boundary
c1c	Cereal crops	Yes	Yes	Yes	Yes
c1c7	Other cereal crops	Yes	Yes	Yes	Yes
c1d	Non-cereal crops	Yes	No	No	Yes
c1d8	Other non-cereal crops	Yes	Yes	Yes	Yes
f2e	Reedbeds	No	No	No	Yes
g3c	Other neutral grassland	No	No	No	Yes
g3c6	<i>Lolium-Cynosurus</i> neutral grassland	Yes	No	No	No
g4	Modified grassland	No	Yes	Yes	Yes
h2a6	Hedgerow (priority habitat)	Yes	Yes	Yes	Yes
h3h	Mixed scrub	No	No	No	Yes
r1g	Other standing water	Yes	Yes	Yes	Yes
r2a	Rivers (priority habitat)	No	No	No	Yes
r2b	Other rivers and streams	Yes	Yes	Yes	Yes
t2a	Coastal saltmarsh	No	No	No	Yes
u1b	Developed land; sealed surface	Yes	Yes	Yes	Yes
u1b5	Buildings	Yes	No	No	No

UKHab code (lowest level of UKHab recorded)	Habitat type (lowest level of UKHab recorded)	Recorded within the Substation Works Site Boundary	Recorded within the S37 2WS Overhead Line Works Site Boundary	Recorded within the S37 4ZM Overhead Line Works Site Boundary	Recorded within the Exempt Overhead Line Works Site Boundary
u1b6	Other developed land	Yes	Yes	Yes	Yes
u1e	Built linear feature	Yes	No	No	No
w1f*	Lowland mixed deciduous woodland	No	No	Yes	Yes
w1gg (33)	Line of trees	Yes	Yes	Yes	Yes

National Grid plc
National Grid House,
Warwick Technology Park,
Gallows Hill, Warwick.
CV34 6DA United Kingdom

Registered in England and Wales
No. 4031152
nationalgrid.com