

Proposed Electricity Substation and Overhead Line Works at Weston Marsh

Transport Statement - Part 3 of 3

June 2026

Proposed Electricity Substation and Overhead Line Works at Weston Marsh

Document Control

Document Properties	
Organisation	Arup AECOM
Approved by	National Grid
Title	Transport Statement
Document Register ID	GWNC-ARU-SS50-XXXXXX-RPT-ES-000018
Data Classification	Public

Version History			
Document	Version	Status	Description / Changes
May 2026	1.0	Final	First Issue
June 2026	2.0	Final	Second Issue - minor updates to cross references

Contents

1.	Introduction	1
1.1	Overview	1
1.2	Summary of the Scheme	1
1.3	Purpose of this report	2
1.4	Structure	3
2.	Legislative and Policy Framework	4
2.1	Legislation and National Policy	4
2.2	Regional and Local Policy	5
3.	Methodology	6
3.1	Scope of the Assessment	6
3.2	Study Area	6
3.3	Data Collection	6
3.4	Assessment Approach	7
	Operational Traffic	7
	Construction Traffic	7
	Highway Assessment	12
	PRoW Assessment	15
3.5	Assumptions and Limitations	15
4.	Baseline and Evaluation	16
4.1	Introduction	16
4.2	Local Area Context	16
4.3	Local Highway Network	16
	Key junctions	17
4.4	Public Transport	18
4.5	Baseline Traffic Data	18
5.	Impacts and Highway Interventions	31
5.1	The Scheme	31
	Substation Works	31
	S37 Overhead Line Works	32
	Permanent Access Proposals	32
	Temporary Access Proposals	32
	Public Rights of Way	33
5.2	Trip Generation and Distribution	33
	Forecast Traffic Generation	33
	Construction Traffic Routes	34
5.3	Assessment	40

5.4	Construction Traffic Management Plan	42
-----	--------------------------------------	----

6.	Summary	43
-----------	----------------	-----------

Table 1.1	Components of the Scheme	1
Table 3.1	Traffic Surveys	7
Table 3.2	Gravity Model Details	11
Table 3.3	TEMPro Traffic Growth Factors 2024 - 2029	13
Table 3.4	Emerging Developments	13
Table 4.1	2024 Traffic Flow Data (in vehicles)	20
Table 5.1	Peak Period Construction Traffic Impact	40

Image 4.1	Survey Count Location	19
Image 4.2	2024 Baseline AM (07:00 to 08:00hrs) flows	21
Image 4.3	2024 Baseline AM (08:00 to 09:00hrs) flow	22
Image 4.4	2024 Baseline PM (17:00 to 18:00hrs) flow	23
Image 4.5	2024 Baseline PM (18:00 to 19:00hrs) flow	24
Image 4.6	2029 Future Base Year AM (07:00 to 08:00hrs) hour	25
Image 4.7	2029 Future Base Year AM (08:00 to 09:00hrs) hour	26
Image 4.8	2029 Future Base Year PM (17:00 to 18:00hrs) hour	27
Image 4.9	2029 Future Base Year PM (18:00 to 19:00hrs) hour	28
Image 5.1	Construction Traffic Profile	34
Image 5.2	Construction Traffic AM Peak Hour (07:00 – 08:00hrs)	36
Image 5.3	Construction Traffic AM Peak Hour (08:00 – 09:00hrs)	37
Image 5.4	Construction Traffic PM Peak Hour (17:00 – 18:00 hrs)	38
Image 5.5	Construction Traffic PM Peak Hour (18:00 – 19:00hrs)	39

References	45
------------	----

Figure 1	Scheme Site Boundary	48
Figure 2	Site Location and Wider Context	50
Figure 3	Local Highway Network	52
Figure 4	Proposed TCPA Works Site	54
Figure 5	Public Rights of Way	57
Figure 6	Public Rights of Way Diversion	59

Appendix A	Construction Traffic Information	
Appendix B	Gravity Model	
Appendix C	TEMPro Traffic Growth Factors	
Appendix D	Traffic Survey Data	
Appendix E	Highway Works and Swept Path Analysis	

Appendix E Highway Works and Swept Path Analysis

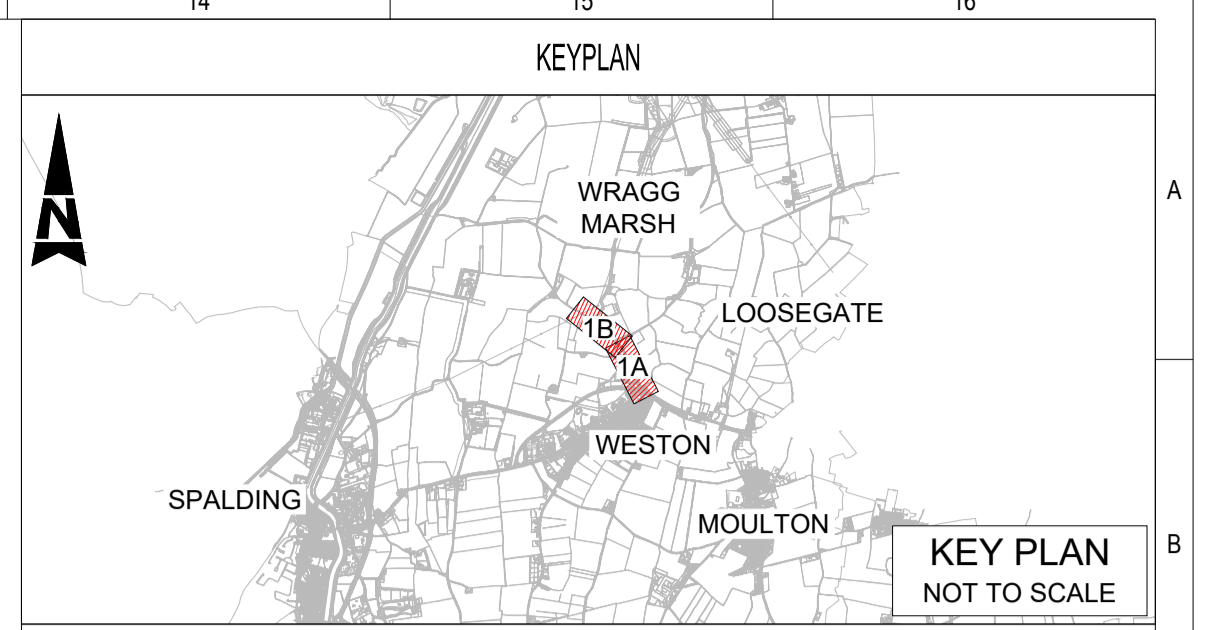
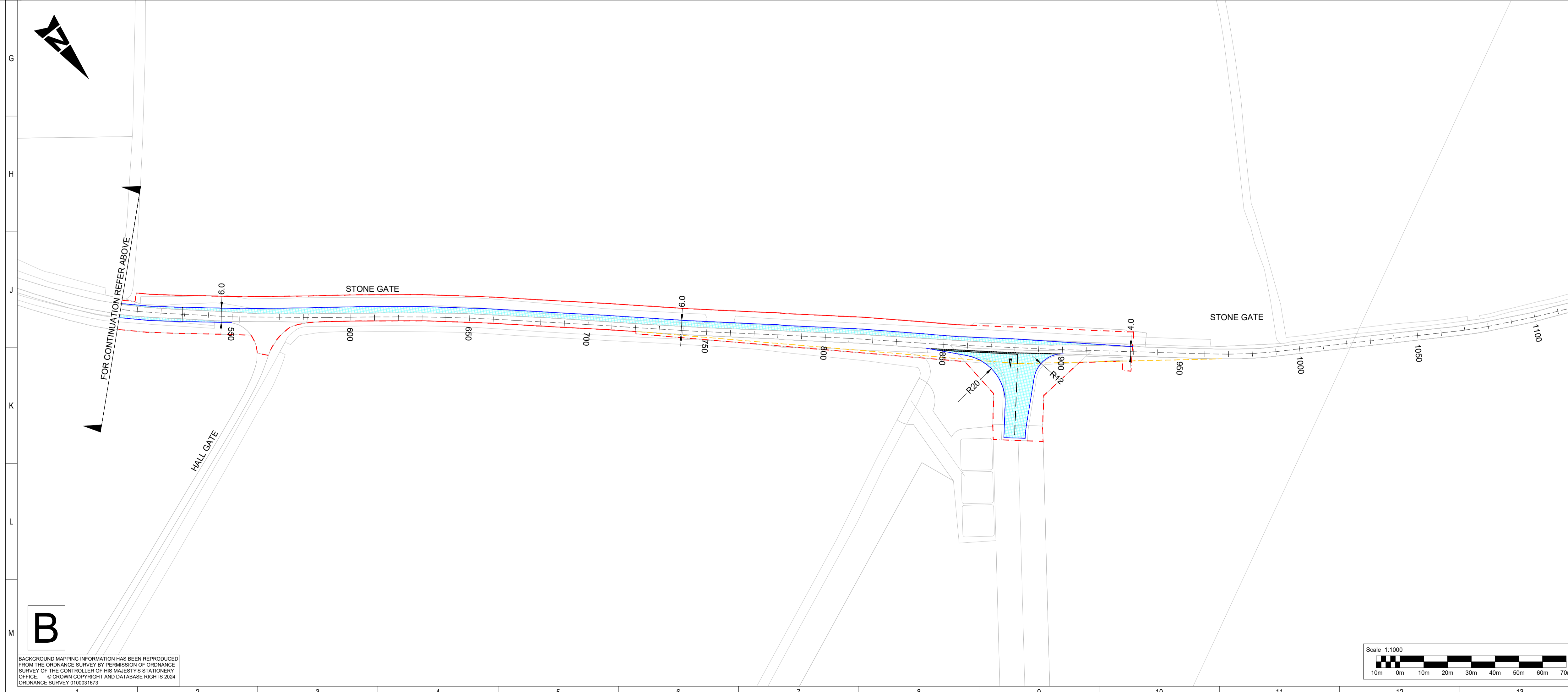
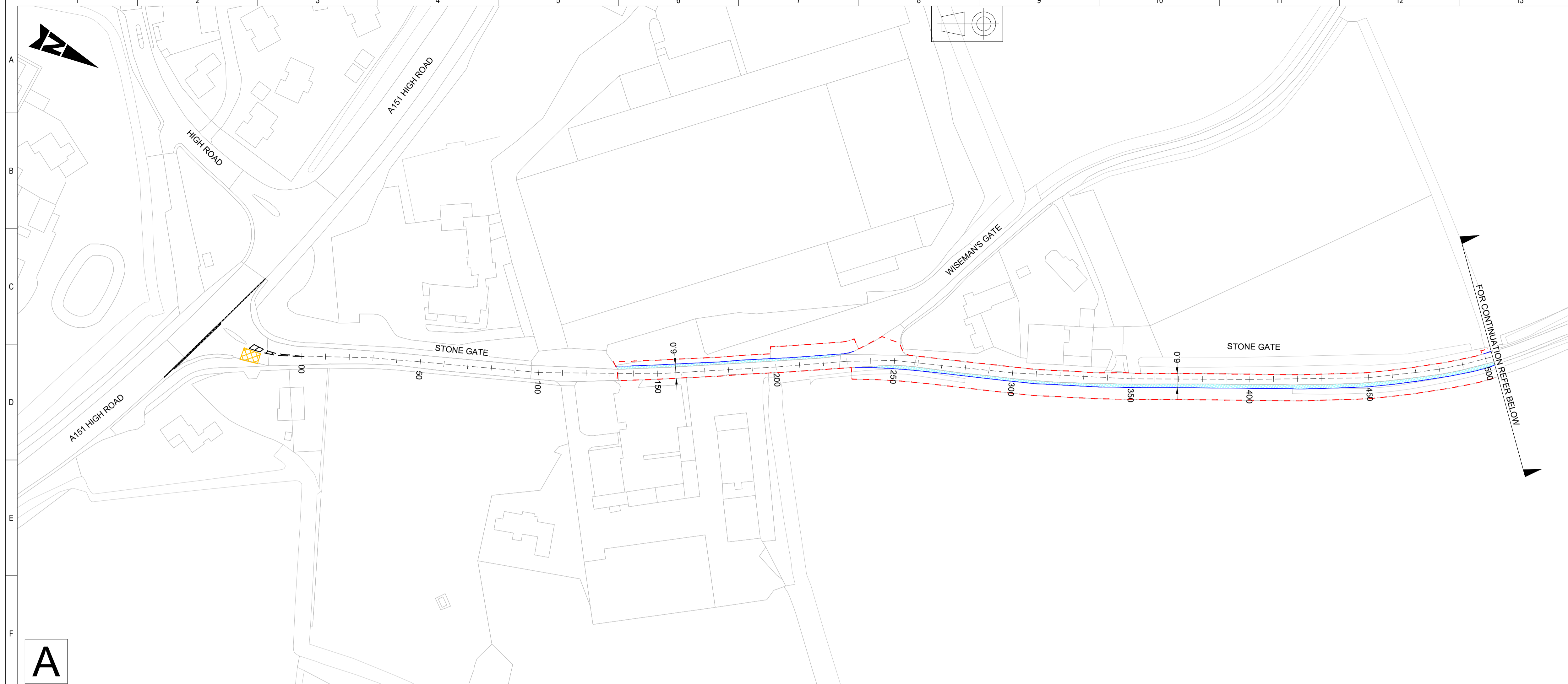

- NOTES:**
1. THIS DRAWING IS FOR INFORMATION ONLY.
 2. ALL MEASUREMENTS ARE IN METERS.
 3. ALL DESIGNS ARE BASED ON ORDINANCE SURVEY AND HAVE BEEN SHOWN INDICATIVELY ONLY AND ARE SUBJECT TO FURTHER ITERATION FOLLOWING THE RECEIPT OF THE TOPOGRAPHICAL SURVEY AT THE NEXT DESIGN STAGE.
 4. THESE DRAWINGS ARE PRODUCED FOR FEASIBILITY STAGE ONLY AND SHOULD NOT BE USED FOR CONSTRUCTION.
 5. VEGETATION CLEARANCE IS REQUIRED TO MAINTAIN UNOBSTRUCTED VISIBILITY SPLAYS.
 6. LOCALIZED WIDENING PROPOSED WHERE PASSING PLACES ARE NON-VIALBLE AND EXISTING CARRIAGEWAY WIDTH IS LESS THAN 6 METERS.

- KEY:**
- PROPOSED EDGE OF CARRIAGEWAY
 - +— CENTRE LINE
 - - - - ORDER LIMITS (RED LINE BOUNDARY)
 - - - - INDICATIVE ROAD MARKINGS
 - - - - VISIBILITY SIGHTLINE
 - PROPOSED PAVED AREA (CARRIAGEWAY WIDENING / NEW ACCESS)

This drawing and any information or descriptive matter set out hereon are confidential and copyright property of National Grid and must not be disclosed, loaned, copied or used for any purpose without written permission

Rev.	Date	Comment	HS	PO	TC	JS
P01	08/05/2026	FIRST ISSUE				
NATIONAL GRID INVESTMENT NUMBER: 102183			Draw by	Check	Rev by	Appr.

 National Grid plc, Warwick Technology Park, Galloway Hill, Warwick, CV34 6DA.	Site WESTON MARSH SUBSTATION A (400KV-15AIS)	
	Contractor WSP House, 70 Chancery Lane, London, WC2A 1AF, UK T+ 44 (0) 207 314 5500, F+ 44 (0) 207 314 5111 wsp.com	
Title PROPOSED HIGHWAYS INTERVENTIONS & CONSTRUCTION ACCESS POINT FOR TEMPORARY ACCESS AT STONE GATE		Status S2
Purpose of issue SHARED FOR INFORMATION		Revision P01
Contractor Drawing No. PDD-100944-HWY-946		Sheet of 001
Customer Drawing No. -----		Issue A
Drawn HS	Checked PD	Reviewed -
Approved -	Date 30/04/2026	Scale 1:1000
Size A1		

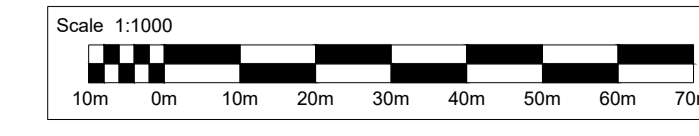

BACKGROUND MAPPING INFORMATION HAS BEEN REPRODUCED FROM THE ORDINANCE SURVEY BY PERMISSION OF ORDINANCE SURVEY OF THE CONTROLLER OF HER MAJESTY'S STATIONERY OFFICE. © CROWN COPYRIGHT AND DATABASE RIGHTS 2024. ORDINANCE SURVEY 0100031873.

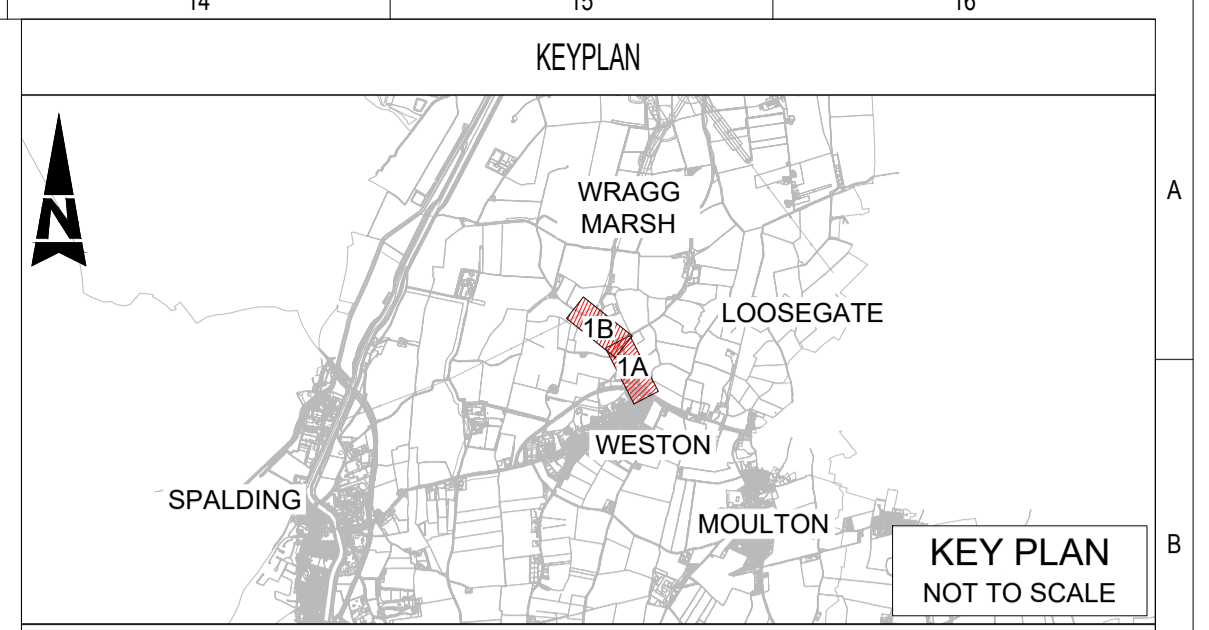
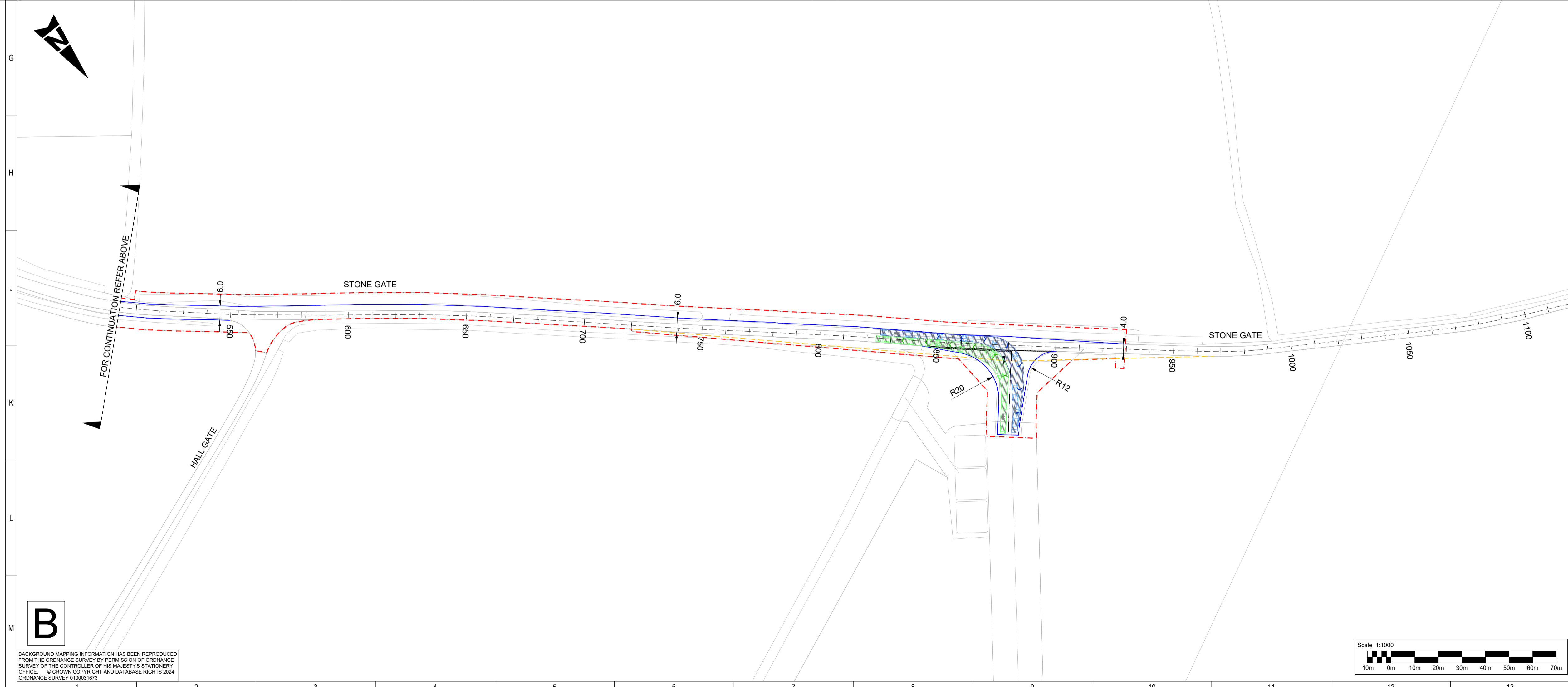
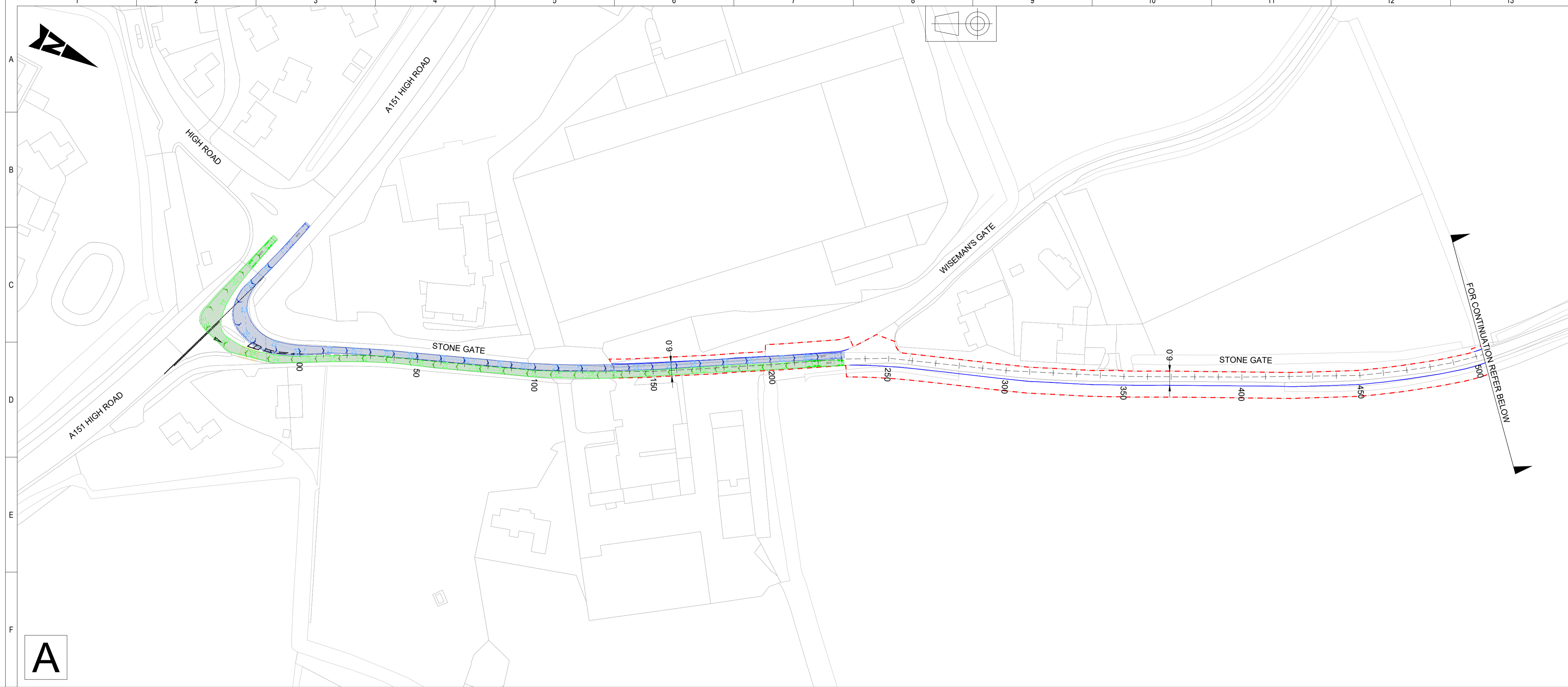

- NOTES:**
1. THIS DRAWING IS FOR INFORMATION ONLY.
 2. ALL MEASUREMENTS ARE IN METERS.
 3. ALL DESIGNS ARE BASED ON ORDINANCE SURVEY AND HAVE BEEN SHOWN INDICATIVELY ONLY AND ARE SUBJECT TO FURTHER ITERATION FOLLOWING THE RECEIPT OF THE TOPOGRAPHICAL SURVEY AT THE NEXT DESIGN STAGE.
 4. THESE DRAWINGS ARE PRODUCED FOR FEASIBILITY STAGE ONLY AND SHOULD NOT BE USED FOR CONSTRUCTION.
 5. VEGETATION CLEARANCE IS REQUIRED TO MAINTAIN UNOBSTRUCTED VISIBILITY SPLAYS.
 6. LOCALIZED WIDENING PROPOSED WHERE PASSING PLACES ARE NON-VIALBLE AND EXISTING CARRIAGEWAY WIDTH IS LESS THAN 6 METERS.
 7. VEHICLE TRACKING HAS BEEN CARRIED OUT FOR LOW LOADER 16.154m AND HEAVY GOODS VEHICLE 16.48m. LOW LOADER TRACKING PATHS ARE SHOWN IN THIS DRAWING, DEMONSTRATING THE WORSE TURNING MOVEMENTS AT JUNCTION/ACCESS POINT.

- KEY:**
- PROPOSED EDGE OF CARRIAGEWAY
 - CENTRE LINE
 - - - ORDER LIMITS (RED LINE BOUNDARY)
 - - - INDICATIVE ROAD MARKINGS
 - - - VISIBILITY SIGHTLINE
 - EXTENT OF VEHICULAR BODY
 - EXTENT OF WHEELS
 - VEHICLE MOVEMENT OUT (ALSO SEE NOTE 7)
 - EXTENT OF VEHICULAR BODY
 - EXTENT OF WHEELS
 - VEHICLE MOVEMENT IN (ALSO SEE NOTE 7)

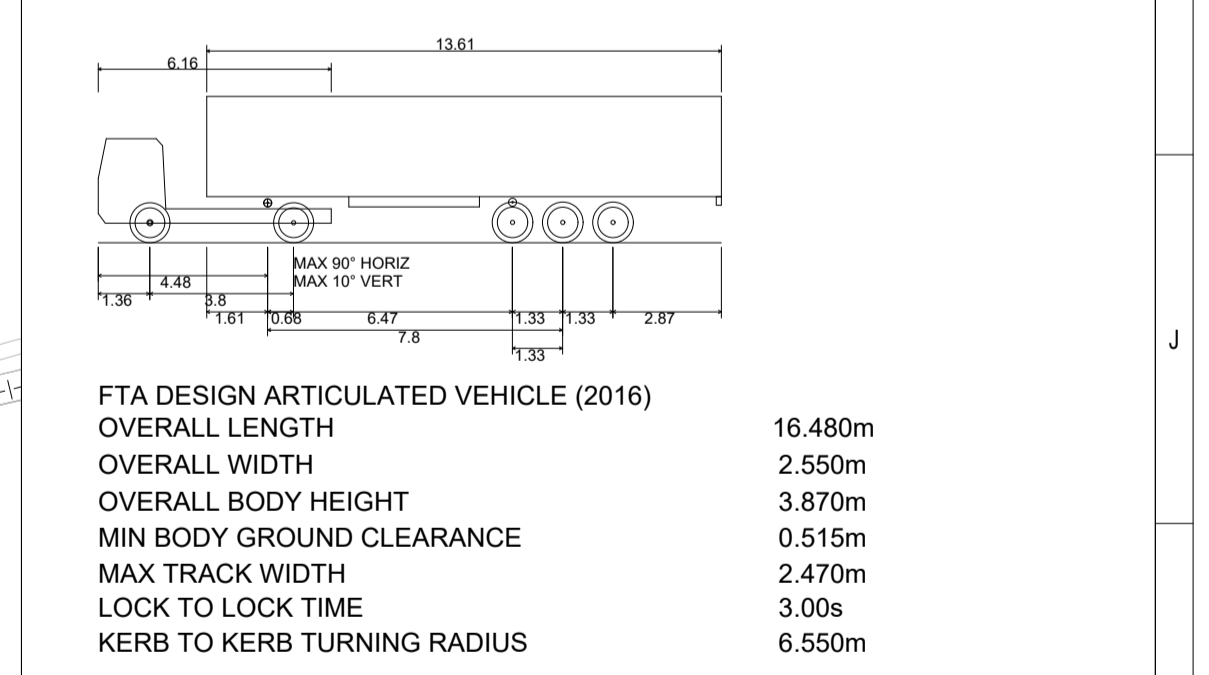
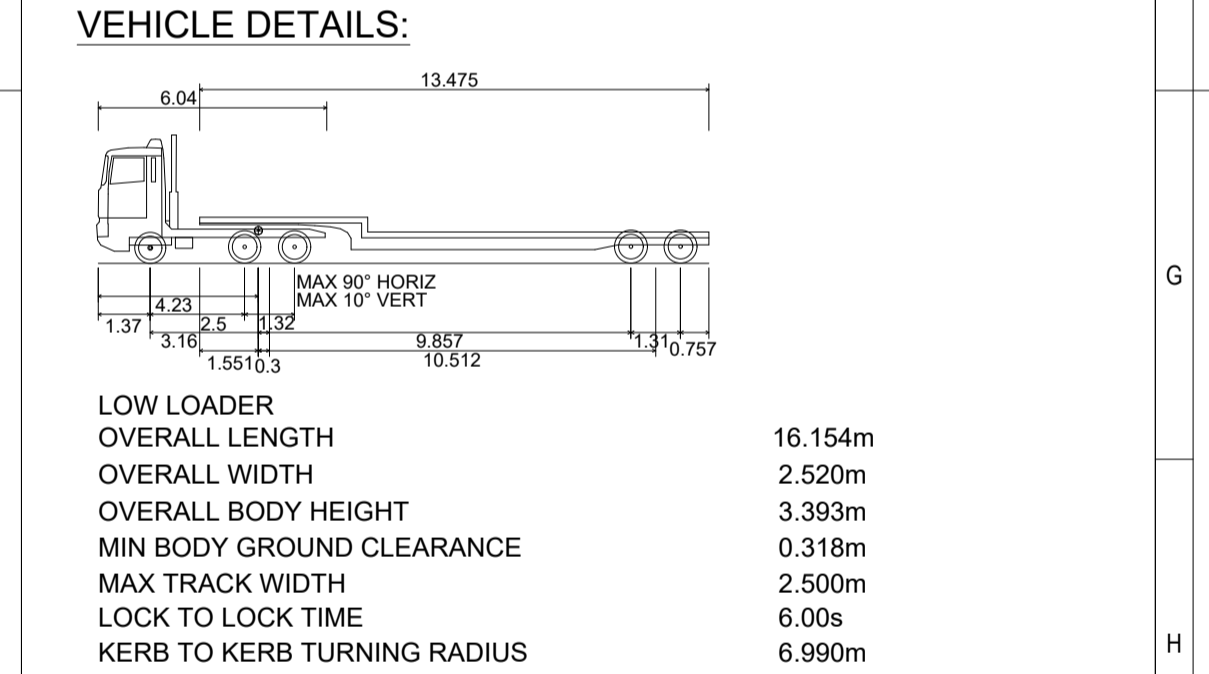

This drawing and any information or descriptive matter set out hereon are confidential and copyright property of National Grid and must not be disclosed, loaned, copied or used for any purpose without written permission

P01	08/05/2026	FIRST ISSUE	HS	PO	TC	JS
Rev.	Date	Comment	Drawn by	Check	Rev by	Appr.

NATIONAL GRID INVESTMENT NUMBER: 102183

<p>National Grid plc, Warwick Technology Park, Galloway Hill, Warwick, CV34 6DA.</p>	<p>Site WESTON MARSH SUBSTATION A (400KV-15AIS)</p>	
	<p>Contractor wsp</p> <p>WSP House, 70 Chancery Lane, London, WC2A 1AF, UK T: 44 (0) 207 314 5500 F: 44 (0) 207 314 5111 wsp.com</p>	
<p>Title CONSTRUCTION VEHICLE TRACKING FOR TEMPORARY ACCES AT STONE GATE</p>		<p>Status S2</p>
<p>Purpose of issue SHARED FOR INFORMATION</p>		<p>Revision P01</p>
<p>Contractor Drawing No. PDD-100944-HWY-945</p>		<p>Issue A</p>
<p>Customer Drawing No. ----</p>		<p>Sheet 001 of 001</p>
<p>Drawn HS</p>	<p>Checked PD</p>	<p>Reviewed TC</p>
<p>Approved JS</p>	<p>Date 08/05/2026</p>	<p>Scale 1:1000</p>
<p>Size A1</p>		

BACKGROUND MAPPING INFORMATION HAS BEEN REPRODUCED FROM THE ORDINANCE SURVEY BY PERMISSION OF ORDINANCE SURVEY OF THE CONTROLLER OF HER MAJESTY'S STATIONERY OFFICE. © CROWN COPYRIGHT AND DATABASE RIGHTS 2024. ORDINANCE SURVEY 0100031873

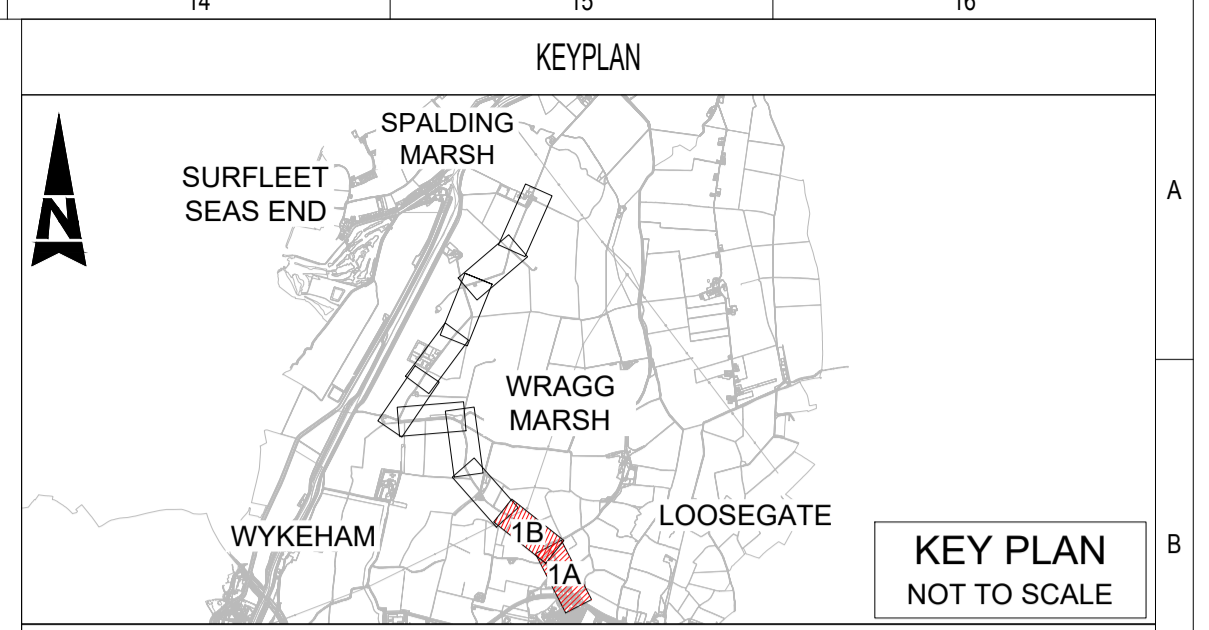
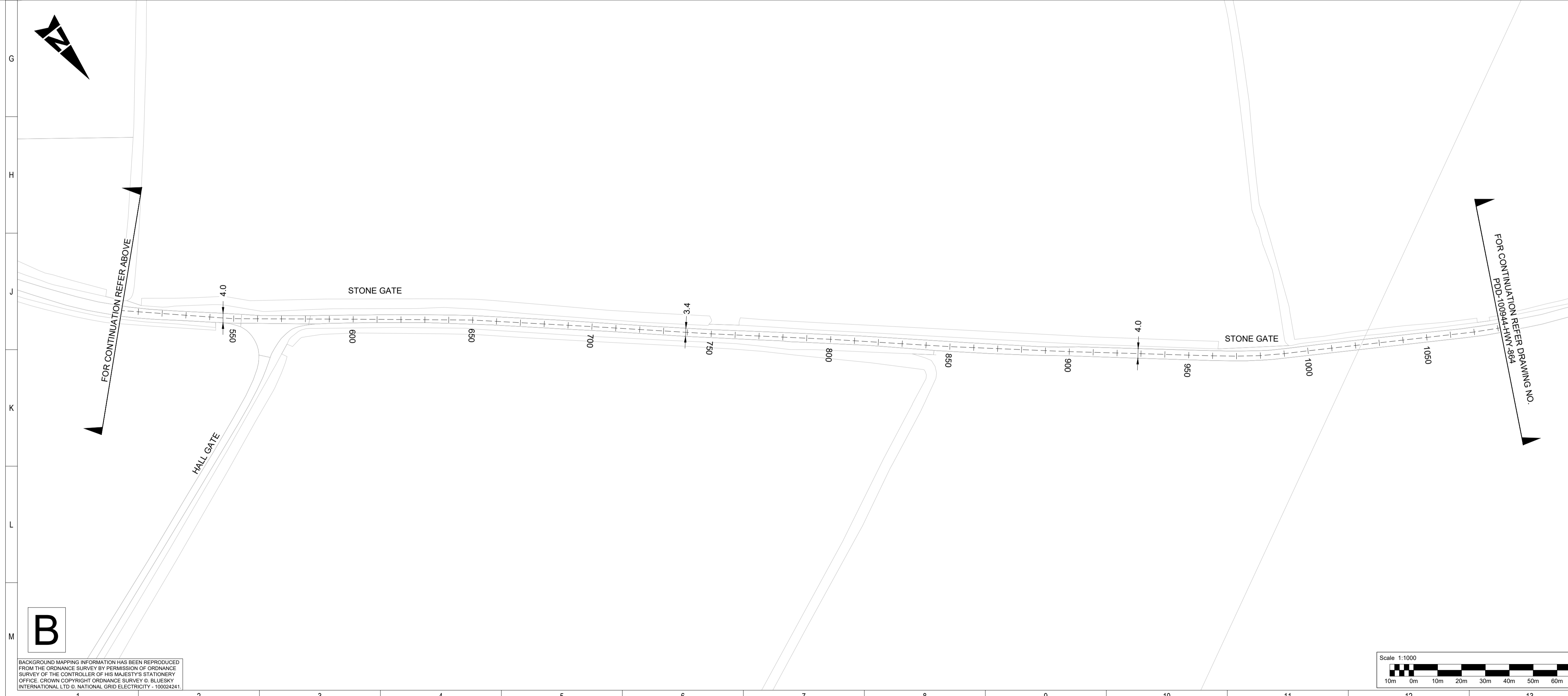
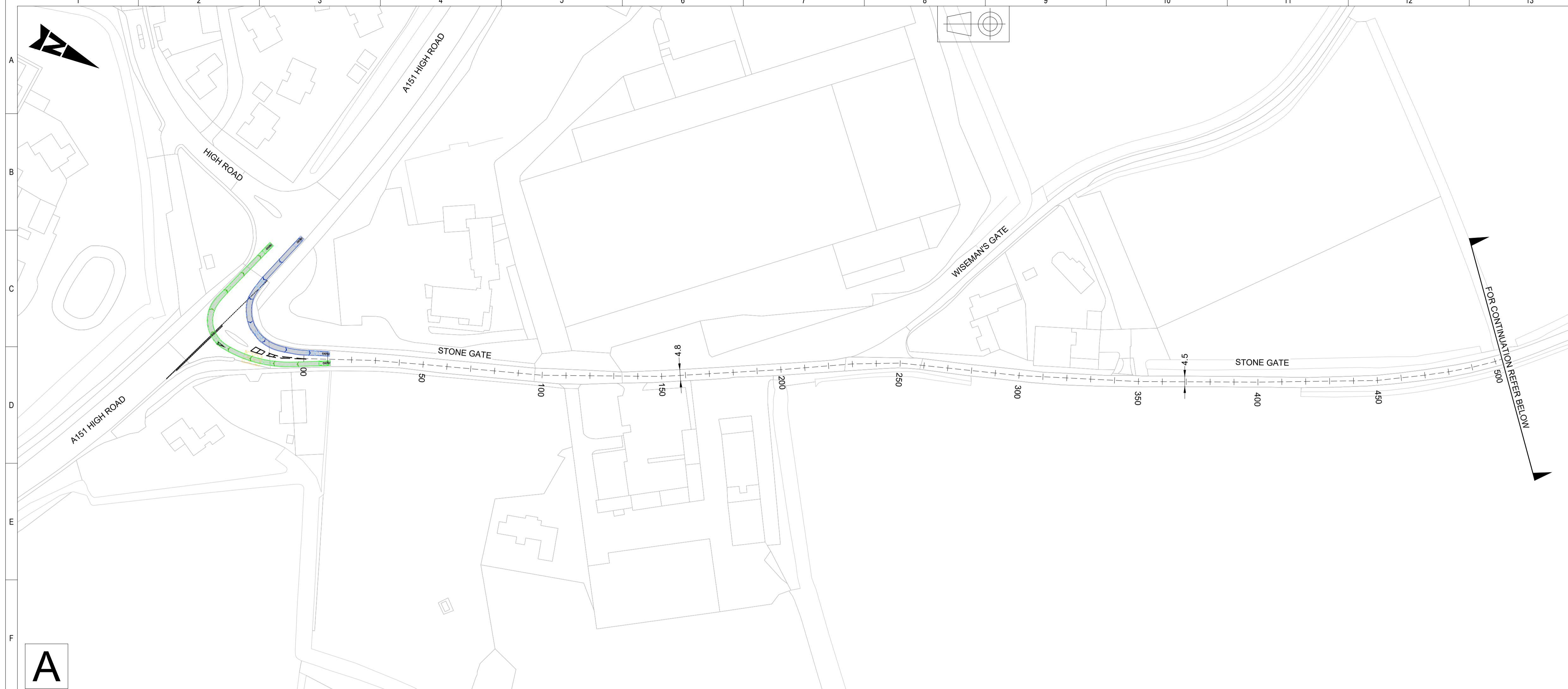

NOTES:

- THIS DRAWING IS FOR INFORMATION ONLY.
- ALL MEASUREMENTS ARE IN METERS.
- ALL DESIGNS ARE BASED ON ORDINANCE SURVEY AND HAVE BEEN SHOWN INDICATIVELY ONLY AND ARE SUBJECT TO FURTHER ITERATION FOLLOWING THE RECEIPT OF THE TOPOGRAPHICAL SURVEY AT THE NEXT DESIGN STAGE.
- THESE DRAWINGS ARE PRODUCED FOR FEASIBILITY STAGE ONLY AND SHOULD NOT BE USED FOR CONSTRUCTION.
- VEGETATION CLEARANCE IS REQUIRED TO MAINTAIN UNOBSTRUCTED VISIBILITY SPLAYS.

KEY:

- PROPOSED EDGE OF CARRIAGEWAY
- CENTRE LINE
- VISIBILITY SIGHTLINE
- INDICATIVE ROAD MARKINGS
- ORDER LIMITS (RED LINE BOUNDARY)
- PROPOSED PAVED AREA (CARRIAGEWAY WIDENING / NEW ACCESS)
- EXTENT OF VEHICULAR BODY
- EXTENT OF WHEELS
- VEHICLE MOVEMENT OUT
- EXTENT OF VEHICULAR BODY
- EXTENT OF WHEELS
- VEHICLE MOVEMENT IN

VEHICLE DETAILS:

4 WHEEL DRIVE CAR	
OVERALL LENGTH	4.905m
OVERALL WIDTH	2.009m
OVERALL BODY HEIGHT	1.873m
MIN BODY GROUND CLEARANCE	0.267m
MAX TRACK WIDTH	1.817m
LOCK TO LOCK TIME	4.00s
KERB TO KERB TURNING RADIUS	5.725m

This drawing and any information or descriptive matter set out hereon are confidential and copyright property of National Grid and must not be disclosed, loaned, copied or used for any purpose without written permission

Rev.	Date	Comment	Drawn by	Checked	Rev by	Appr.
P01	08/05/2026	FIRST ISSUE	NK	PO	TC	JS

NATIONAL GRID INVESTMENT NUMBER: 100944

<p>National Grid plc, Warwick Technology Park, Galloway Hill, Warwick, CV34 6DA.</p>	<p>Site WESTON MARSH SUBSTATION A (400KV-15AIS)</p>	
	<p>Contractor WSP House, 70 Chancery Lane, London, WC2A 1AF, UK. T+ 44 (0) 207 314 5500; F+ 44 (0) 207 314 5111; wsp.com</p>	
<p>Title MAINTENANCE VEHICLE TRACKING FOR PERMANENT ACCESS TO WESTON MARSH A 400KV SUBSTATION (SHEET 1 OF 5)</p>		<p>Status S2</p>
<p>Purpose of issue Shared for Information</p>		<p>Revision P01</p>
<p>Contractor Drawing No. PDD-100944-HWY-863</p>		<p>Issue A</p>
<p>Customer Drawing No. ----</p>		<p>Sheet 001 of 005</p>
<p>Drawn NK</p>	<p>Checked PD</p>	<p>Reviewed TC</p>
<p>Approved JS</p>	<p>Date 08/05/2026</p>	<p>Scale 1:1000</p>
<p>Size A1</p>		

BACKGROUND MAPPING INFORMATION HAS BEEN REPRODUCED FROM THE ORDINANCE SURVEY BY PERMISSION OF ORDINANCE SURVEY OF THE CONTROLLER OF HER MAJESTY'S STATIONERY OFFICE. CROWN COPYRIGHT ORDINANCE SURVEY © BLUESKY INTERNATIONAL LTD © NATIONAL GRID ELECTRICITY - 10094441

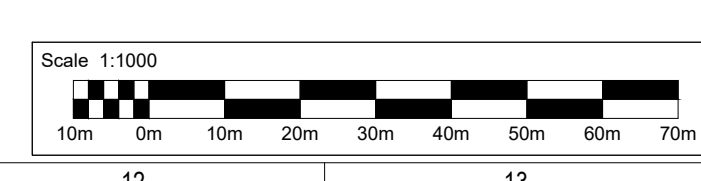

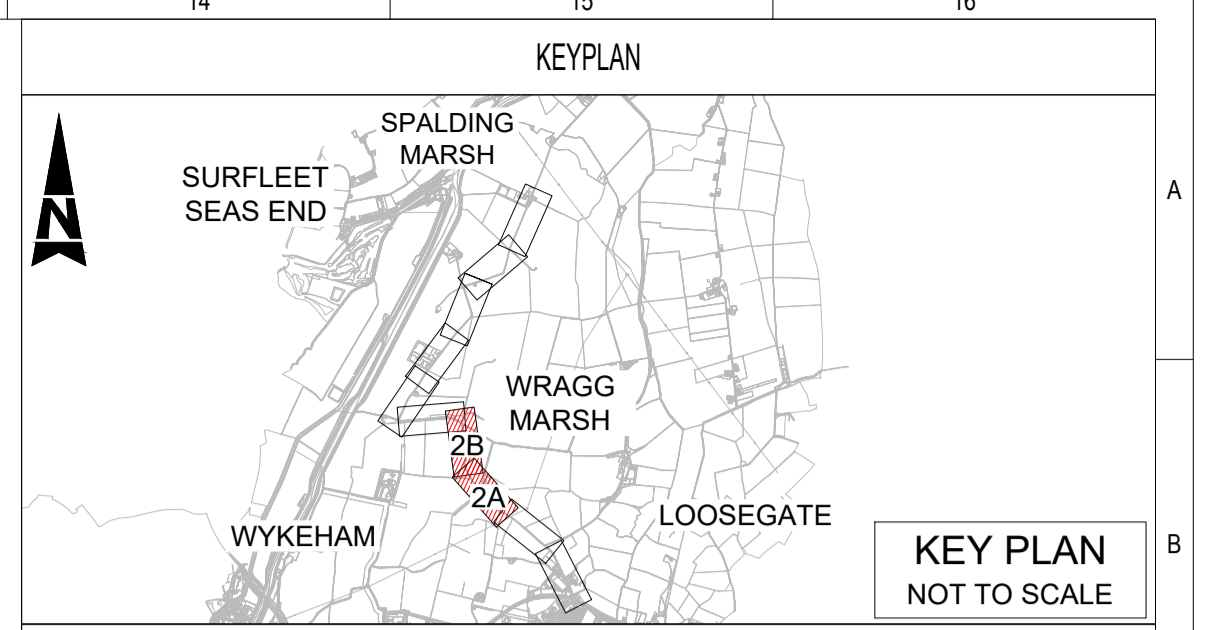
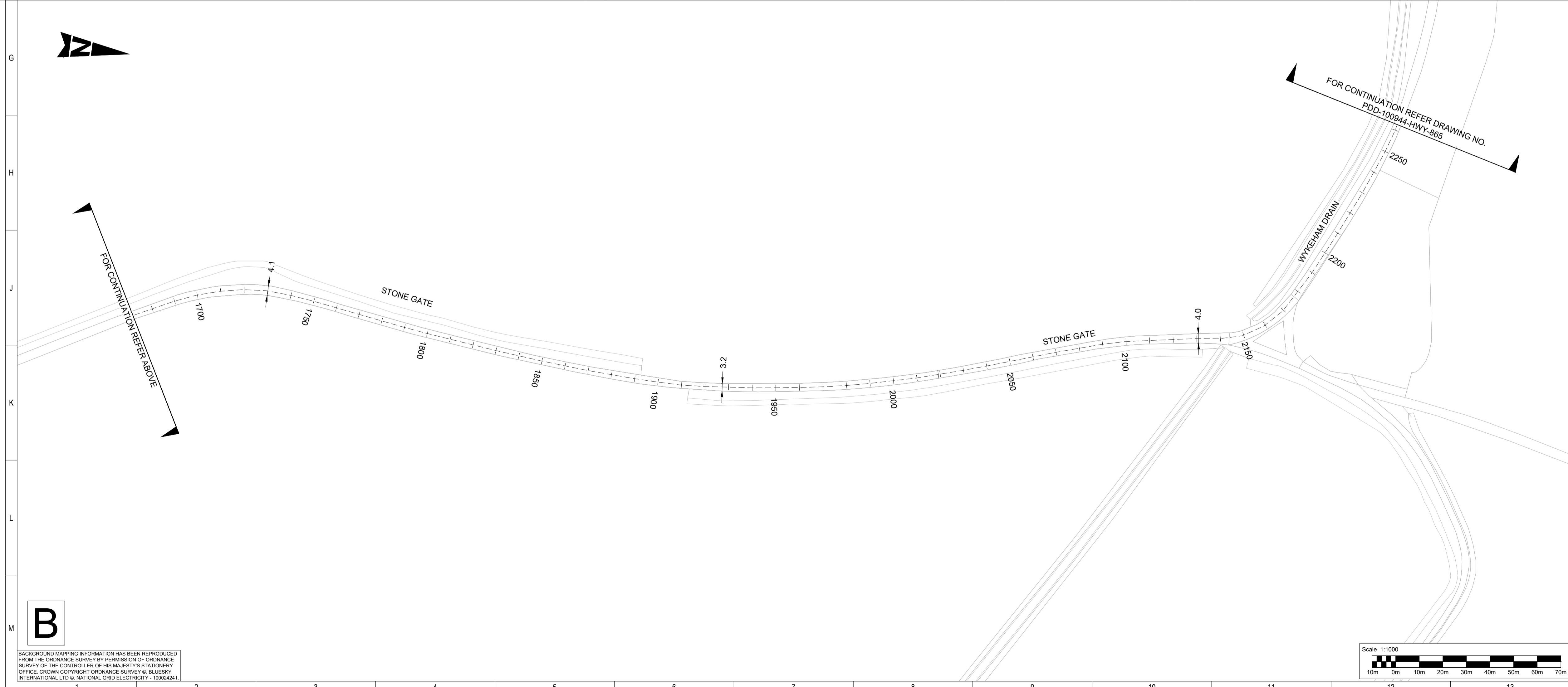
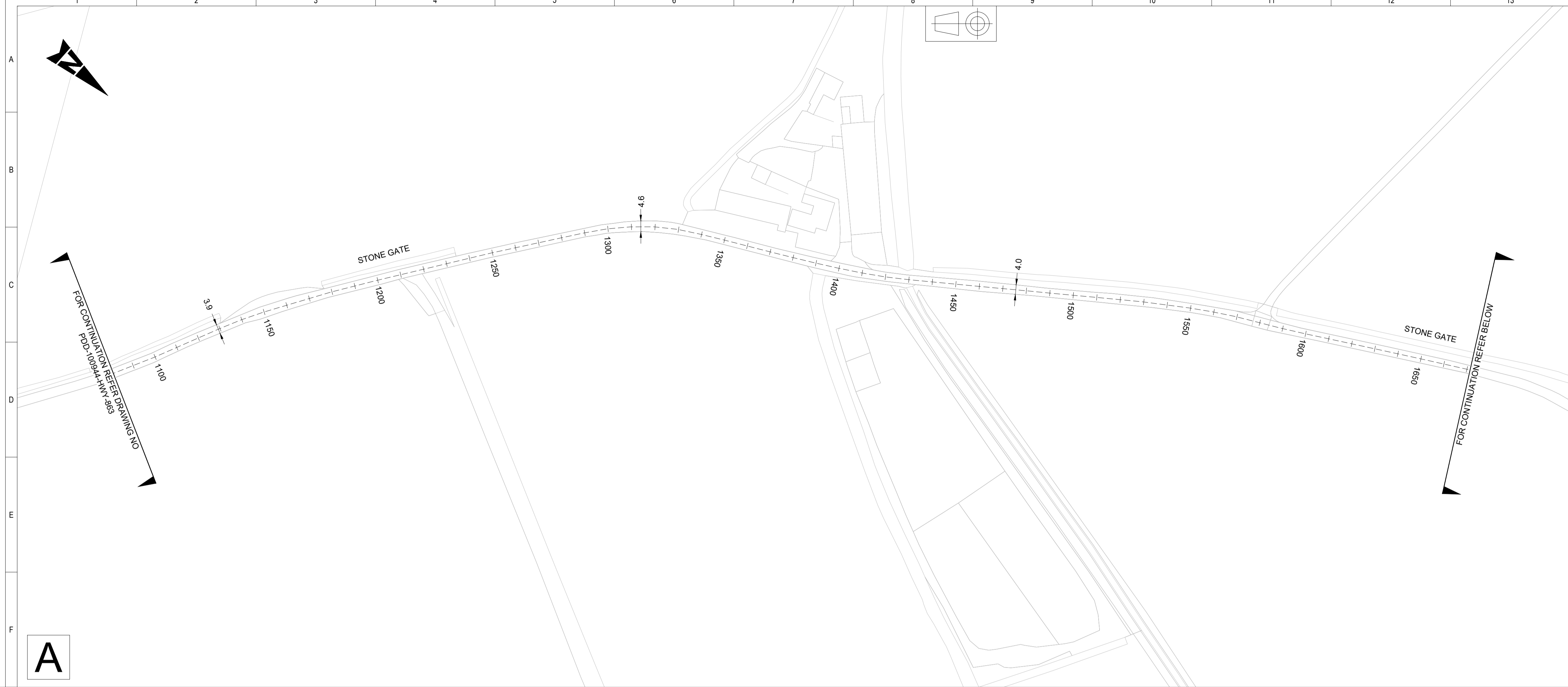

- NOTES:**
1. THIS DRAWING IS FOR INFORMATION ONLY.
 2. ALL MEASUREMENTS ARE IN METERS.
 3. ALL DESIGNS ARE BASED ON ORDINANCE SURVEY AND HAVE BEEN SHOWN INDICATIVELY ONLY AND ARE SUBJECT TO FURTHER ITERATION FOLLOWING THE RECEIPT OF THE TOPOGRAPHICAL SURVEY AT THE NEXT DESIGN STAGE.
 4. THESE DRAWINGS ARE PRODUCED FOR FEASIBILITY STAGE ONLY AND SHOULD NOT BE USED FOR CONSTRUCTION.
 5. VEGETATION CLEARANCE IS REQUIRED TO MAINTAIN UNOBSTRUCTED VISIBILITY SPLAYS.

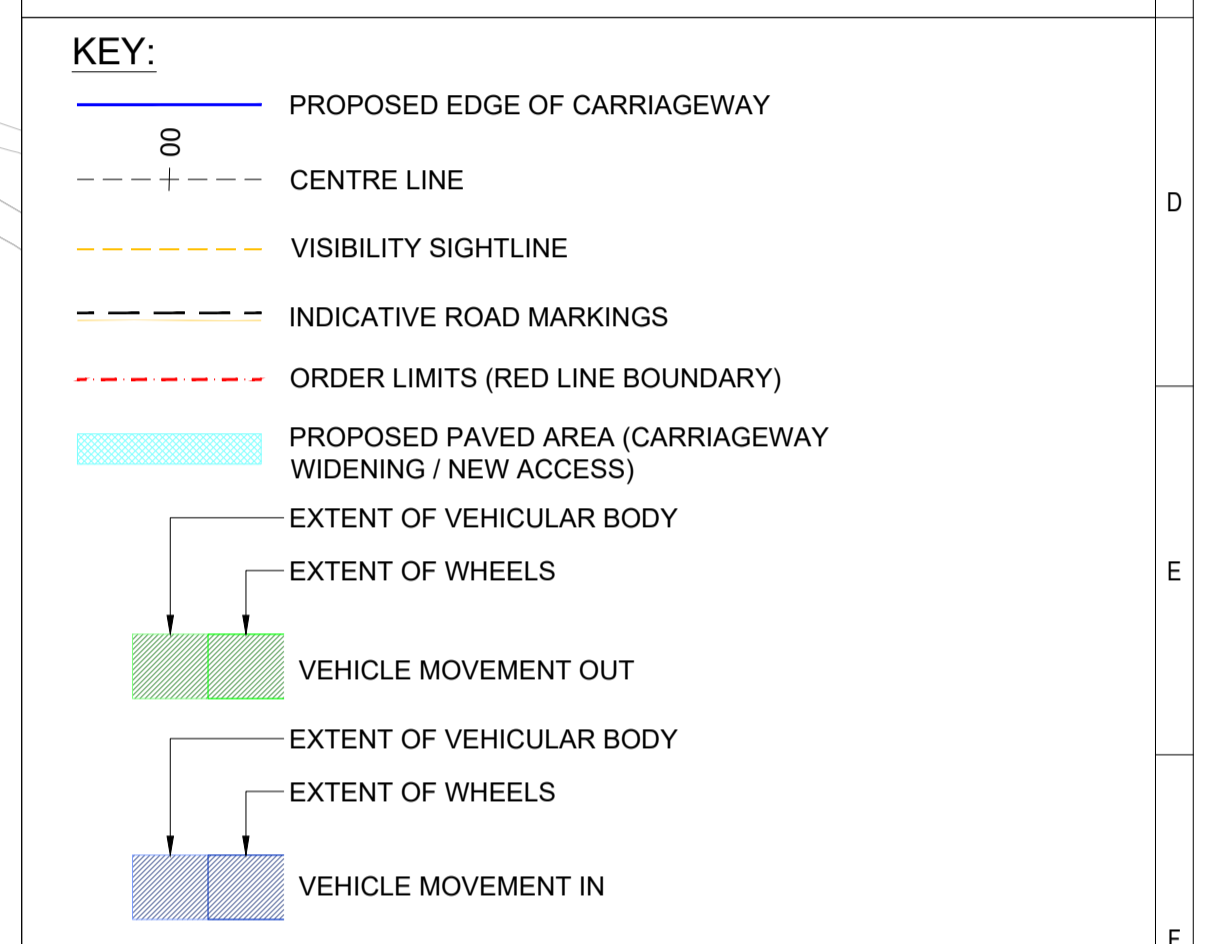

VEHICLE DETAILS:

4 WHEEL DRIVE CAR	4.905m
OVERALL LENGTH	2.009m
OVERALL WIDTH	1.873m
OVERALL BODY HEIGHT	0.267m
MIN BODY GROUND CLEARANCE	1.817m
MAX TRACK WIDTH	4.00s
LOCK TO LOCK TIME	5.725m
KERB TO KERB TURNING RADIUS	

This drawing and any information or descriptive matter set out hereon are confidential and copyright property of National Grid and must not be disclosed, loaned, copied or used for any purpose without written permission

Rev.	Date	Comment	Drawn by	Checked	Rev by	Appr.
P01	08/05/2026	FIRST ISSUE	NK	PO	TC	JS
NATIONAL GRID INVESTMENT NUMBER: 100944						

 National Grid plc, Warwick Technology Park, Galloway Hill, Warwick, CV34 6DA.	Site WESTON MARSH SUBSTATION A (400kV-15AIS)	
	Contractor WSP House, 70 Chancery Lane, London, WC2A 1AF, UK T+ 44 (0) 207 314 5500 F+ 44 (0) 207 314 5111 wsp.com	
Title MAINTENANCE VEHICLE TRACKING FOR PERMANENT ACCESS TO WESTON MARSH A 400kv SUBSTATION (SHEET 2 OF 5)		Status S2
Purpose of issue Shared for Information		Revision P01
Contractor Drawing No. PDD-100944-HWY-864		Issue A
Customer Drawing No. -----		Sheet 002 of 005 Size A1
Drawn NK	Checked PD	Reviewed TC
Approved JS	Date 08/05/2026	Scale 1:1000

BACKGROUND MAPPING INFORMATION HAS BEEN REPRODUCED FROM THE ORDINANCE SURVEY BY PERMISSION OF ORDINANCE SURVEY OF THE CONTROLLER OF HIS MAJESTY'S STATIONERY OFFICE. CROWN COPYRIGHT ORDINANCE SURVEY © BLUESKY INTERNATIONAL LTD © NATIONAL GRID ELECTRICITY - 10094411

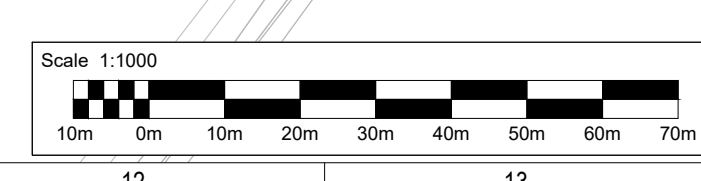

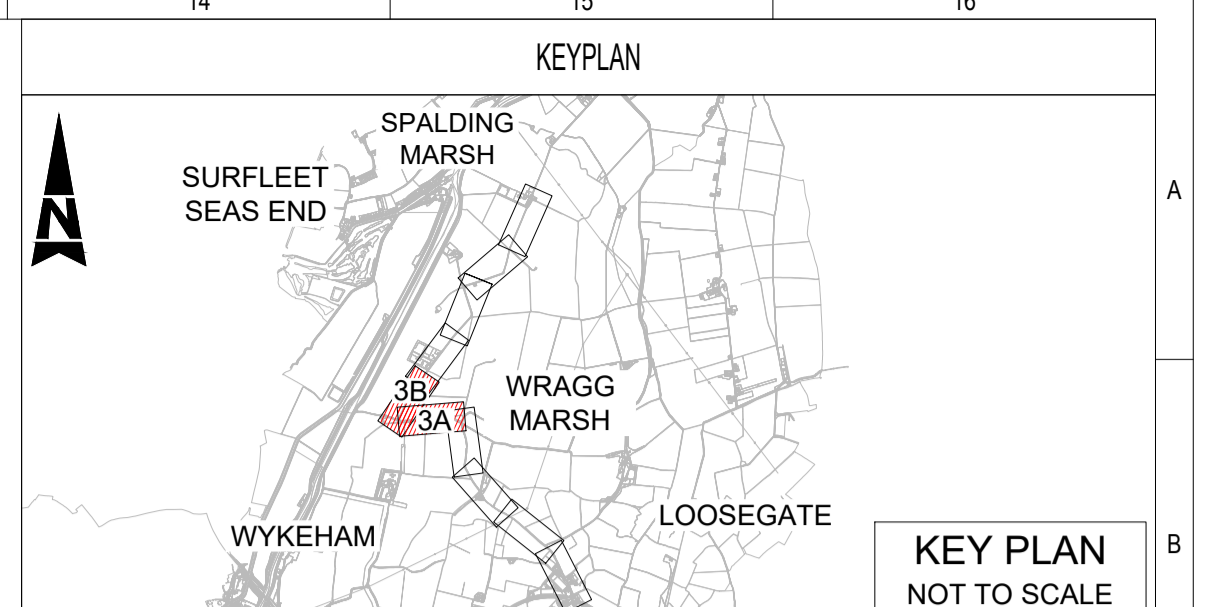
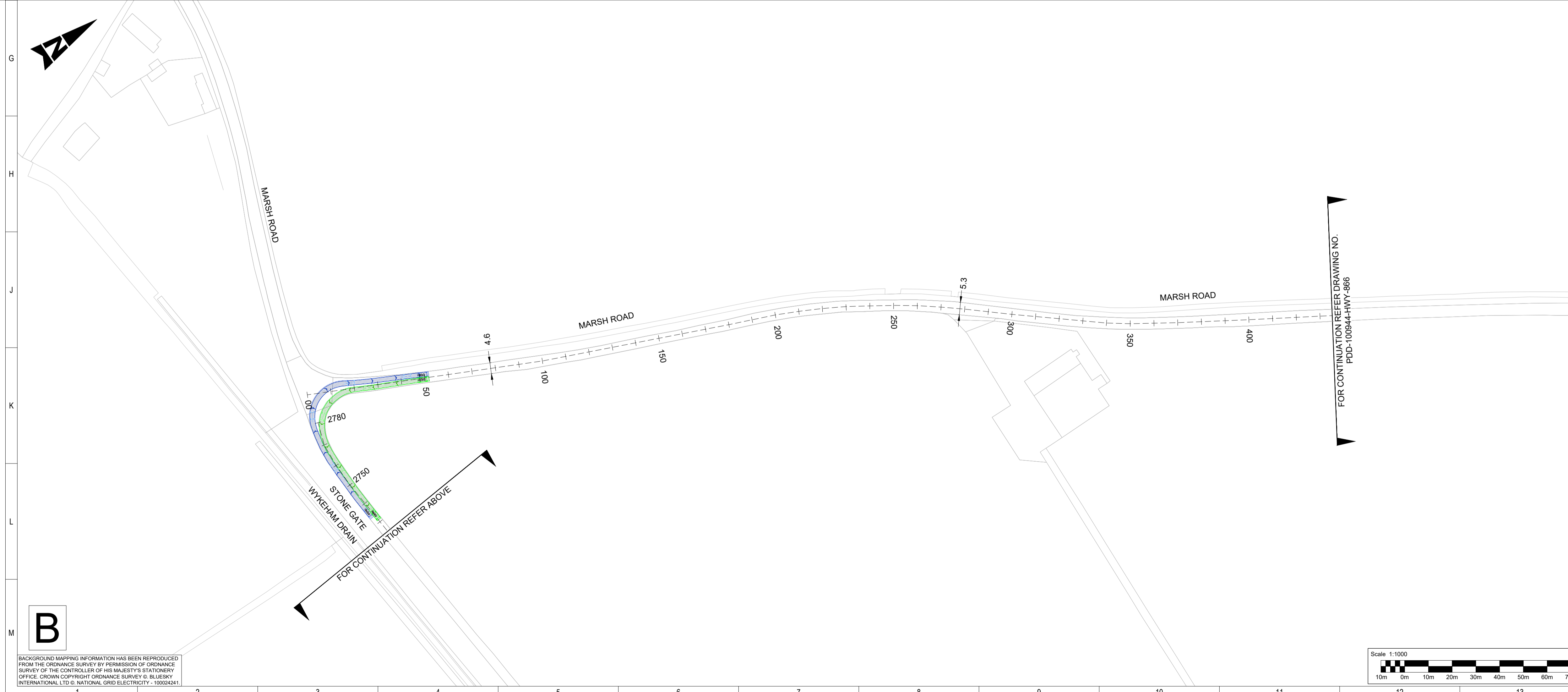
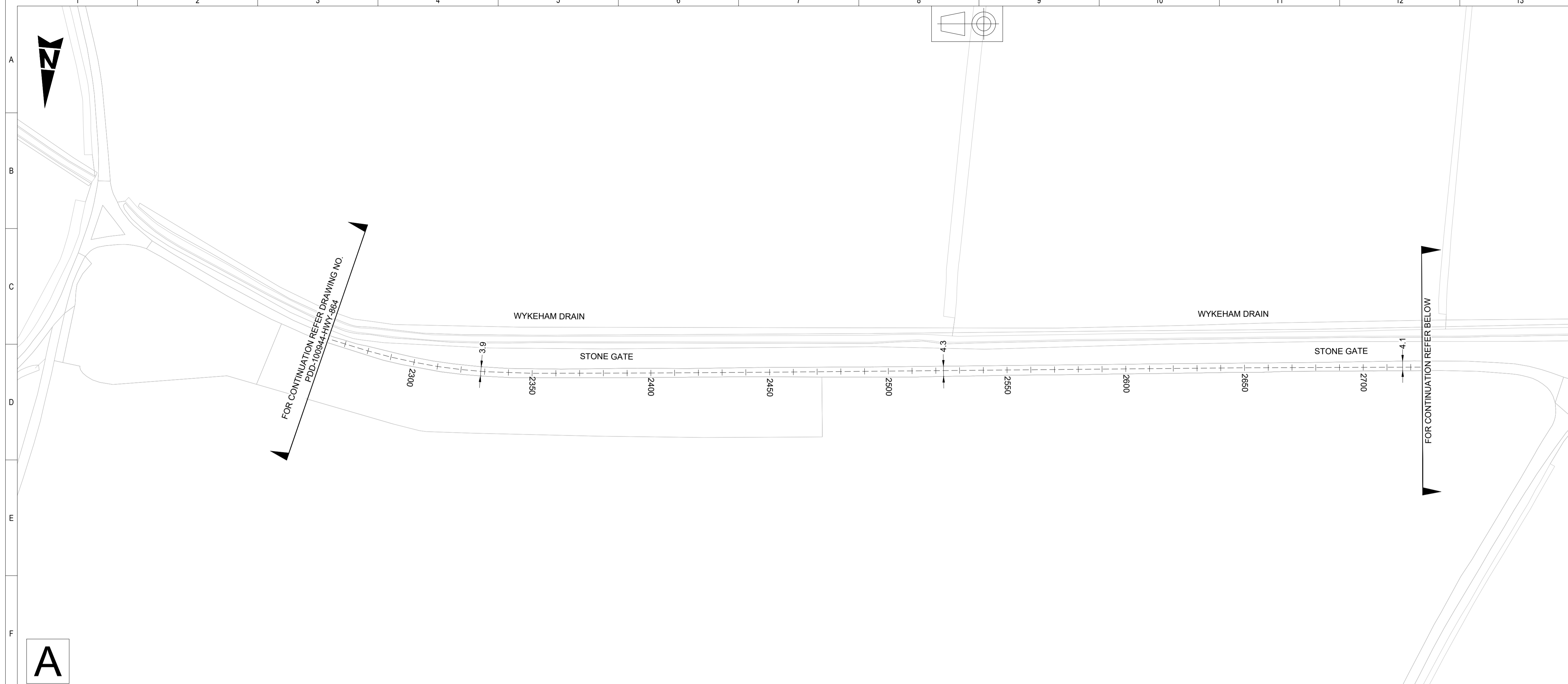

- NOTES:**
1. THIS DRAWING IS FOR INFORMATION ONLY.
 2. ALL MEASUREMENTS ARE IN METERS.
 3. ALL DESIGNS ARE BASED ON ORDINANCE SURVEY AND HAVE BEEN SHOWN INDICATIVELY ONLY AND ARE SUBJECT TO FURTHER ITERATION FOLLOWING THE RECEIPT OF THE TOPOGRAPHICAL SURVEY AT THE NEXT DESIGN STAGE.
 4. THESE DRAWINGS ARE PRODUCED FOR FEASIBILITY STAGE ONLY AND SHOULD NOT BE USED FOR CONSTRUCTION.
 5. VEGETATION CLEARANCE IS REQUIRED TO MAINTAIN UNOBSTRUCTED VISIBILITY SPLAYS.

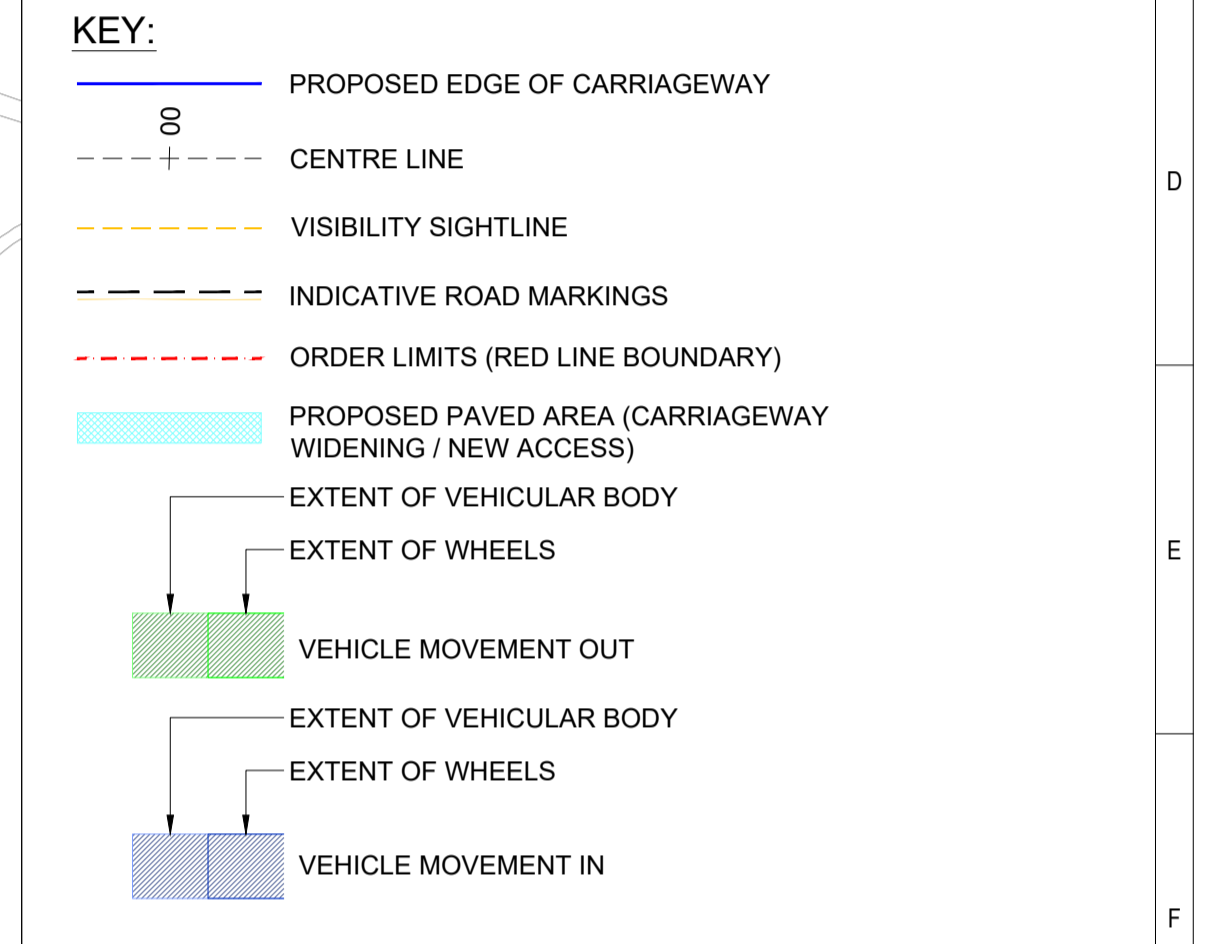

VEHICLE DETAILS:

4 WHEEL DRIVE CAR	
OVERALL LENGTH	4.905m
OVERALL WIDTH	2.009m
OVERALL BODY HEIGHT	1.873m
MIN BODY GROUND CLEARANCE	0.267m
MAX TRACK WIDTH	1.817m
LOCK TO LOCK TIME	4.00s
KERB TO KERB TURNING RADIUS	5.725m

This drawing and any information or descriptive matter set out hereon are confidential and copyright property of National Grid and must not be disclosed, loaned, copied or used for any purpose without written permission

Rev.	Date	Comment	Drawn by	Checked	Rev by	Appr.
P01	08/05/2026	FIRST ISSUE	NK	PO	TC	JS

NATIONAL GRID INVESTMENT NUMBER: 100944

nationalgrid
National Grid plc, Warwick Technology Park, Galloway Hill, Warwick, CV34 6DA.

Contractor
wsp
WSP House, 70 Chancery Lane, London, WC2A 1AF, UK
T: +44 (0) 207 314 5500
F: +44 (0) 207 314 5111
wsp.com

Site
WESTON MARSH SUBSTATION A (400KV-15AIS)

Title
MAINTENANCE VEHICLE TRACKING FOR PERMANENT ACCESS TO WESTON MARSH A 400KV SUBSTATION (SHEET 3 OF 5)

Purpose of issue
Shared for Information

Status
S2

Contractor Drawing No.
PDD-100944-HWY-865

Revision
P01

Customer Drawing No.

Sheet 003 of 005

Issue A

Drawn NK

Checked PD

Reviewed TC

Approved JS

Date 08/05/2026

Scale 1:1000

Size A1

BACKGROUND MAPPING INFORMATION HAS BEEN REPRODUCED FROM THE ORDINANCE SURVEY BY PERMISSION OF ORDINANCE SURVEY OF THE CONTROLLER OF HIS MAJESTY'S STATIONERY OFFICE. CROWN COPYRIGHT ORDINANCE SURVEY © BLUESKY INTERNATIONAL LTD © NATIONAL GRID ELECTRICITY - 10094441

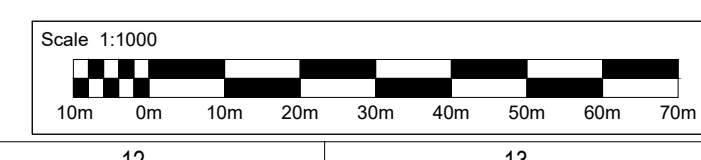

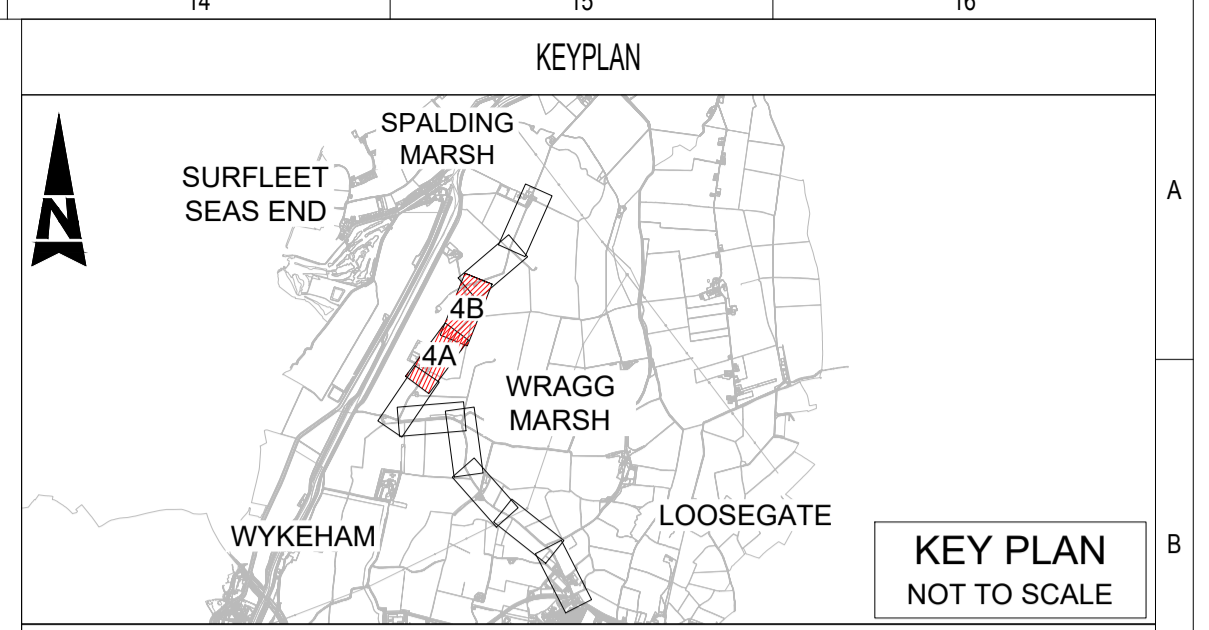
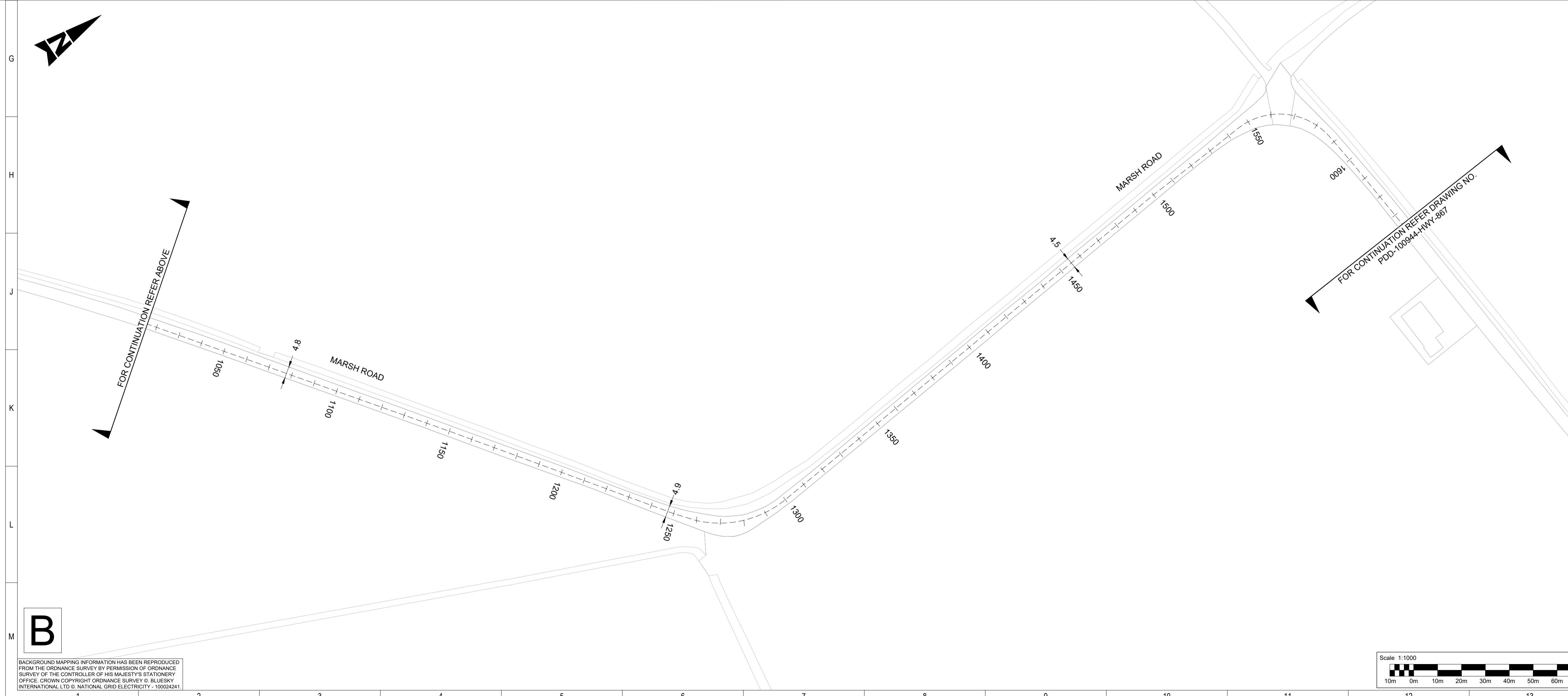

- NOTES:**
1. THIS DRAWING IS FOR INFORMATION ONLY.
 2. ALL MEASUREMENTS ARE IN METERS.
 3. ALL DESIGNS ARE BASED ON ORDINANCE SURVEY AND HAVE BEEN SHOWN INDICATIVELY ONLY AND ARE SUBJECT TO FURTHER ITERATION FOLLOWING THE RECEIPT OF THE TOPOGRAPHICAL SURVEY AT THE NEXT DESIGN STAGE.
 4. THESE DRAWINGS ARE PRODUCED FOR FEASIBILITY STAGE ONLY AND SHOULD NOT BE USED FOR CONSTRUCTION.
 5. VEGETATION CLEARANCE IS REQUIRED TO MAINTAIN UNOBSTRUCTED VISIBILITY SPLAYS.

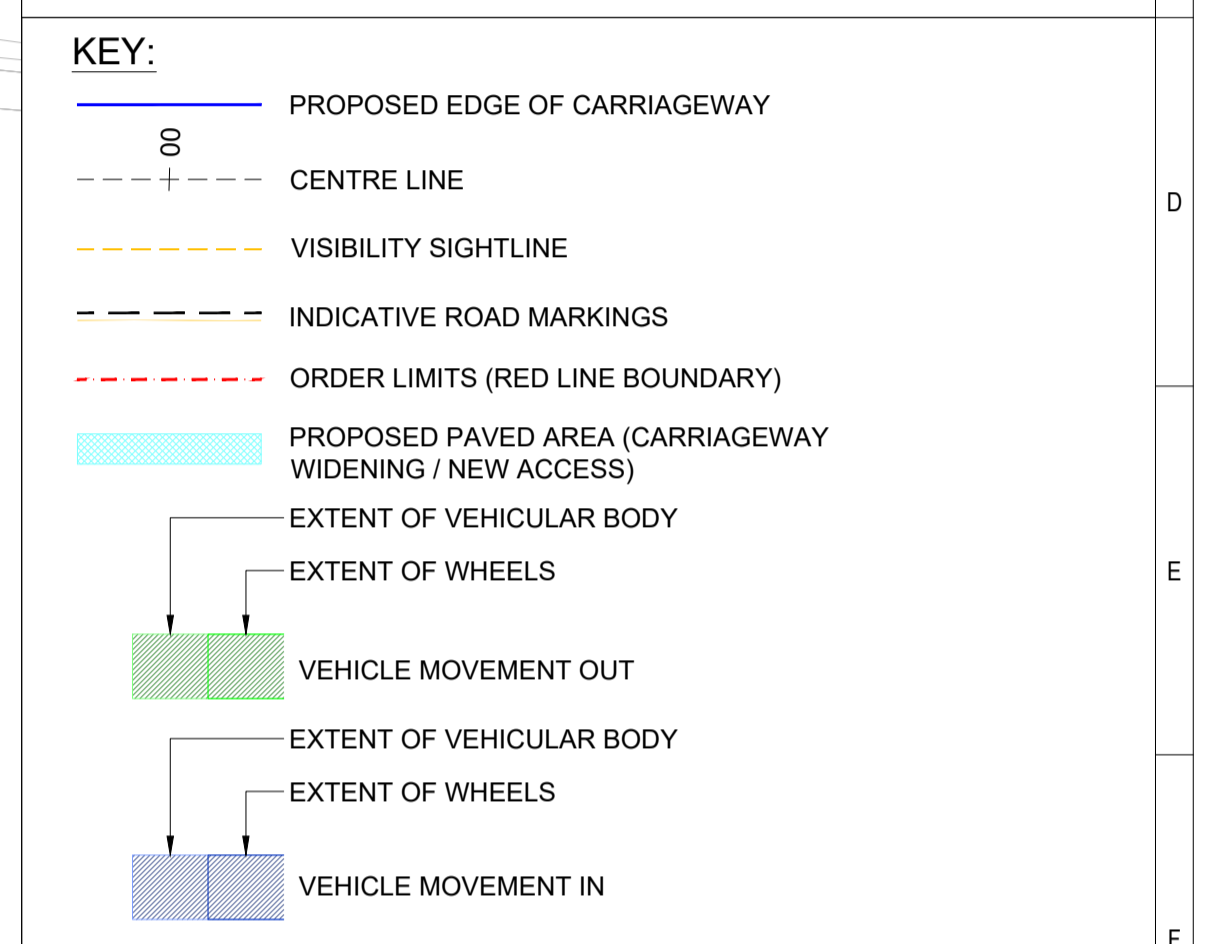

VEHICLE DETAILS:

4 WHEEL DRIVE CAR	4.905m
OVERALL LENGTH	2.009m
OVERALL WIDTH	1.873m
OVERALL BODY HEIGHT	0.267m
MIN BODY GROUND CLEARANCE	1.817m
MAX TRACK WIDTH	4.00s
LOCK TO LOCK TIME	5.725m
KERB TO KERB TURNING RADIUS	

This drawing and any information or descriptive matter set out hereon are confidential and copyright property of National Grid and must not be disclosed, loaned, copied or used for any purpose without written permission

Rev.	Date	Comment	Drawn by	Checked	Rev by	Appr.
P01	08/05/2026	FIRST ISSUE	NK	PO	TC	JS

NATIONAL GRID INVESTMENT NUMBER: 100944

<p>National Grid plc, Warwick Technology Park, Galloway Hill, Warwick, CV34 6DA.</p>	<p>Site WESTON MARSH SUBSTATION A (400KV-15AIS)</p>	
	<p>Contractor <p>WSP House, 70 Chancery Lane, London, WC2A 1AF, UK T: +44 (0) 207 314 5500 F: +44 (0) 207 314 5111 wsp.com</p> </p>	
<p>Title MAINTENANCE VEHICLE TRACKING FOR PERMANENT ACCESS TO WESTON MARSH A 400kv SUBSTATION (SHEET 4 OF 5)</p>		<p>Status S2</p>
<p>Purpose of issue Shared for Information</p>		<p>Revision P01</p>
<p>Contractor Drawing No. PDD-100944-HWY-866</p>		<p>Issue A</p>
<p>Customer Drawing No. ----</p>		<p>Sheet 004 of 005</p>
<p>Drawn NK</p>	<p>Checked PD</p>	<p>Reviewed TC</p>
<p>Approved JS</p>	<p>Date 08/05/2026</p>	<p>Scale 1:1000</p>
<p>Size A1</p>		

BACKGROUND MAPPING INFORMATION HAS BEEN REPRODUCED FROM THE ORDINANCE SURVEY BY PERMISSION OF ORDINANCE SURVEY OF THE CONTROLLER OF HIS MAJESTY'S STATIONERY OFFICE. CROWN COPYRIGHT ORDINANCE SURVEY © BLUESKY INTERNATIONAL LTD © NATIONAL GRID ELECTRICITY - 10094411

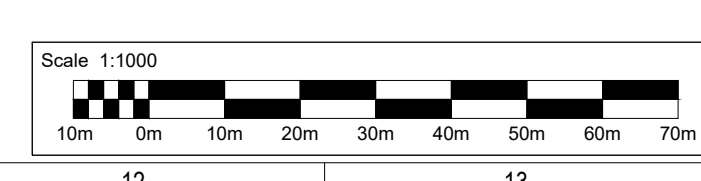

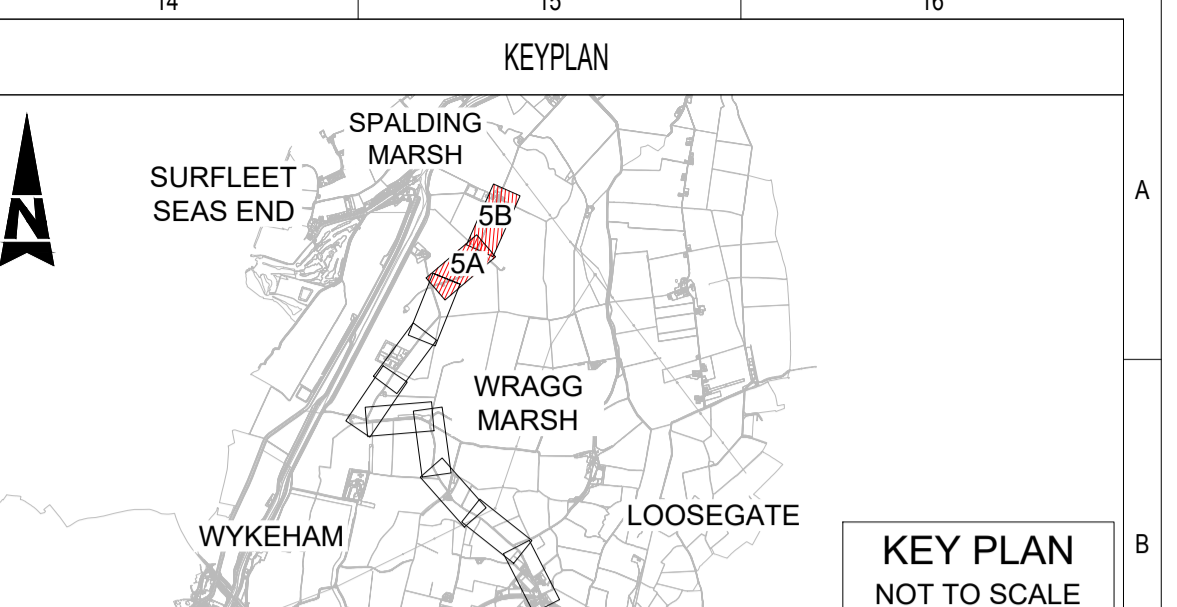
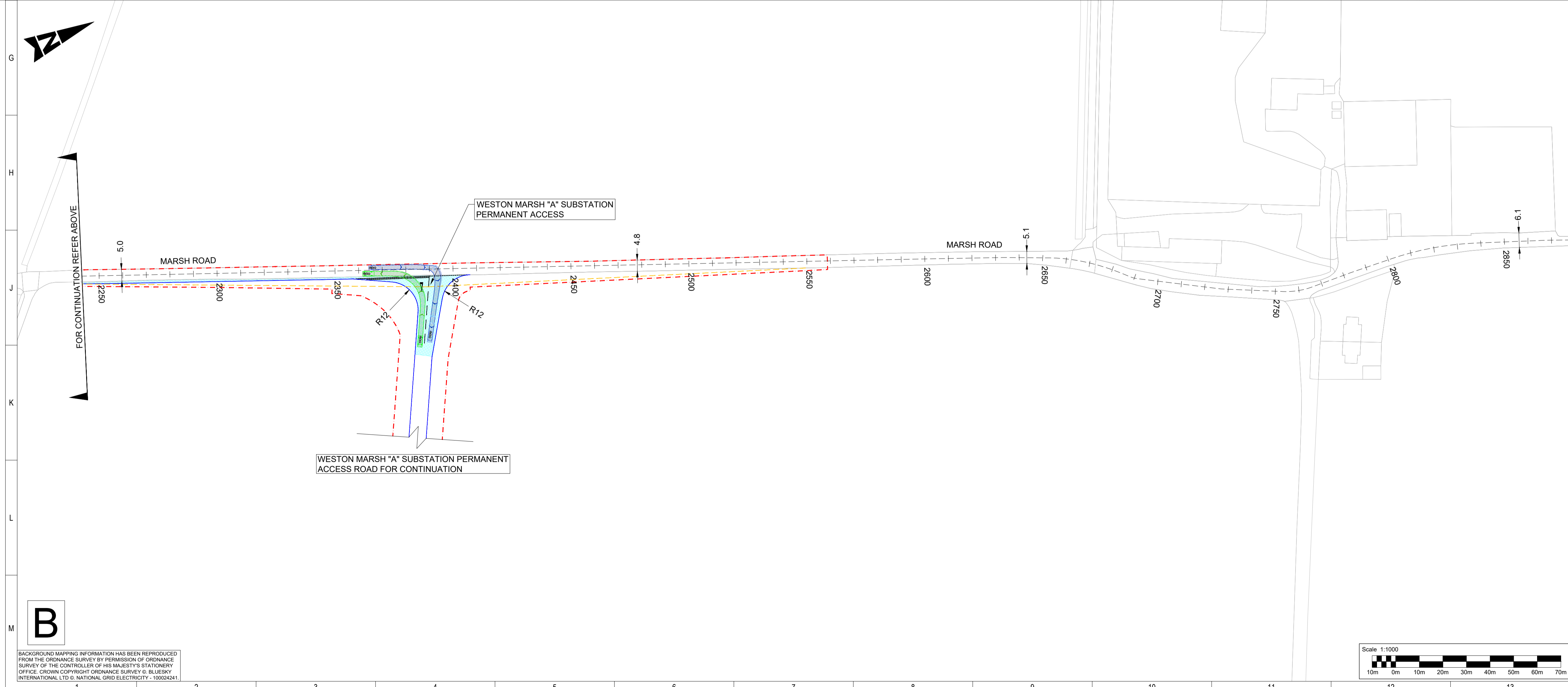
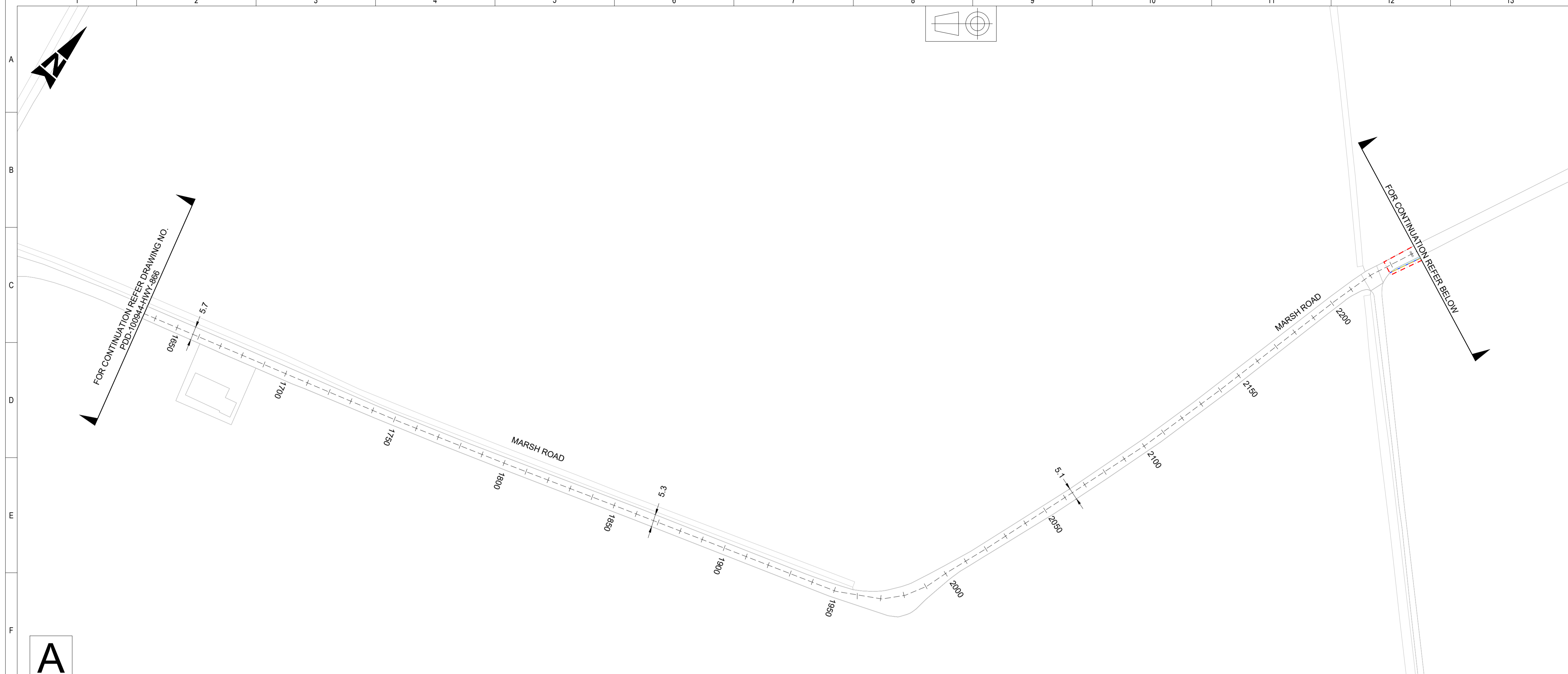

- NOTES:**
1. THIS DRAWING IS FOR INFORMATION ONLY.
 2. ALL MEASUREMENTS ARE IN METERS.
 3. ALL DESIGNS ARE BASED ON ORDINANCE SURVEY AND HAVE BEEN SHOWN INDICATIVELY ONLY AND ARE SUBJECT TO FURTHER ITERATION FOLLOWING THE RECEIPT OF THE TOPOGRAPHICAL SURVEY AT THE NEXT DESIGN STAGE.
 4. THESE DRAWINGS ARE PRODUCED FOR FEASIBILITY STAGE ONLY AND SHOULD NOT BE USED FOR CONSTRUCTION.
 5. VEGETATION CLEARANCE IS REQUIRED TO MAINTAIN UNOBSTRUCTED VISIBILITY SPLAYS.

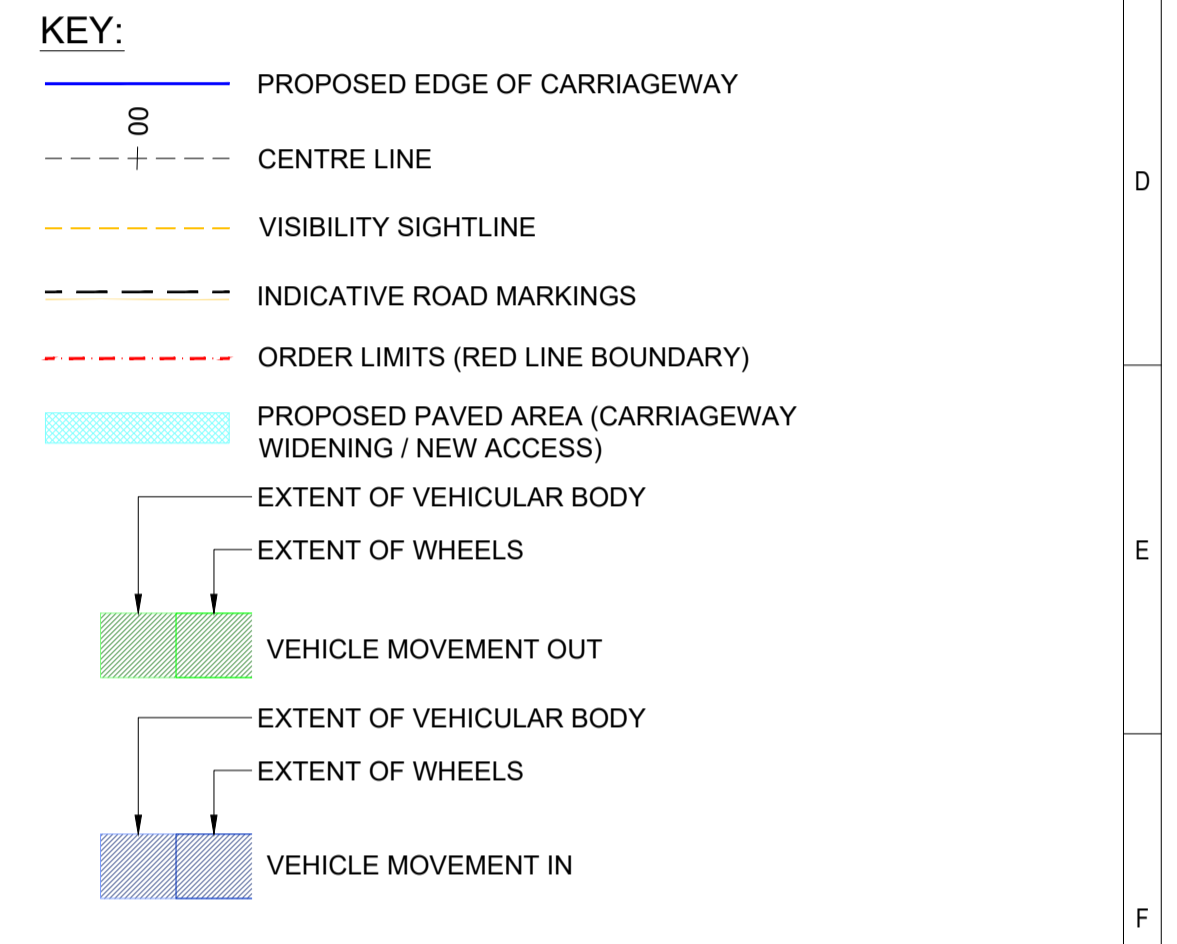

VEHICLE DETAILS:

4 WHEEL DRIVE CAR	
OVERALL LENGTH	4.905m
OVERALL WIDTH	2.009m
OVERALL BODY HEIGHT	1.873m
MIN BODY GROUND CLEARANCE	0.267m
MAX TRACK WIDTH	1.817m
LOCK TO LOCK TIME	4.00s
KERB TO KERB TURNING RADIUS	5.725m

This drawing and any information or descriptive matter set out hereon are confidential and copyright property of National Grid and must not be disclosed, loaned, copied or used for any purpose without written permission

P01	08/05/2026	FIRST ISSUE	NK	PO	TC	JS
Rev.	Date	Comment	Drawn by	Checked	Rev by	Appr.
NATIONAL GRID INVESTMENT NUMBER: 100944						

 National Grid plc, Warwick Technology Park, Galloway Hill, Warwick, CV34 6DA	Site WESTON MARSH SUBSTATION A (400kV-15AIS)	
	Contractor WSP House, 70 Chancery Lane, London, WC2A 1AF, UK T: +44 (0) 207 314 5500 F: +44 (0) 207 314 5111 wsp.com	
Title MAINTENANCE VEHICLE TRACKING FOR PERMANENT ACCESS TO WESTON MARSH A 400kV SUBSTATION (SHEET 5 OF 5)		Status S2
Purpose of issue Shared for Information		Revision P01
Contractor Drawing No. PDD-100944-HWY-867		Issue A
Customer Drawing No. -----		Sheet 005 of 005 Size A1
Drawn	Checked	Reviewed
NK	PD	TC
Approved	Date	Scale
JS	08/05/2026	1:1000

BACKGROUND MAPPING INFORMATION HAS BEEN REPRODUCED FROM THE ORDINANCE SURVEY BY PERMISSION OF ORDINANCE SURVEY OF THE CONTROLLER OF HIS MAJESTY'S STATIONERY OFFICE. CROWN COPYRIGHT ORDINANCE SURVEY © BLUESKY INTERNATIONAL LTD © NATIONAL GRID ELECTRICITY - 10094441

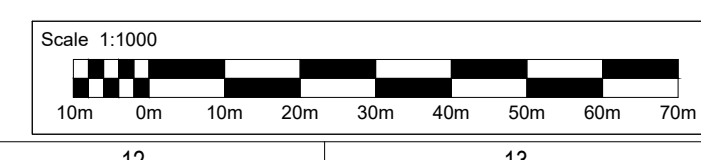

National Grid plc
National Grid House,
Warwick Technology Park,
Gallows Hill, Warwick.
CV34 6DA United Kingdom

Registered in England and Wales
No. 4031152
nationalgrid.com