

Our Stage 1 consultation

Feedback form

June 2026

We are consulting on proposals to build a new primarily offshore, with associated onshore infrastructure, High Voltage Direct Current (HVDC) electricity link between Scotland and Wales. This is our Stage 1 consultation on our early proposals for Western Link 2.

We are seeking feedback from local communities, their representatives and key stakeholders, early in the project development process, to ensure that feedback and local knowledge influence our plans as they continue to be developed.

We want to work closely with local communities, key stakeholders and technical experts to better understand the area around the project. This will help us to understand the best ways to reduce impacts and maximise benefits for local communities.

Following this consultation, we will carefully consider all of the feedback received. This feedback, alongside technical assessments and environmental surveys, will help us refine our proposals. We will then hold a second, statutory Stage 2 consultation, where we will present our more developed proposals for Western Link 2. This Stage 2 consultation will be undertaken prior to making a planning application for the project.

We appreciate you taking the time to complete this feedback form.

This Stage 1 consultation is open between
**12.00pm Tuesday
23 June and 11:59 pm
Tuesday 21 July 2026.**



During this Stage 1 consultation, we are seeking your views on our emerging design for the project and what you would like us to consider as we further develop our proposals.

Our proposals

The project is being jointly developed by National Grid Electricity Transmission (National Grid) and Scottish Power Energy Networks (SP Energy Networks) with each company leading on different elements of the project.

National Grid's proposals include the following principal elements:

- Approximately 195 km of offshore HVDC cable, which extends from the northern limit of the Welsh nearshore area up to the southern limit of Scottish territorial seas
- approximately 65 km of new nearshore HVDC cable, which extends 12 nautical miles from the Welsh coast, to a new underground transition joint bay at a landfall location on the Gwynedd coastline, at Caernarfon Bay
- a new underground transition joint bay at a location on the Gwynedd coastline, at Caernarfon Bay, where the new offshore HVDC cable will connect to the new onshore HVDC cable
- three options for potential landfall locations on the Gwynedd coastline (with one emerging preferred option identified)
- a new underground HVDC cable route of approximately 25 km from a landfall location on the Gwynedd coastline to a new converter station (presented as a 'graduated swathe' with the darker shaded area showing our preferred emerging cable route)

- two siting zone options for a new converter station in close proximity to the existing Pentir substation (with an emerging preference for Pentir East siting zone), including a new short length of underground HVAC cable connection from the converter station to the existing Pentir substation
- an extension to the existing Pentir substation, for the purposes of connecting Western Link 2 to the existing transmission network in Wales.



In this consultation we are asking for your views on the Welsh onshore, nearshore and offshore elements of the project only. SP Energy Networks is responsible for the Scottish elements of the project, and the proposed route they identified was subject to consultation in November 2025.

Further information

As part of this consultation, we have published the following consultation materials. We encourage you to provide feedback after reviewing our consultation materials;



Stage 1 consultation document:

outlining our proposals and the background to those proposals, along with information about where to find out more and how to get involved in the consultation.



Community newsletter: summarising details of the Western Link 2 project and our public consultation.



Consultation strategy:

outlining our approach to this Stage 1 consultation.

As part of this consultation, we have also published the following supporting technical materials;



Strategic Options Report (SOR):

explaining the need case for the project, the strategic options considered, and the strategic option proposed, as the basis for the further development of the project.



Terrestrial Corridor Preliminary Routing and Siting Study report (TCPRSS):

providing detailed information on the elements of Western Link 2 including the options appraisal approach, the routing and siting options assessed, and our proposed options. This is supported by a summary explaining the project changes from CPRSS drafting to the information presented at this consultation.



Marine Corridor Preliminary Routing and Siting Study report (MCPRSS):

providing detailed information on the components of Western Link 2 including the options appraisal approach, the routing and siting options assessed, and our proposed options. This is supported by a summary explaining the project changes from CPRSS drafting to the information presented at this consultation.



Bridging notes for the MCPRSS and TCPRSS documents:

providing further information on the development of routing and siting options.



Summary of Landfall and Terrestrial routing and siting options:

providing a summary of the routing and siting options.

All consultation materials are published on the project website: nationalgrid.com/westernlink2

Printed copies of all documents listed above will be available to view at our in-person information events.

Key consultation documents will also be available to view at local information points.

Details can be found on the project website, in our Stage 1 consultation document, our community newsletter and our Stage 1 consultation strategy.

If you would like paper copies of the consultation documents or need them in another format, please get in touch through one of the channels listed on page 26. (Please note print charges may apply).

How to provide feedback

Please submit your response to this consultation by **11:59pm on Tuesday 21 July 2026**. We cannot guarantee that responses received after this time will be considered.

You are welcome to answer all or only some of the questions in this feedback form. It is not necessary to complete all of the questions if you do not wish to do so.

Local knowledge plays an important part in the development of our proposals. We want to work with local communities, their representatives and key stakeholders to fully understand the areas around the project. This will help ensure we can minimise the impact as far as possible and maximise the benefits for local communities.

Your feedback will play an important part in shaping our plans. Following this Stage 1 consultation, we will review the feedback received and alongside technical assessments and environmental surveys, it will help refine our proposals. We will then hold a second, Stage 2 consultation in 2027, where we will present our more developed proposals for Western Link 2. This Stage 2 consultation will be undertaken prior to making a planning application for the project.

Feedback forms and consultation packs are available in Welsh and English.

You can submit your feedback in the following ways:



In person: hand it to a member of the team or place in the feedback form box at one of our in-person information events. More information about our in-person information events can be found at nationalgrid.com/westernlink2



Post: send a copy of your completed form to our Freepost address **FREEPOST W LINK 2**

All responses to the consultation must be received before the consultation closes. Postal responses will be accepted until a week after the consultation closes if they are posted within the consultation period.



Email: send a copy of your completed form to westernlink2@nationalgrid.com



Online Feedback Form: complete our online feedback form on our project website: nationalgrid.com/westernlink2

You are welcome to provide feedback in Welsh or English.

If you are unable to provide feedback online, via email or by post, or have any questions about providing feedback, please contact us by phone on **0800 156 0706**.

Presenting our proposals

To help you provide feedback, we have produced a series of maps which show:

Emerging preferred corridor

The emerging preferred corridor is an area within which infrastructure for Western Link 2 could be located. Within the corridor we have used a graduated swathe to show where infrastructure is more or less likely to be located.

Graduated swathe

A graduated swathe shows a broad area within which our infrastructure **could** be located rather than showing a single fixed route or site.

The graduated swathe is not a final design. It is early, indicative and broad, and will be refined as we carry out further technical and environmental assessments, surveys, and as we consider feedback from communities and key stakeholders.

The shading shows how likely it is that infrastructure such as landfall locations, cable routes and converter station sites would be located in different parts of that area, based on the work we have done so far.

1. Darker shading shows areas where the infrastructure is more likely to be located
2. Lighter shading shows areas where it is less likely to be located

We will not need all of the area shaded for Western Link 2.

Siting zones

A siting zone is a large area of land within the study area where the converter station and supporting infrastructure could be located.

Feedback form structure

We have divided our proposals into sections to make it easier to review and provide feedback.

Each section of the feedback form includes a description of the infrastructure we are proposing in the area and a map of the proposal.



Route section 1:

Caernarfon Bay – Landfall location



Route section 2:

Caernarfon Bay to Bontnewydd – cable route



Route section 3:

Bontnewydd to Pentir – cable route



Route section 4:

Pentir – Converter station siting zones and existing Pentir sub-station extension zone



We have also included questions on our nearshore and offshore proposals which can be found on pages 9 and 10.



Sources: Map data © OpenStreetMap contributors, Microsoft, Esri Community Maps contributors, Map layer by Esri

Route section 1: Caernarfon Bay – Landfall location

Route section 1 is focused on landfall; this is the point where the offshore HVDC cables connect to the underground HVDC cables on land.

This connection would be made through a transition joint bay (TJB), a permanent underground structure or chamber where the two cables are joined (jointed) together.

Following an initial feasibility assessment, which included a range of offshore and onshore, engineering and environmental considerations, we are seeking views on three potential landfall locations.

Our initial feasibility assessment suggests that Landfall Location B is currently the emerging preferred option.

Landfall Location A is also being considered as a potential alternative option and would be progressed if further offshore and engineering work shows that Landfall Location B is no longer feasible.

Landfall Location C is considered technically feasible but is less preferred than Landfall Locations A and B when assessed against onshore, engineering and environmental considerations.

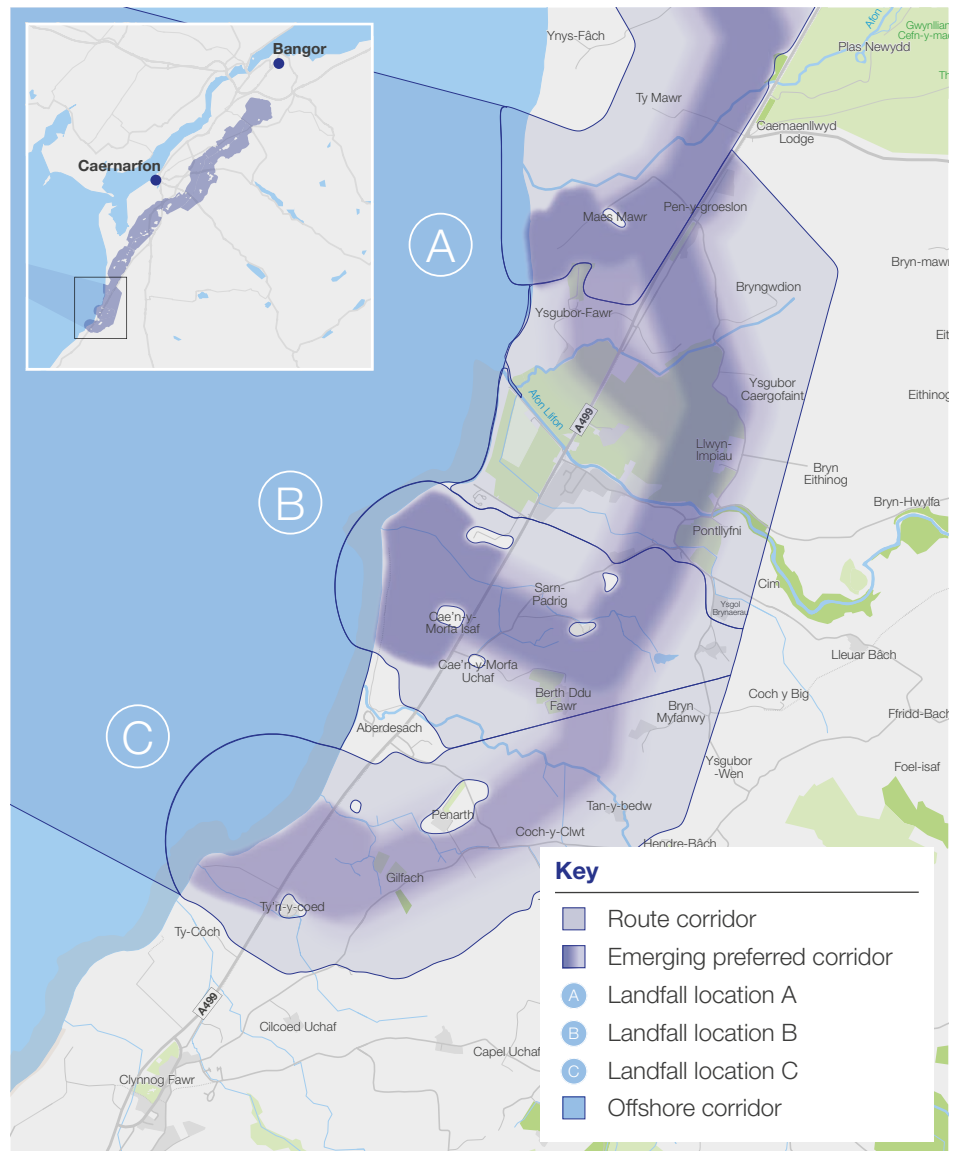



More information on each Landfall Location is available in the Stage 1 consultation document and in the supporting technical documents.

You can view these documents at nationalgrid.com/westernlink2, at our in-person information events or at local information points.

Sources: Map data © OpenStreetMap contributors, Microsoft, Esri Community Maps contributors, Map layer by Esri

Route section 1: Caernarfon Bay – Landfall location

Q1. Do you have any comments on route section 1, including the points listed below?

- Your local knowledge of this part of the Gwynedd coastline.
- Your view on the most appropriate landfall location.
- Local features that are important to you and which could be affected.
- Access or environmental challenges and/or considerations.
- Potential construction activity impact.
- Anything else we should consider as we further develop our proposals.

Route section 2: Caernarfon Bay to Bontnewydd – cable route

This section of the route covers the first half of our emerging preferred corridor which runs from the three identified landfall locations to Bontnewydd.

In this area we are proposing an underground HVDC cable route.

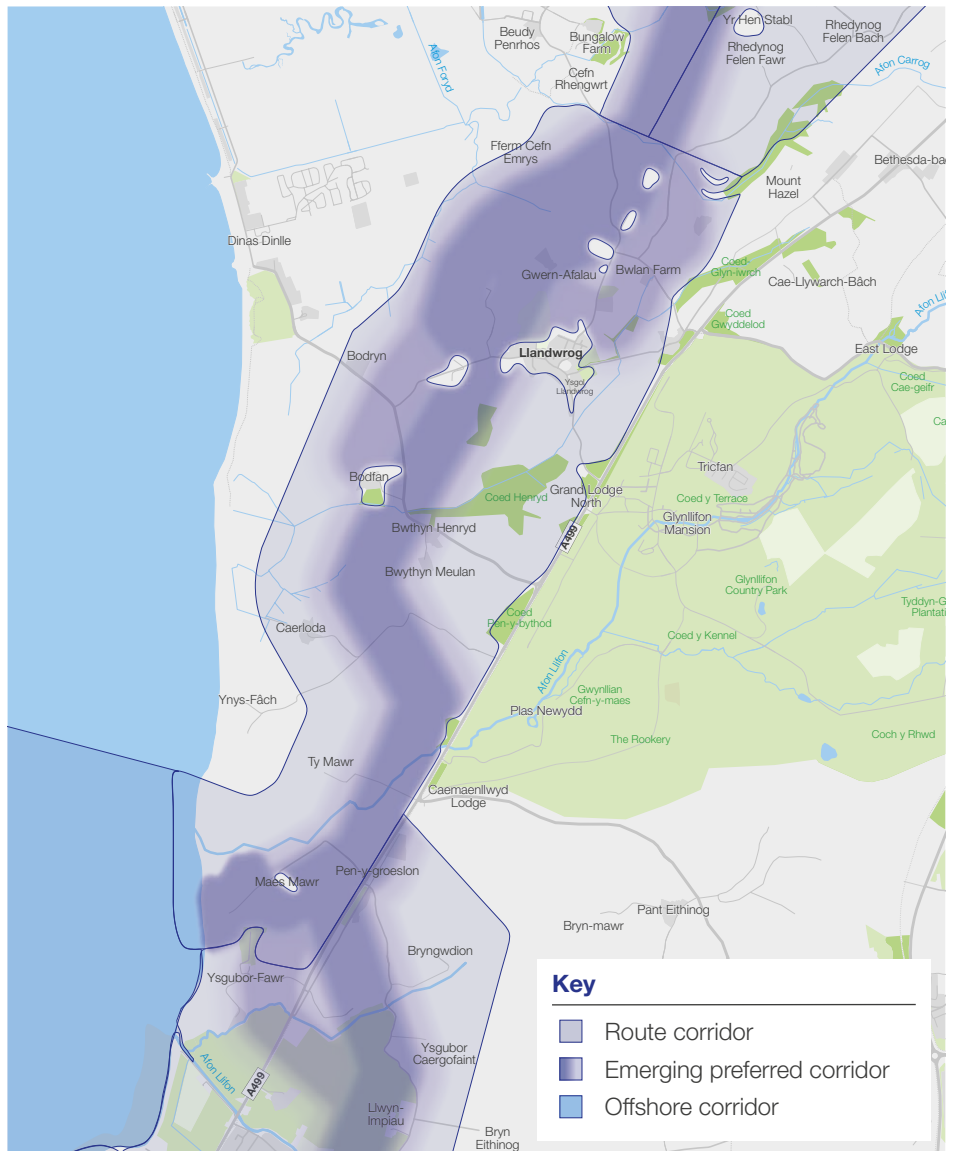
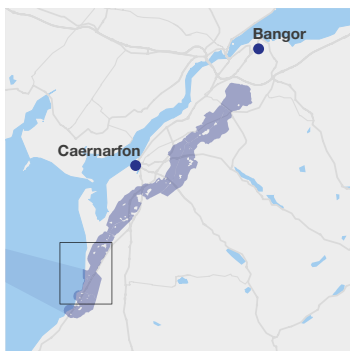

Sources: Map data © OpenStreetMap contributors, Microsoft, Esri Community Maps contributors, Map layer by Esri

Route section 2: Caernarfon Bay to Bontnewydd – cable route

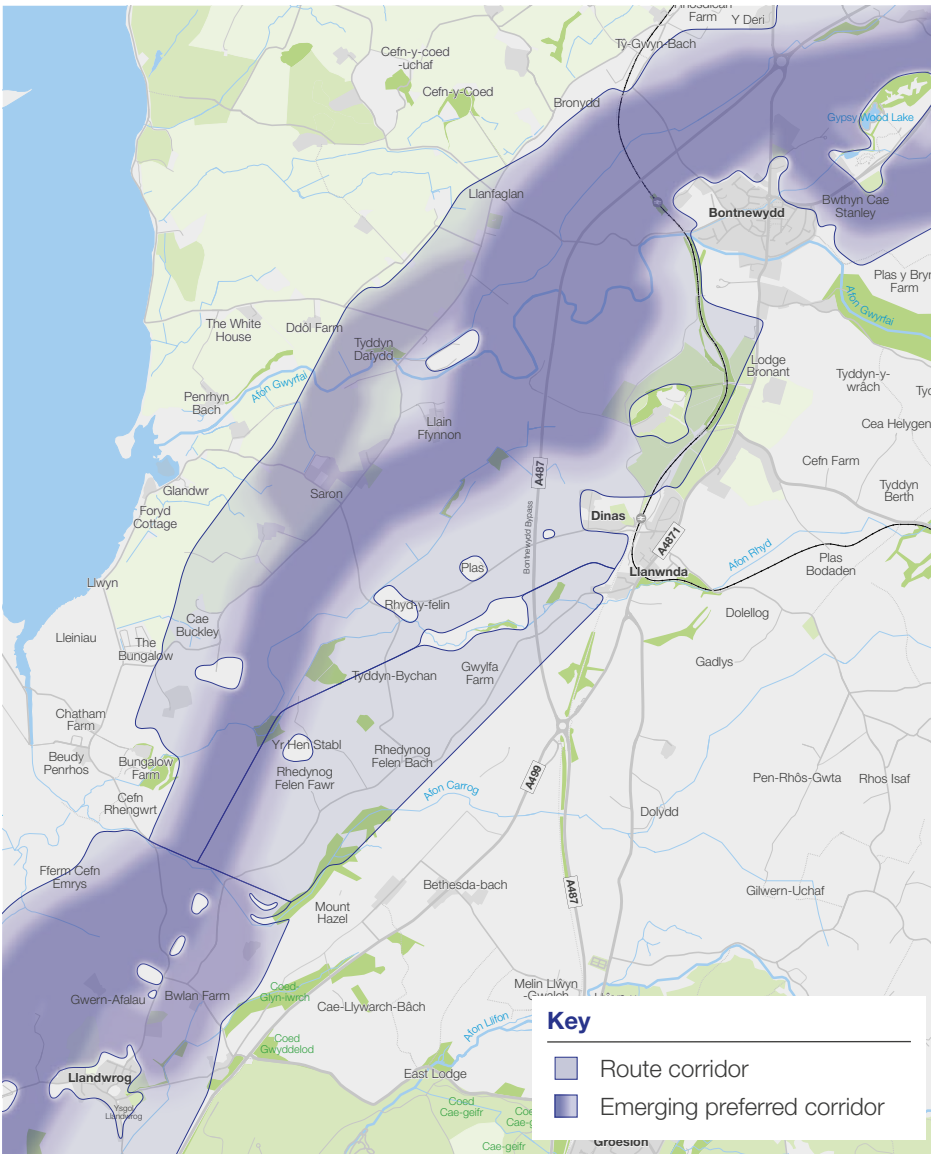

Sources: Map data © OpenStreetMap contributors, Microsoft, Esri Community Maps contributors, Map layer by Esri



Please refer to the Stage 1 consultation document and supporting technical documents for more information on our proposals in this route section, including how we selected the emerging preferred cable route corridor(s).

You can view these documents at nationalgrid.com/westernlink2 at our in-person information events or at local information points.

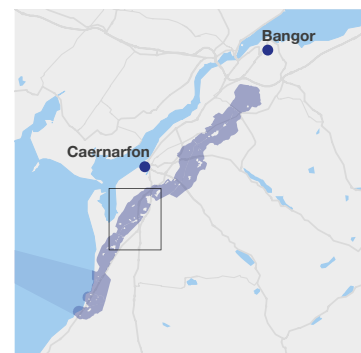

Route section 2: Caernarfon Bay to Bontnewydd – cable route

Q2. Do you have any comments on route section 2, including the points listed below?

- Our emerging preferred cable route corridor(s).
- How we have arrived at these corridor(s).
- Our graduated swathe detailing the cable route options
- Your local knowledge on the most appropriate route within the cable corridor(s) to locate the new underground cable.
- Local features and impacts that are important to you.
- Access or environmental considerations.
- Potential construction activity impact.
- Anything else we should consider as we develop our proposals further.

Route section 3: Bontnewydd to Pentir – cable route

This section of the emerging preferred corridor begins at Bontnewydd and runs north-east passing Caernarfon and Bethel and ending at the existing 400 kV substation at Pentir.

In this area we are proposing an underground HVDC cable route.

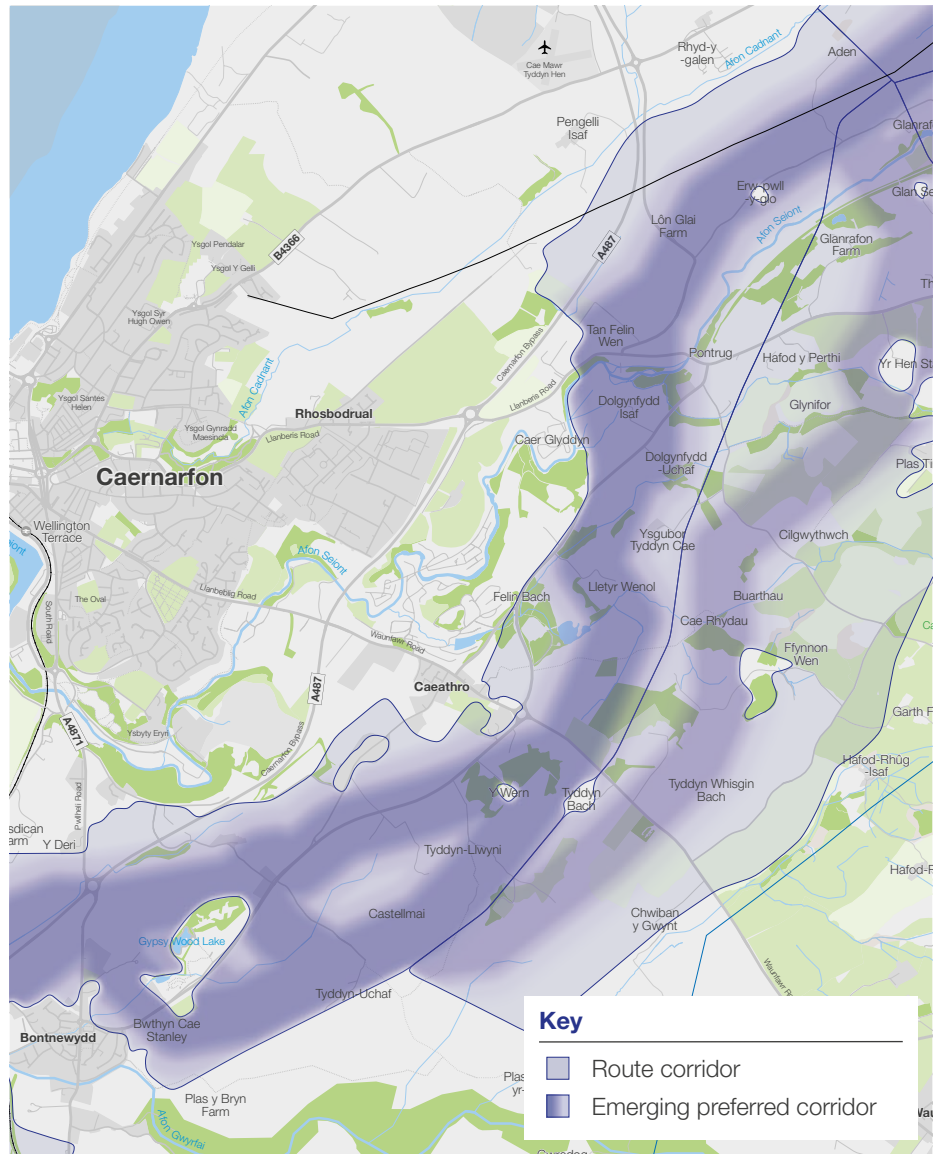
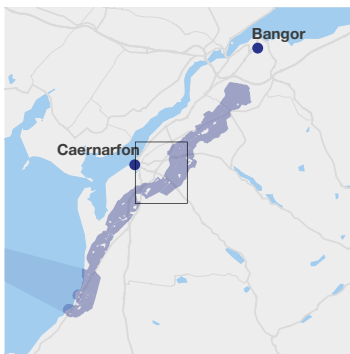

Sources: Map data © OpenStreetMap contributors, Microsoft, Esri Community Maps contributors, Map layer by Esri

Route section 3: Bontnewydd to Pentir – cable route

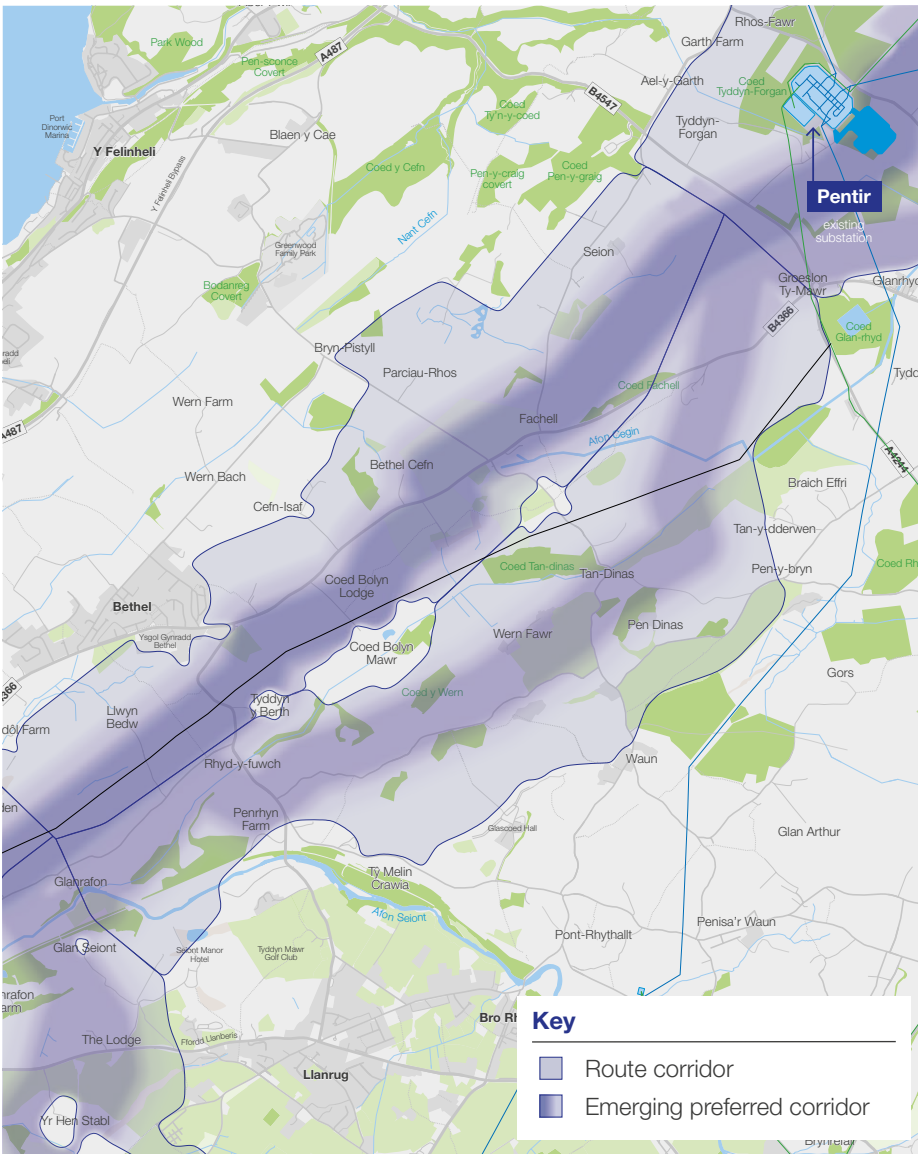

Sources: Map data © OpenStreetMap contributors, Microsoft, Esri Community Maps contributors, Map layer by Esri



Please refer to the Stage 1 consultation document and supporting technical documents for more information on our proposals in this route section, including how we selected the emerging preferred corridor.

You can view these documents at nationalgrid.com/westernlink2, at our in-person information events or at local information points.

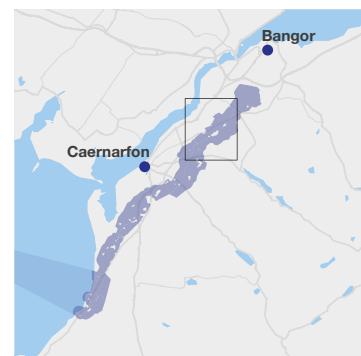

Route section 3: Bontnewydd to Pentir – cable route

Q3. Do you have any comments on route section 3, including the points listed below?

- Our emerging preferred cable route corridor(s).
- How we have arrived at these corridor(s).
- Our graduated swathe detailing the cable route options.
- Your local knowledge on the most appropriate location within the cable corridor to locate the new underground cable.
- Local features and impacts that are important to you.
- Access or environmental considerations.
- Potential construction activity impact.
- Anything else we should consider as we develop our proposals further.

Route section 4: Pentir – Converter station siting zones and existing Pentir substation extension zone

We are proposing a single new converter station in close proximity to the existing Pentir substation. We have identified two potential siting zones for this converter station based on our initial assessments with a preference for one of the siting zones.

You can see the two siting zones on the map below, including our preferred option. The Pentir East siting zone is currently our emerging preference for a siting zone for the converter station, with an area to the south of that zone identified as our emerging preferred siting location within this zone.

We've also identified a location for the necessary extension of the existing 400 kV Pentir substation.

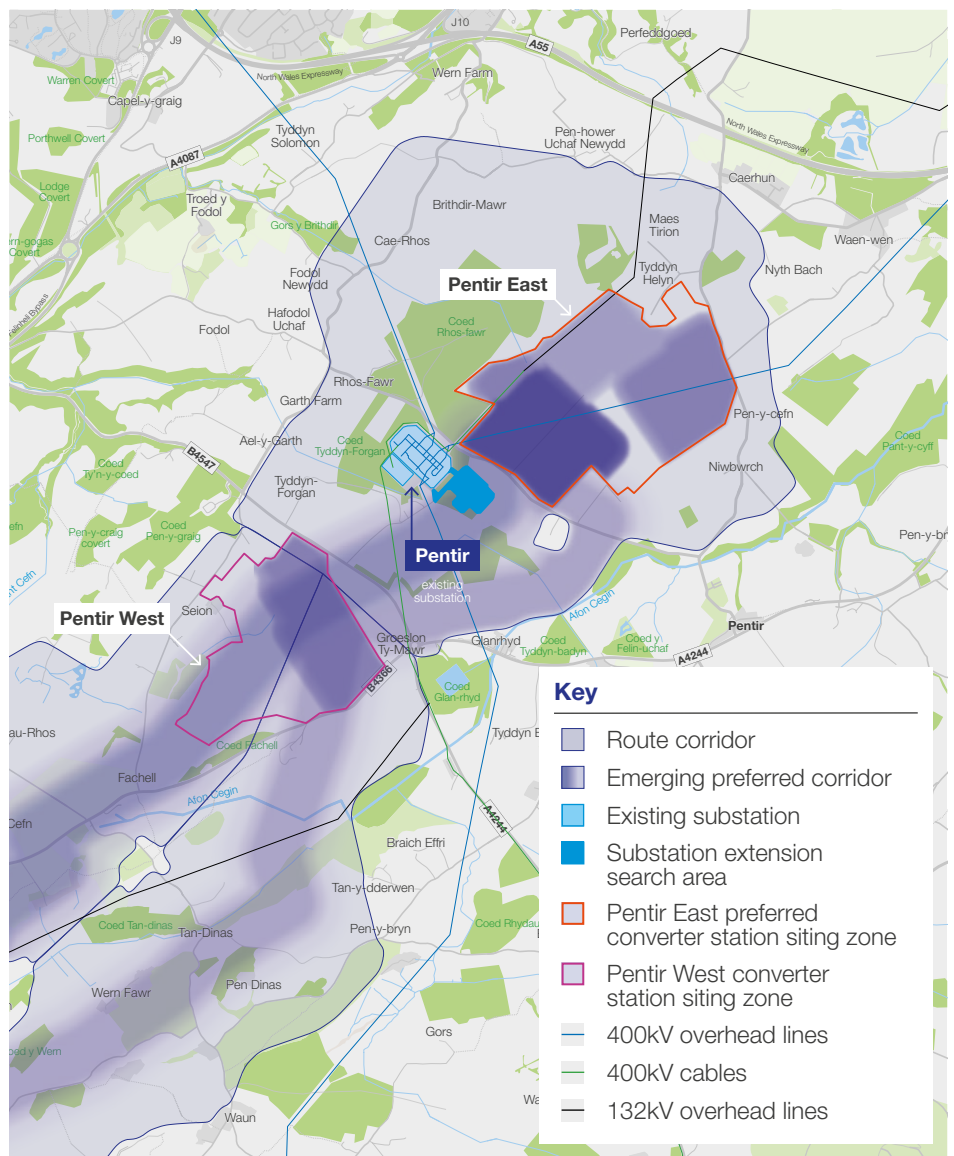
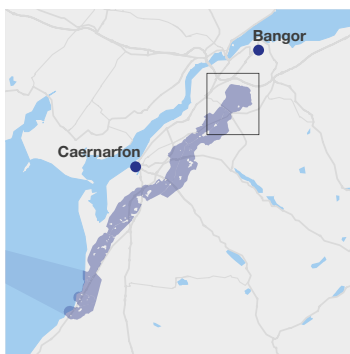

Sources: Map data © OpenStreetMap contributors, Microsoft, Esri Community Maps contributors, Map layer by Esri

Indicative converter station visualisations

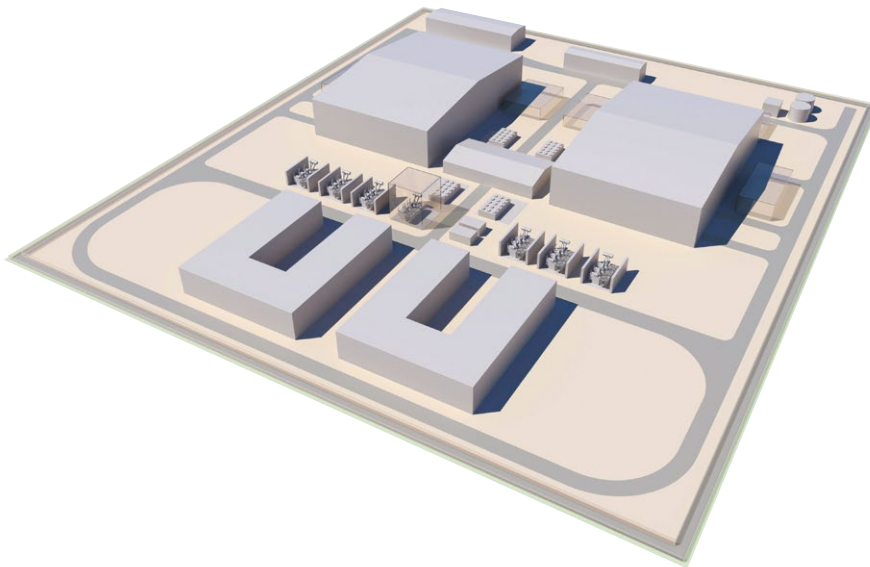

Please refer to the Stage 1 consultation document and supporting technical documents for more information on our proposals in this route section, including how we selected the emerging preferred corridor.

You can view these documents at nationalgrid.com/westernlink2, at our in-person information events or at local information points.

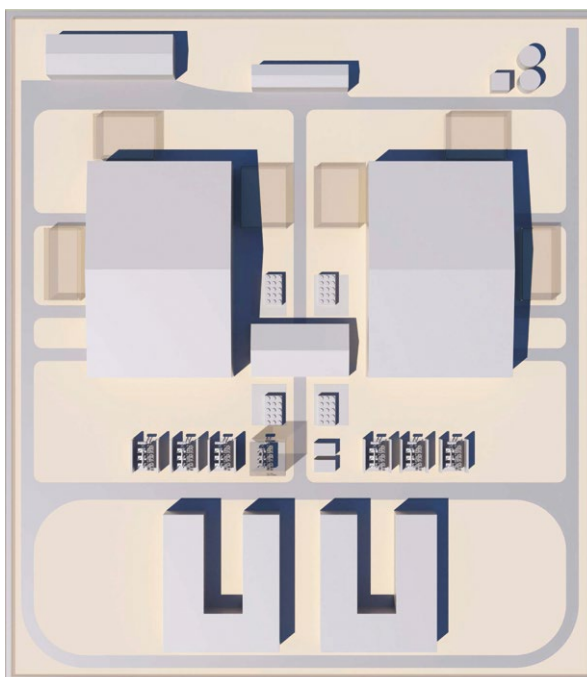

Route section 4: Pentir – Converter station siting zones and existing Pentir substation extension zone

Q4. Do you have any comments on route section 4, including the points listed below?

- Specifically in relation to our two converter station siting zones being:
 - Pentir East (which is currently the emerging preference) or
 - Pentir West.
- Potential location of the converter station within the emerging preferred converter station siting zone (Pentir East).
- Also, specifically the converter station design shown in our Stage 1 consultation document, and the extent to which these consider the local geography and local building designs and appearances.
- Our proposed extension of our existing Pentir substation.
- Your local knowledge on the most appropriate location within the cable corridor to locate the new underground cable from converter siting zones to the existing Pentir substation.
- Local features and impacts that are important to you.
- Access or environmental considerations.
- Potential construction activity impact.
- Anything else we should consider as we develop our proposals further.

Nearshore cable corridor

The proposed nearshore cable route for Western Link 2, which extends 12 nautical miles from the Welsh coast, has been carefully developed to align with landfall locations and avoid ecologically important areas including environmentally designated sites. Where we do need to interact with these areas, we will minimise potential impacts wherever possible.

This has been balanced with the need to identify routes that are technically feasible, whilst also taking account of existing infrastructure and the activities of other marine users and industries.



Please refer to the Stage 1 consultation document and supporting technical documents for more information on our proposals in this route section, including how we selected the emerging preferred corridor.

You can view these documents at nationalgrid.com/westernlink2, at our in-person information events or at local information points.



Sources: Map data © OpenStreetMap contributors, Microsoft, Esri Community Maps contributors, Map layer by Esri

Nearshore cable corridor

Q5 Do you have any comments on the proposed nearshore cable corridor?

Wider offshore proposals

The proposed wider offshore cable route for Western Link 2 extends from the northern limit of the nearshore area (see page 9) up to the southern limit of Scottish territorial seas.

It has been carefully developed to align with the offshore work of SP Energy Networks and to avoid ecologically important areas including environmentally designated sites.

Where we do need to interact with these areas, we will minimise potential impacts wherever possible.

This has been balanced with the need to identify routes that are technically feasible, whilst also taking account of existing infrastructure and the activities of other marine users and industries.

Q6 Do you have any comments on our emerging wider offshore proposals for Western Link 2?

Q7 Do you have any further general comments on the Western Link 2 proposals?

A large, empty rectangular box with a thin black border, intended for providing general comments on the Western Link 2 proposals. The box is currently blank.

About you

We would be grateful if you could answer the following optional, demographic questions.

We will use the information we receive to help understand whether our consultation has been useful to people of different backgrounds and requirements, and only in accordance with our Data Privacy Statement, as set out later in this form.

We may publish a summary of the results, but no information about an individual would be revealed.

The answers you provide to some of these questions are defined as 'special category data'. If you agree to provide this information, you can withdraw your permission for us to use it in our reports at any time. To withdraw your permission, please contact us via email at WesternLink2@nationalgrid.com.

Q8 How would you describe your interest in Western Link 2?

Please select all that apply:

Local resident

Regular visitor to the area

Local representative (i.e. Councillor / MS / MP)

Member of a local interest group (please specify below)

Potentially affected landowner, tenant or occupier that may be affected

Representative of a statutory organisation (please specify below)

Local business owner

Other (please specify below)

Q9. What is your gender?

Male

Female

Non-binary

Prefer not to say

Q10. Do you consider yourself a person with a disability?

Yes

No

Prefer not to say

Q11. How would you describe your ethnic background?

- | | | | |
|--------------------------|-----------------------------------------------------------|--------------------------|------------------------|
| <input type="checkbox"/> | White English, Welsh, Scottish, Northern Irish or British | <input type="checkbox"/> | White and Asian |
| <input type="checkbox"/> | Irish | <input type="checkbox"/> | Asian or Asian British |
| <input type="checkbox"/> | Gypsy or Irish Traveller | <input type="checkbox"/> | Indian |
| <input type="checkbox"/> | White and Black Caribbean | <input type="checkbox"/> | Pakistani |
| <input type="checkbox"/> | White and Black African | <input type="checkbox"/> | Bangladeshi |
| <input type="checkbox"/> | Black, African, | <input type="checkbox"/> | Chinese |
| <input type="checkbox"/> | Black Caribbean | <input type="checkbox"/> | Arab |
| <input type="checkbox"/> | Black British | | |

Any other White background (please state below)

Any other Asian background (please state below)

Any other Mixed or Multiple ethnic background (please state below)

Any other Black, African or Caribbean background (please state below)

Any other ethnic group (please state below)

Prefer not to say

Q12. What is your age?

- | | | | | | | | |
|--------------------------|----------|--------------------------|-------|--------------------------|-------|--------------------------|-------------------|
| <input type="checkbox"/> | Under 16 | <input type="checkbox"/> | 25-34 | <input type="checkbox"/> | 45-54 | <input type="checkbox"/> | 65+ |
| <input type="checkbox"/> | 16-24 | <input type="checkbox"/> | 35-44 | <input type="checkbox"/> | 55-64 | <input type="checkbox"/> | Prefer not to say |

Your contact details

We will only use these details in accordance with our Data Privacy Statement, as set out later in this form, which includes making contact with you to update you on the proposals. You don't have to fill in this section, although it would be helpful for us to understand the location of feedback being received, if you could include the first part of your postcode.

Title:	First name:
Surname:	
Organisation / group (if responding on behalf of one):	
Address:	
	Postcode:
Email address:	
<input type="checkbox"/>	Please tick here if you would like to be updated on our proposals via email.

Thank you for taking the time to complete our survey. Please know that by submitting this feedback form you give us permission to analyse and include your response in our consultation report and planning application.

Next steps

This Stage 1 consultation closes at 11:59 pm Tuesday 21 July 2026.

All responses to the consultation must be received before the consultation closes. Postal responses will be accepted until a week after the consultation closes if they have been sent within the consultation period.

Following this consultation, we will;

- Consider all relevant feedback received as we refine our proposals.
- Continue discussions with affected landowners.
- Continue briefing local elected representatives.
- Continue working with local authorities and other key stakeholders.

- Continue carrying out environmental surveys and technical studies.
- Provide newsletter updates.
- Provide updates to those who have asked to be kept updated on our proposals. You can register for these updates at nationalgrid.com/westernlink2.
- Post updates on our project website nationalgrid.com/westernlink2.
- Update our Grid:Engage app.

We will hold a second, statutory Stage 2 consultation, where we will present our more developed proposals for Western Link 2 in 2027. This Stage 2 consultation will be undertaken prior to making a planning application for the project.

Contact us



Email:
WesternLink2@nationalgrid.com



Freephone:
0800 156 0706



Website:
nationalgrid.com/westernlink2



Post: **FREEPOST W LINK 2**
(no stamp or further address details are required)

Information for landowners

If you are a landowner or have an interest in any land that may be affected by our proposals, you can contact the Western Link 2 Lands team.

The team can provide information, discuss your specific circumstances, and answer any questions you may have. You are also welcome to provide feedback on any aspect of the project as part of this consultation.



Freephone:
0333 038 5710



Email us:
w12@dalcourmaclaren.com



Post:
FREEPOST W LINK 2

Data privacy statement

We will use your personal data collected via this consultation for a number of purposes, including:

- to analyse your feedback to the consultation.
- to produce a consultation feedback report, based on our analysis of responses (individuals will not be identified in the report).
- to write to you with updates about the results of the consultation and other developments (if you do not wish to be contacted, you can submit the form anonymously)
- to keep up-to-date records of our communications with individuals and organisations.

Any personal information you include in this form will be handled and used by (or made available to) the following recipients, to record, analyse and report on the feedback we receive:

- National Grid
- SP Energy Networks
- our consent application decision maker
- our legal advisers
- consultants working on behalf of National Grid.

Where you provide feedback as part of this consultation that is relevant to other National Grid projects, it will be shared with other relevant projects so that it can be considered appropriately.

Contact us

Please get in touch if you have any questions about our proposals for Western Link 2.

0800 156 0706

(Lines are open Monday to Friday, 9am–5:30pm).
Please note, we do not accept feedback over the phone.
Please complete a feedback form or write to us.

WesternLink2@nationalgrid.com

FREEPOST W LINK 2

(no stamp or further address details are required)

