

For Planning

GENERAL NOTES

ALL BAKERHICKS DRAWINGS ARE TO BE READ IN CONJUNCTION WITH THE GENERAL NOTES DRAWINGS, THE RELEVANT BAKERHICKS SPECIFICATIONS AND ALL RELEVANT ARCHITECTS AND SERVICE ENGINEERS DRAWINGS AND SPECIFICATION.

ALL LEVELS ARE IN METRES ABOVE ORDINANCE DATUM.

ALL DIMENSIONS ARE IN MILLIMETRES (U.N.O.)

DO NOT SCALE ANY ENGINEERING DRAWINGS OR DIGITAL DATA. IF IN DOUBT ASK WORK TO FIGURED DIMENSIONS ONLY. ANY DISCREPANCIES IN DIMENSIONS ARE TO BE REFERRED TO ENGINEER BEFORE WORK IS PUT TO HAND.

THE CONTRACTOR MUST ADVISE THE ARCHITECT AND ENGINEER OF ANY DISCREPANCIES BETWEEN THE CONTRACT DRAWINGS AND/OR SITE CONDITIONS / DIMENSIONS AT THE EARLIEST POSSIBLE OPPORTUNITY.

REVISION NOTES ARE FOR GUIDANCE ONLY. FOR SPECIFIC DETAILS, REFER TO CLOUDED AREA ON DRAWINGS FOR MOST RECENT AMENDMENTS.

ALL DIMENSIONS AND LEVELS ARE TO BE CHECKED ON SITE BY THE CONTRACTOR OR HIS SUBCONTRACTOR PRIOR TO PREPARING ANY WORKING DRAWINGS OR COMMENCING ON SITE.

ALL WORK HAS TO BE CARRIED OUT WITH THE REQUIREMENTS OF THE RELEVANT STATUTORY AUTHORITIES AND REGULATIONS.

ALL METHOD STATEMENTS SHOULD BE SUBMITTED TO THE ARCHITECT / CDM PRINCIPAL DESIGNER AND ENGINEER FOR REVIEW AT LEAST TWO WEEKS BEFORE CARRYING OUT THE SAD WORKS.

ALL PROPRIETARY PRODUCTS TO BE AS SPECIFIED OR EQUAL APPROVED.

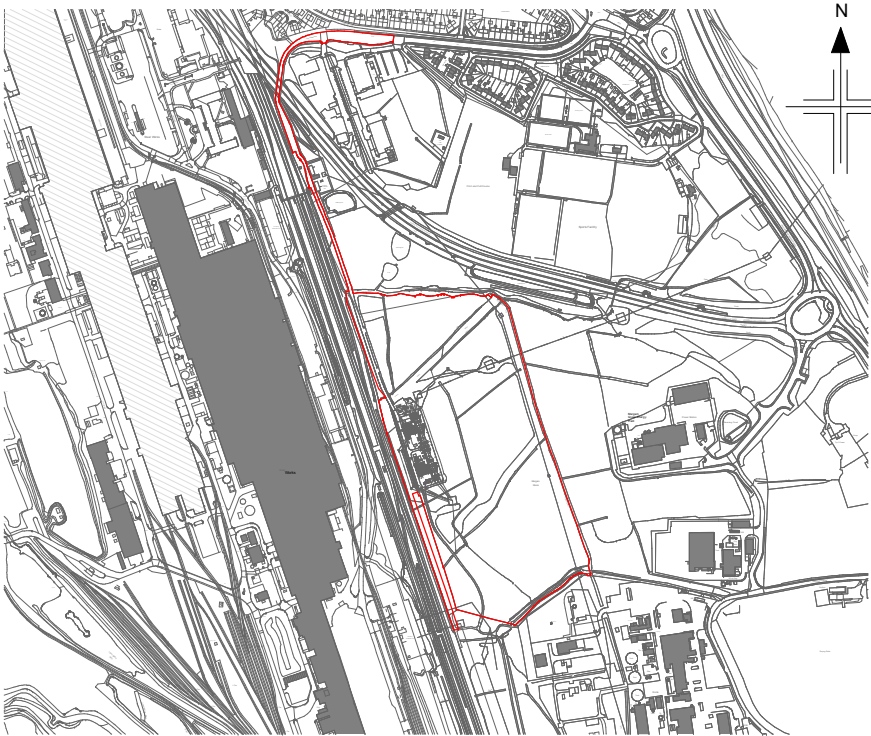

KEYPLAN

SITE KEY



SITE BOUNDARY
SITE AREA: (154648.052 m2)
(15.46 Hectares)
(38.20 Acres)

NOTE:

DRAWING TO BE PRINTED IN COLOUR

REFER TO PEAT MANAGEMENT STRATEGY FOR AREAS OF PEAT BURIAL LOCATIONS

P04	S3 For Review and Comment: Planning drawings updated following feedback with NPT on 24/07/25	MY	OTr / PC	29/07/25
P03	Issued for planning, comments incorporated following client feedback	GP	OTr / RC	24/04/25
P02	Issued For Planning	DSB	OTr / RW	10/02/25
P01	Issued to Client and Planning Consultant for Comment	MY	OTr / RW	27/01/25
Rev	Description	Cre'd	Chk'd / App'd	Date

nationalgrid

Master Scheme No:	Sub-Scheme No:	Site:
101677		MARGAM

Scheme Name:
Margam Substation

Document Title:

Margam GIS Hall - Location Plan

Created by:	Date:	Checked by:	Date:	Approved by:	Date:
MY	07/01/25	OTr	07/01/25	RW	07/01/25
Development Eng:	Document Type:	Scale:	Format:	Sheet(s):	Rev:
DWG		1 : 2500	A1	1 OF 1	P04

National Grid Document Number:	13_LOR_0063
--------------------------------	-------------

FEED Document Number:	MARPT-BHK-01-ZZ-DG-A-130020
-----------------------	-----------------------------

1 Location Plan_Planning Application
Scale: 1 : 2500

© BakerHicks
This document is issued for the party which commissioned it and for specific purposes connected with the captioned project only. It should not be relied upon by any other party or used for any other purpose.
We accept no responsibility for the consequences of this document being relied upon by any other party, or being used for any other purpose, or containing any error or omission which is due to an error or omission in data supplied to use by other parties

© National Grid
Copyright not to be reproduced without written permission of the National Grid Electricity Transmission Plc.

THIS IS A TP500 STAGE 4.2
DRAWING AND IS FOR
DEVELOPMENT PURPOSES ONLY