

HEALTH & SAFETY  
CDM REGULATIONS 2015

SIGNIFICANT RISKS ASSOCIATED WITH THIS DRAWING ARE IDENTIFIED BELOW AND, WHERE APPLICABLE, AT SPECIFIC LOCATIONS ON THE DRAWING. REFER TO CDM REGULATION 9 RISK REGISTER FOR FULL DETAILS.

GENERAL NOTES

- ALL BAKERHICKS DRAWINGS ARE TO BE READ IN CONJUNCTION WITH THE GENERAL NOTES DRAWINGS, THE RELEVANT BAKERHICKS SPECIFICATIONS AND ALL RELEVANT ARCHITECTS AND SERVICE ENGINEERS DRAWINGS AND SPECIFICATION.
- ALL DIMENSIONS ARE IN METRES ABOVE ORDNANCE DATUM.
- DO NOT SCALE ANY ENGINEERING DRAWINGS OR DIGITAL DATA. IF IN DOUBT, ASK WORK TO FOURED DIMENSIONS ONLY. ANY DISCREPANCIES IN DIMENSIONS ARE TO BE REFERRED TO ENGINEER BEFORE WORK IS PUT TO HAND.
- THE CONTRACTOR MUST ADVISE THE ARCHITECT AND ENGINEER OF ANY DISCREPANCIES BETWEEN THE CONTRACT DRAWINGS AND/OR SITE CONDITIONS / DIMENSIONS AT THE EARLIEST POSSIBLE OPPORTUNITY.
- REVISION NOTES ARE FOR GUIDANCE ONLY. FOR SPECIFIC DETAILS, REFER TO CLOUDED AREA ON DRAWINGS FOR MOST RECENT AMENDMENTS.
- ALL DIMENSIONS AND LEVELS ARE TO BE CHECKED ON SITE BY THE CONTRACTOR OR HIS SUB-CONTRACTOR PRIOR TO PREPARING ANY WORKING DRAWINGS OR COMMENCING ON SITE.
- ALL WORK HAS TO BE CARRIED OUT WITH THE REQUIREMENTS OF THE RELEVANT STATUTORY AUTHORITIES AND REGULATIONS.
- ALL METHOD STATEMENTS SHOULD BE SUBMITTED TO THE ARCHITECT / CDM PRINCIPAL DESIGNER AND ENGINEER FOR REVIEW AT LEAST TWO WEEKS BEFORE CARRYING OUT THE SAID WORKS.
- ALL PROPRIETARY PRODUCTS TO BE AS SPECIFIED OR EQUAL APPROVED.

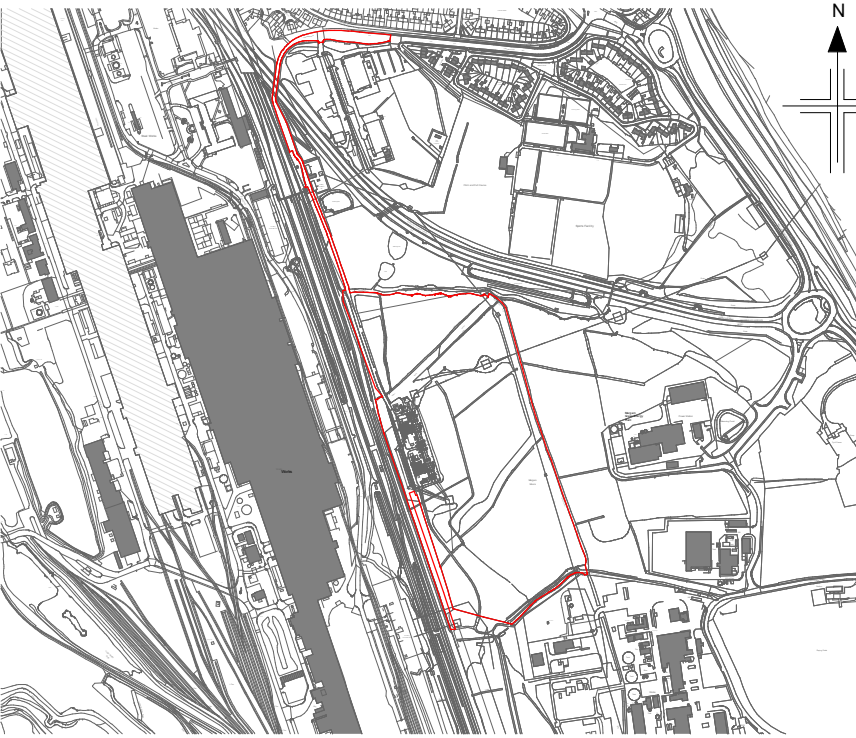

KEYPLAN

Demolitions Legend

- B1**  
Allow for removal of existing steelwork. Where existing elements are to be removed, any disturbed surfaces must be made good and finished to an acceptable standard in line with Architects & Engineers proposals.
- Site Boundary  
To be demolished

General Notes

This drawing is based upon existing drawings received from the Client. Existing elements may vary on site. Contractor to take check dimensions on site following demolition and report any discrepancies to the Lead Designer for review.

Retained walls to be inspected and sufficiently supported during demolition works. Any damages whether existing or as part of these works to be made good.

All services to be removed should capped / terminated / pulled back and made safe where not required. Any disturbed surfaces following removal of doors/partitions must be made good and finished to an acceptable standard.

**NOTE:**  
THE AREAS OF PROPOSED WORK MAY CONTAIN HAZARDOUS MATERIALS. All walls proposed for demolition / amendment should be done so carefully by a contractor licensed to work with hazardous materials. Any areas proposed for demolition should be verified by a structural engineer. Refer to M&E Consultant drawings for locations of any Mechanical and Electrical Services. Any person working in the area of proposed works **SHOULD ALWAYS:**

- Make sure they have had adequate and suitable training before starting any work.
- Stop work and speak to their employer, or the building owner if there are suspicions a material may be hazardous or if it is thought the work might need to be carried out by a licensed contractor.
- Follow the plan of work and essentials guidance sheets that can be downloaded from the HSE.gov.uk website, ensuring that the right sheet for the job is used.
- Ensure they take account other risks such as work at height. Use protective equipment, including a suitable face mask, worn properly.
- Clean up regularly to stop waste building up.
- Ensure that hazardous waste is double-bagged and disposed of properly at a licensed tip.
- Wash prior to breaks and before going home. Check whether any work should be notified.

THOSE IN CHARGE OF THE JOB MUST:

- Find out if hazardous materials are present and plan the work to avoid disturbing these materials where possible.
- Ensure that anyone who is going to work on hazardous material has had appropriate information, instruction and training and is supervised.
- Know what work can be carried out on hazardous materials, i.e. does this work need to be carried out by a licensed contractor?
- Take account of other risks, e.g. work at height, and take the precautions necessary to do the job safely.
- Use the equipment, methods sheets and the right task sheet to make sure that the job is carried out properly.
- Prepare a plan of work, explaining what the job involves, the work procedures, and what controls to use.
- Provide the right equipment, which is clean, in good working order, and protects you against hazardous materials.
- Train people in using this equipment.
- Make sure the work area is inspected visually at the end of the job, to check it's fit for reoccupation.
- Make arrangements for the safe disposal of any hazardous waste.
- Consult the health and safety representative (if there is one).

DO NOT:

- Use methods that create a lot of dust such as using power tools.
- Sweep up dust and debris - use a Type H vacuum cleaner or wet rags.
- Take home overalls used for work with Hazardous Materials.
- Reuse disposable clothing or masks.
- Smoke.
- Eat or drink in the work area.

PD4	[S3 For Review and Comment: Planning drawings updated following feedback with M&P]	AL	OTI / PC	06/08/25
PD3	Issued for planning, comments incorporated following client feedback	GP	OTI / RC	24/04/25
PD2	Issued For Planning	DSB	OTI / RW	10/02/25
PD1	First Issue	DSB	RW / JK	03/02/25
Rev	Description	Created	Checked / Approved	Date

**nationalgrid**

Master Scheme No:	Sub-Scheme No:	Site:
101677		MARGAM
Scheme Name:		
Margam Substation		

Document Title:
Margam GIS Hall - Demolition Site Plan

Created by:	Date:	Checked by:	Date:	Approved by:	Date:
DSB	07/01/25	RW	07/01/25	JK	07/01/25
Development Eng:	Document Type:	Scale:	Format:	Sheets:	Rev
	DWG	As indicated	A0	1 OF 1	PD4
National Grid Document Number:					
13_LOR_0065					

MARPT-BHK-01-ZZ-DG-A-130022

1 | Site Plan - Demolition

Scale: 1 : 500

© Bakerhicks  
This document is issued for the party which commissioned it and for specific purposes connected with the captioned project only. It should not be relied upon by any other party or used for any other purpose. We accept no responsibility for the consequences of this document being relied upon by any other party, or being used for any other purpose, or containing any error or omission which is due to an error or omission in data supplied to use by other parties.

© National Grid  
Copyright not to be reproduced without written permission of the National Grid Electricity Transmission Plc.

NOTE:

DRAWING TO BE  
PRINTED IN COLOUR

For Planning