

The background image shows two women walking on a dirt path through a field of tall grass and wildflowers. The woman on the left is wearing a plaid shirt, a dark vest, and jeans, and is holding a leash for a black and white dog. The woman on the right is wearing a dark jacket and leggings. In the background, there are power lines and a cloudy sky.

The Great Grid Upgrade

Grimsby to Walpole

Preliminary Environmental Information Report

Volume 2 Part B Section Specific Assessments

Section 7 New Walpole B Substation

Chapter 7 Geology and Hydrogeology

Figures

June 2025

Volume 2 Part B Section 7 Chapter 7 – Figure List

Figure number	Figure title
Figure 7.1	Superficial Geology
Figure 7.2	Bedrock Geology
Figure 7.3	Aquifer Designations: Superficial Deposits
Figure 7.4	Aquifer Designations: Bedrock Geology
Figure 7.5	Landfills, Waste and Potentially Contaminative Previous Land Uses

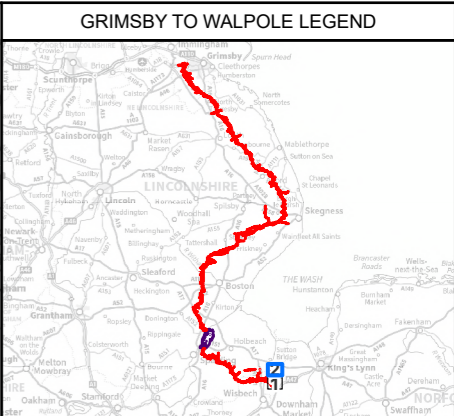
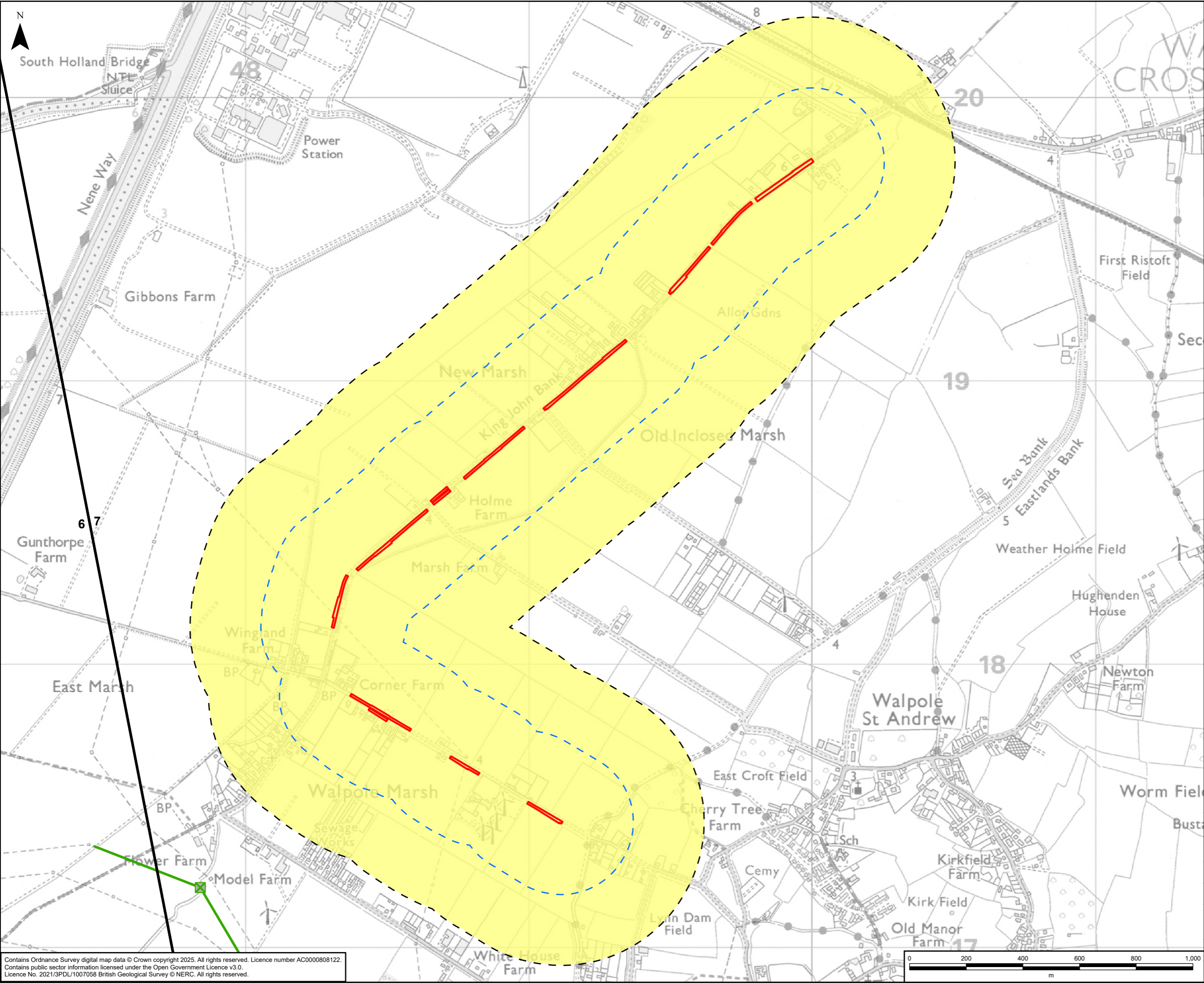

GRIMSBY TO WALPOLE LEGEND

Legend

- Draft Order Limits
- Route Section Break
- 250m Study Area
- 500m Study Area
- Superficial Geology (BGS 50k)
- Tidal Flat Deposits - Clay and Silt

A	08/04/2025	First Issue	LC	SG	DR
Rev	Date	Description	GIS	Chk	App
nationalgrid					
Purpose:		PEI REPORT - SECTION 7			
Scheme:		GRIMSBY TO WALPOLE			
Document Title:		FIGURE 7.1 SUPERFICIAL GEOLOGY			
Creator:	Date:	Checker:	Date:	Approver:	Date:
LC	08/04/2025	SG	08/04/2025	DR	08/04/2025
Document Type:	Scale:	Format:	Sheets:	Rev:	
FIGURE	1:12,500	A3	2 OF 2	A	

Contains Ordnance Survey digital map data © Crown copyright 2025. All rights reserved. Licence number AC0000808122.
Contains public sector information licensed under the Open Government Licence v3.0.
Licence No. 2021/3PDL/1007058 British Geological Survey © NERC. All rights reserved.

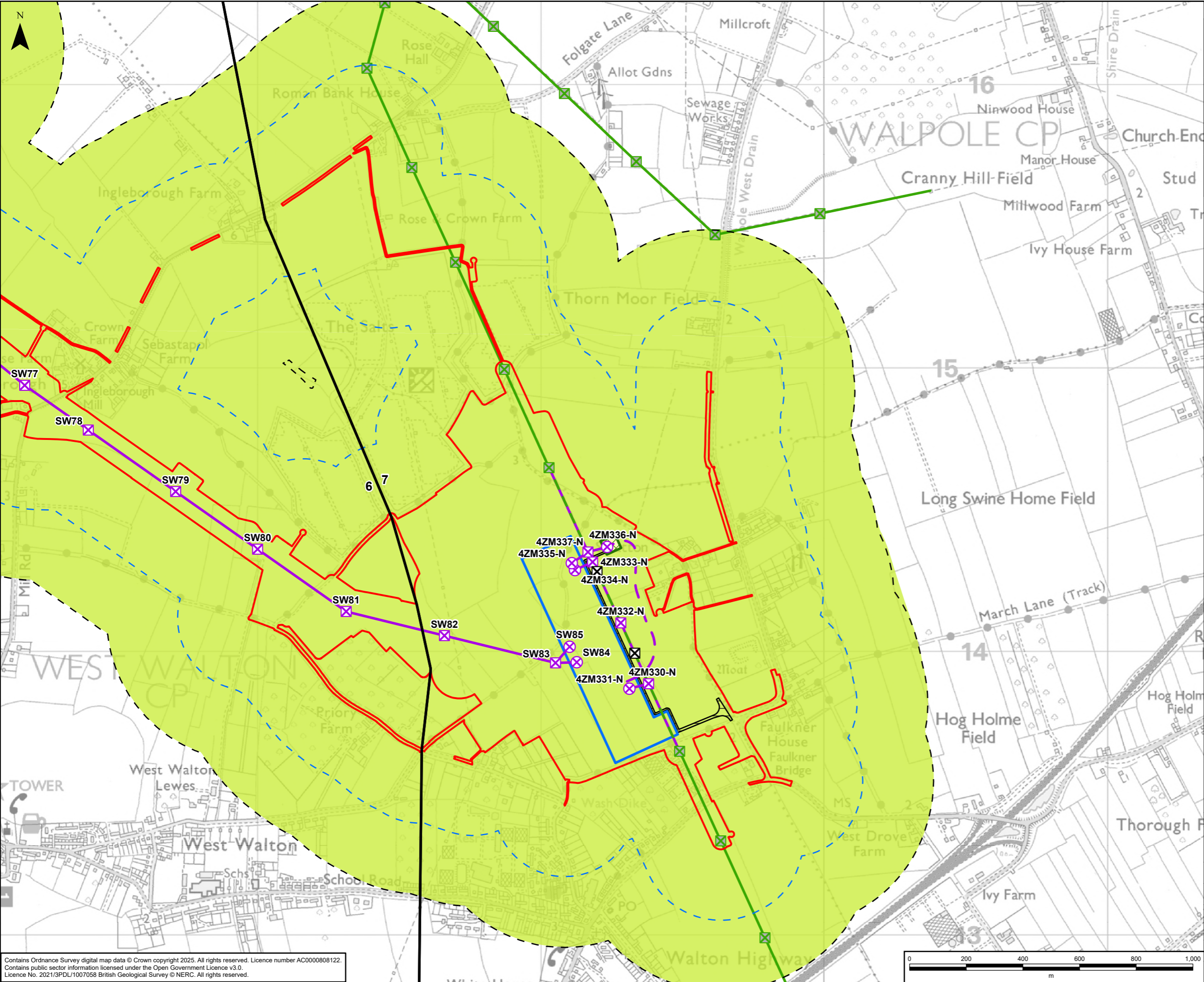

GRIMSBY TO WALPOLE LEGEND

Legend

- Draft Order Limits
- Route Section Break
- 250m Study Area
- 500m Study Area
- Indicative New Lattice Pylon
- Indicative New Gantry
- Existing Lattice Pylon - Not Affected
- Existing Lattice Pylon - To Be Dismantled
- Indicative New Overhead Line
- Indicative New Underground Cable
- Existing Overhead Line - Not Affected
- Existing Overhead Line - To Be Dismantled
- Existing Overhead Line - To Be Modified
- Indicative New Substation Boundary
- Indicative Cable Sealing End Compound Boundary
- Indicative Permanent Substation Access Route
- Bedrock Geology (BGS 50k)
- Amphill Clay Formation - Mudstone

A	08/04/2025	First Issue	LC	SG	DR
Rev	Date	Description	GIS	Chk	App

nationalgrid

Purpose: PEI REPORT - SECTION 7

Scheme: GRIMSBY TO WALPOLE

Document Title: **FIGURE 7.2
BEDROCK GEOLOGY**

Creator: LC	Date: 08/04/2025	Checker: SG	Date: 08/04/2025	Approver: DR	Date: 08/04/2025
Document Type: FIGURE	Scale: 1:12,500	Format: A3	Sheets: 1 OF 2	Rev: A	

Contains Ordnance Survey digital map data © Crown copyright 2025. All rights reserved. Licence number AC0000808122.
Contains public sector information licensed under the Open Government Licence v3.0.
Licence No. 2021/3PDL/1007058 British Geological Survey © NERC. All rights reserved.

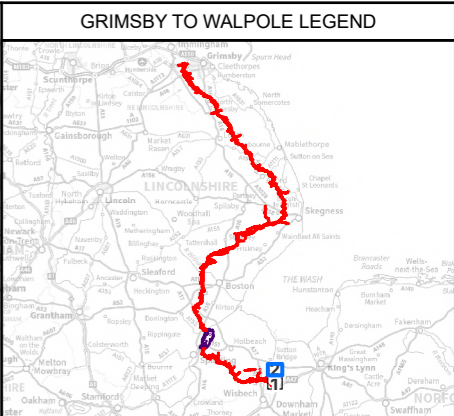
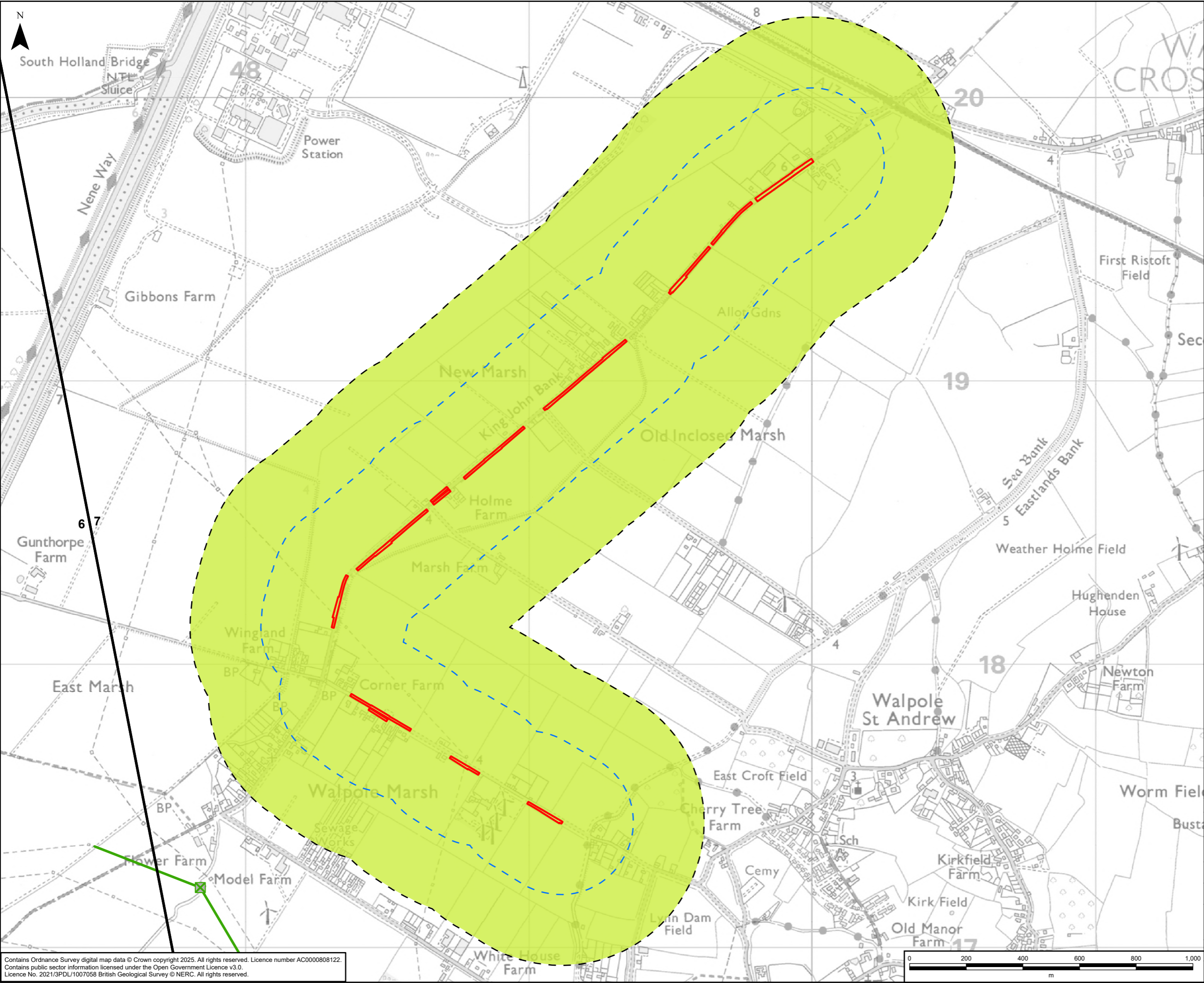

GRIMSBY TO WALPOLE LEGEND				
Legend				
<div><div></div> Draft Order Limits</div>				
<div><div></div> Route Section Break</div>				
<div><div></div> 250m Study Area</div>				
<div><div></div> 500m Study Area</div>				
Bedrock Geology (BGS 50k)				
<div><div></div> Amphill Clay Formation - Mudstone</div>				

Contains Ordnance Survey digital map data © Crown copyright 2025. All rights reserved. Licence number AC0000808122.
Contains public sector information licensed under the Open Government Licence v3.0.
Licence No. 2021/3PDL1007058 British Geological Survey © NERC. All rights reserved.

Document Path: \\eu.aecomnet.com\EMIA\UK\UKNCL2\Jobs\60721024 Grimsby to Walpole\02_Maps\PEIR\Volume 2\Part B\G2W_PEIR_2_B_Chapter_7_Geology_and_Hydrogeology_Figures.aprx

A	08/04/2025	First Issue	LC	SG	DR
Rev	Date	Description	GIS	Chk	App
nationalgrid					
Purpose:		PEI REPORT - SECTION 7			
Scheme:		GRIMSBY TO WALPOLE			
Document Title:		FIGURE 7.2 BEDROCK GEOLOGY			
Creator:	Date:	Checker:	Date:	Approver:	Date:
LC	08/04/2025	SG	08/04/2025	DR	08/04/2025
Document Type:	Scale:	Format:	Sheets:	Rev:	
FIGURE	1:12,500	A3	2 OF 2	A	

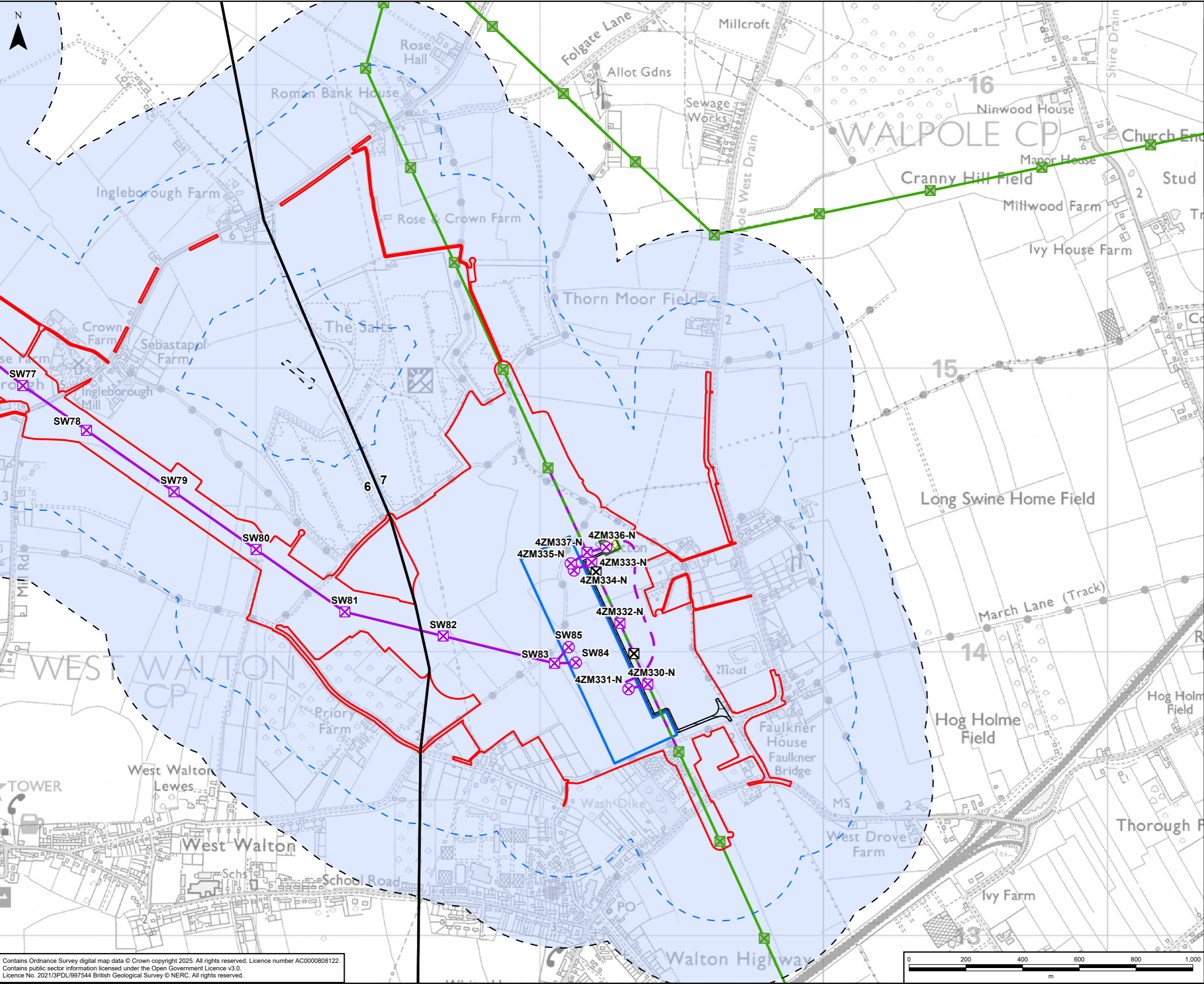

GRIMSBY TO WALPOLE LEGEND

Legend

- Draft Order Limits
- Route Section Break
- 250m Study Area
- 500m Study Area
- Indicative New Lattice Pylon
- Indicative New Gantry
- Existing Lattice Pylon - Not Affected
- Existing Lattice Pylon - To Be Dismantled
- Indicative New Overhead Line
- Indicative New Underground Cable
- Existing Overhead Line - Not Affected
- Existing Overhead Line - To Be Dismantled
- Existing Overhead Line - To Be Modified
- Indicative New Substation Boundary
- Indicative Cable Sealing End Compound Boundary
- Indicative Permanent Substation Access Route
- Aquifer Designation: Superficial Deposits
- Unproductive Strata

A	25/04/2025	First Issue	LC	SG	DR
Rev	Date	Description	GIS	Chk	App

nationalgrid

Purpose: PEI REPORT - SECTION 7

Scheme: GRIMSBY TO WALPOLE

Document Title: **FIGURE 7.3**
AQUIFER DESIGNATIONS: SUPERFICIAL DEPOSITS

Creator: LC	Date: 25/04/2025	Checker: SG	Date: 25/04/2025	Approver: DR	Date: 25/04/2025
Document Type: FIGURE	Scale: 1:12,500	Format: A3	Sheets: 1 OF 2	Rev: A	

Contains Ordnance Survey digital map data © Crown copyright 2025. All rights reserved. Licence number AC0000808122.
Contains public sector information licensed under the Open Government Licence v3.0.
Licence No. 2021/3PDL/997544 British Geological Survey © NERC. All rights reserved.

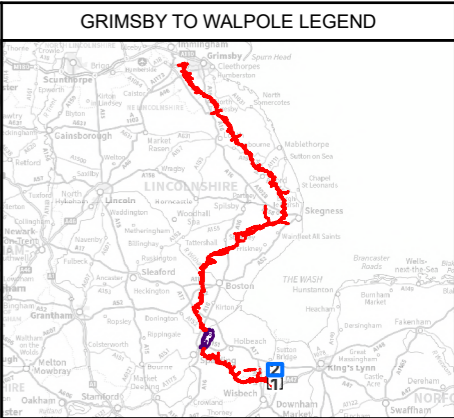
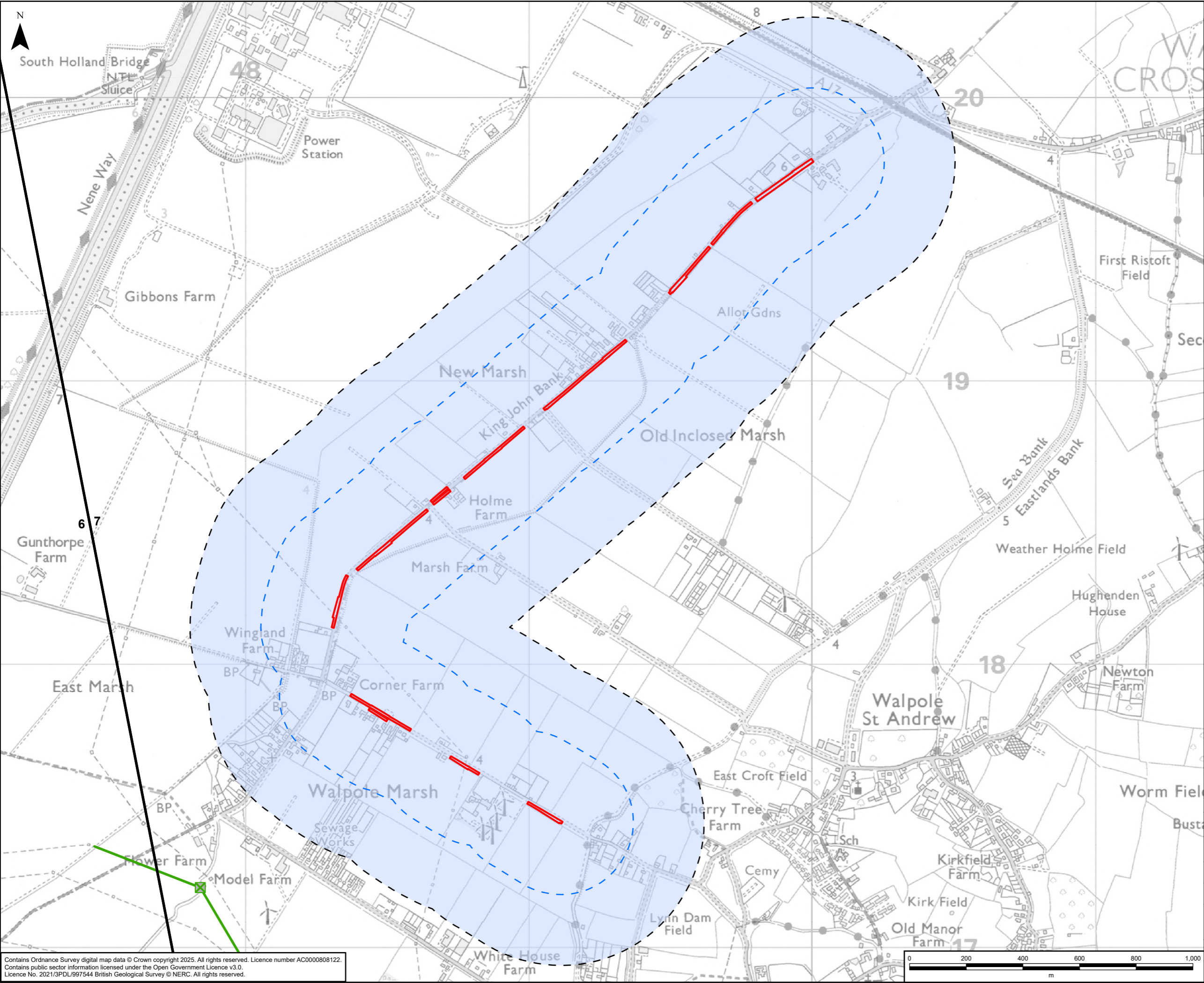

- Legend**
- Draft Order Limits
 - Route Section Break
 - 250m Study Area
 - 500m Study Area
 - ✕ Existing Lattice Pylon - Not Affected
 - Existing Overhead Line - Not Affected
 - Aquifer Designation: Superficial Deposits
 - Unproductive Strata

A	25/04/2025	First Issue	LC	SG	DR
Rev	Date	Description	GIS	Chk	App

nationalgrid

Purpose: PEI REPORT - SECTION 7

Scheme: GRIMSBY TO WALPOLE

Document Title: FIGURE 7.3
AQUIFER DESIGNATIONS: SUPERFICIAL DEPOSITS

Creator: LC	Date: 25/04/2025	Checker: SG	Date: 25/04/2025	Approver: DR	Date: 25/04/2025
Document Type: FIGURE	Scale: 1:12,500	Format: A3	Sheets: 2 OF 2	Rev: A	

Contains Ordnance Survey digital map data © Crown copyright 2025. All rights reserved. Licence number AC0000808122.
Contains public sector information licensed under the Open Government Licence v3.0.
Licence No. 2021/3PDL/997544 British Geological Survey © NERC. All rights reserved.

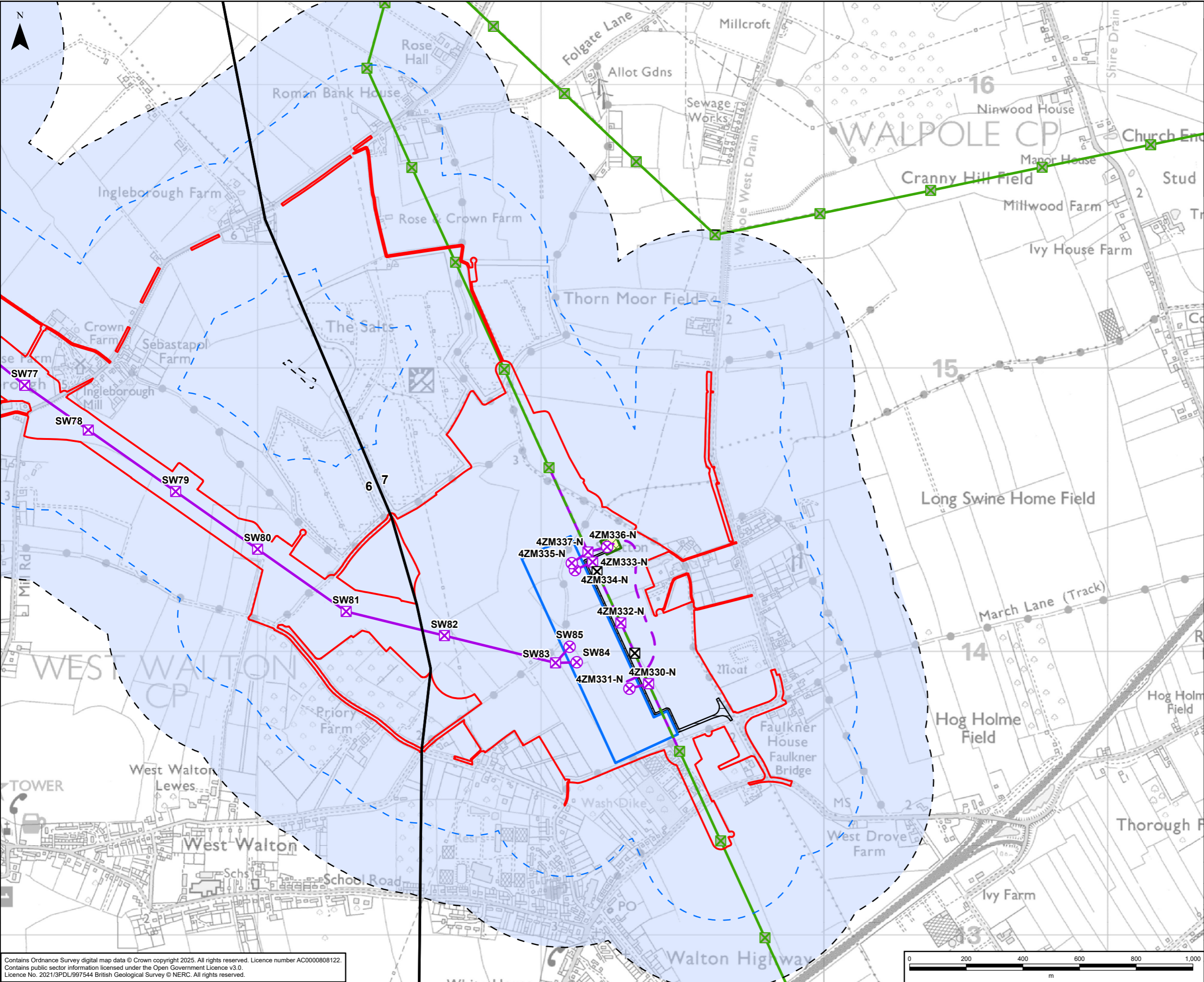

GRIMSBY TO WALPOLE LEGEND

Legend

- Draft Order Limits
- Route Section Break
- 250m Study Area
- 500m Study Area
- Indicative New Lattice Pylon
- Indicative New Gantry
- Existing Lattice Pylon - Not Affected
- Existing Lattice Pylon - To Be Dismantled
- Indicative New Overhead Line
- Indicative New Underground Cable
- Existing Overhead Line - Not Affected
- Existing Overhead Line - To Be Dismantled
- Existing Overhead Line - To Be Modified
- Indicative New Substation Boundary
- Indicative Cable Sealing End Compound Boundary
- Indicative Permanent Substation Access Route
- Aquifer Designation: Bedrock Geology
- Unproductive Strata

NOTE:
The Environment Agency provides records of groundwater abstractions, which are not available under Open Government License (available under the Environment Agency Conditional License) and have therefore not been reproduced on this figure

A	12/05/2025	First Issue	LC	SG	DR
Rev	Date	Description	GIS	Chk	App

nationalgrid

Purpose: PEI REPORT - SECTION 7

Scheme: GRIMSBY TO WALPOLE

Document Title: FIGURE 7.4
AQUIFER DESIGNATIONS: BEDROCK GEOLOGY

Creator: LC	Date: 12/05/2025	Checker: SG	Date: 12/05/2025	Approver: DR	Date: 12/05/2025
-------------	------------------	-------------	------------------	--------------	------------------

Document Type: FIGURE	Scale: 1:12,500	Format: A3	Sheets: 1 OF 2	Rev: A
-----------------------	-----------------	------------	----------------	--------

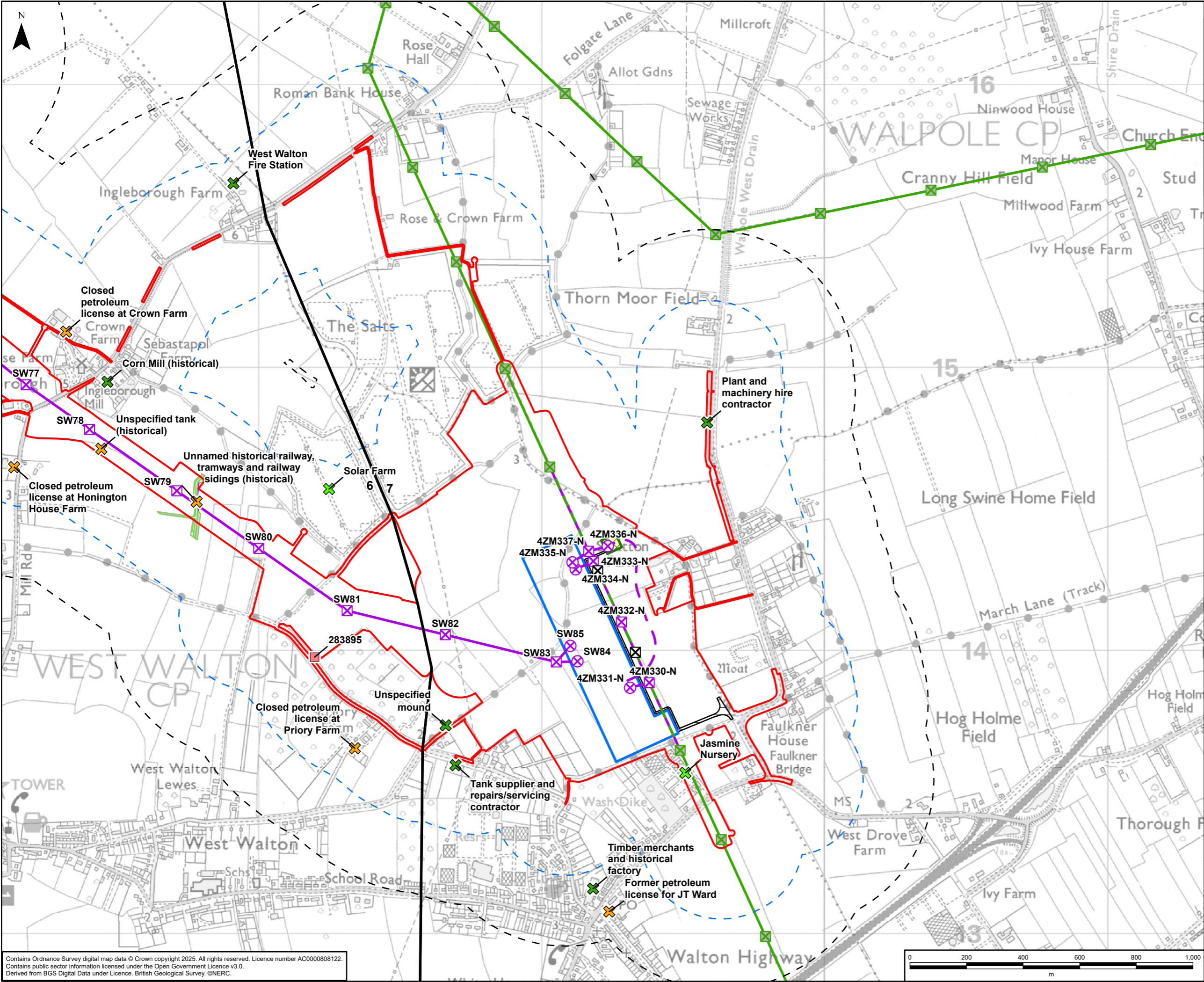

GRIMSBY TO WALPOLE LEGEND

Legend

- Draft Order Limits
- Route Section Break
- 250m Study Area
- 500m Study Area
- Indicative New Lattice Pylon
- Indicative New Gantry
- Existing Lattice Pylon - Not Affected
- Existing Lattice Pylon - To Be Dismantled
- Indicative New Overhead Line
- Indicative New Underground Cable
- Existing Overhead Line - Not Affected
- Existing Overhead Line - To Be Dismantled
- Existing Overhead Line - To Be Modified
- Indicative New Substation Boundary
- Indicative Cable Sealing End Compound Boundary
- Indicative Permanent Substation Access Route
- Pollution Incident Location (EA)
- Historical Railway Feature HD
- Historical Railway Feature LD
- Historical Tank

Features of Contamination Potential

- Very Low
- Low
- Moderate

The potential contamination features shown on this drawing are represented by an indicative point location and not a polygon showing their extent. The extent of these features is discussed within the PEI Report where available/known.

LCC data sourced from the Lincolnshire Minerals and Waste Local Plan. EA abstraction information has not been digitised as this is protected information.

A	28/04/2025	First Issue	LC	SG	DR
Rev	Date	Description	GIS	Chk	App

nationalgrid

Purpose: PEI REPORT - SECTION 7

Scheme: GRIMSBY TO WALPOLE

Document Title: FIGURE 7.5 LANDFILLS, WASTE AND POTENTIALLY CONTAMINATIVE PREVIOUS LAND USES

Creator: LC	Date: 28/04/2025	Checker: SG	Date: 28/04/2025	Approver: DR	Date: 28/04/2025
Document Type: FIGURE	Scale: 1:12,500	Format: A3	Sheets: 1 OF 2	Rev: A	

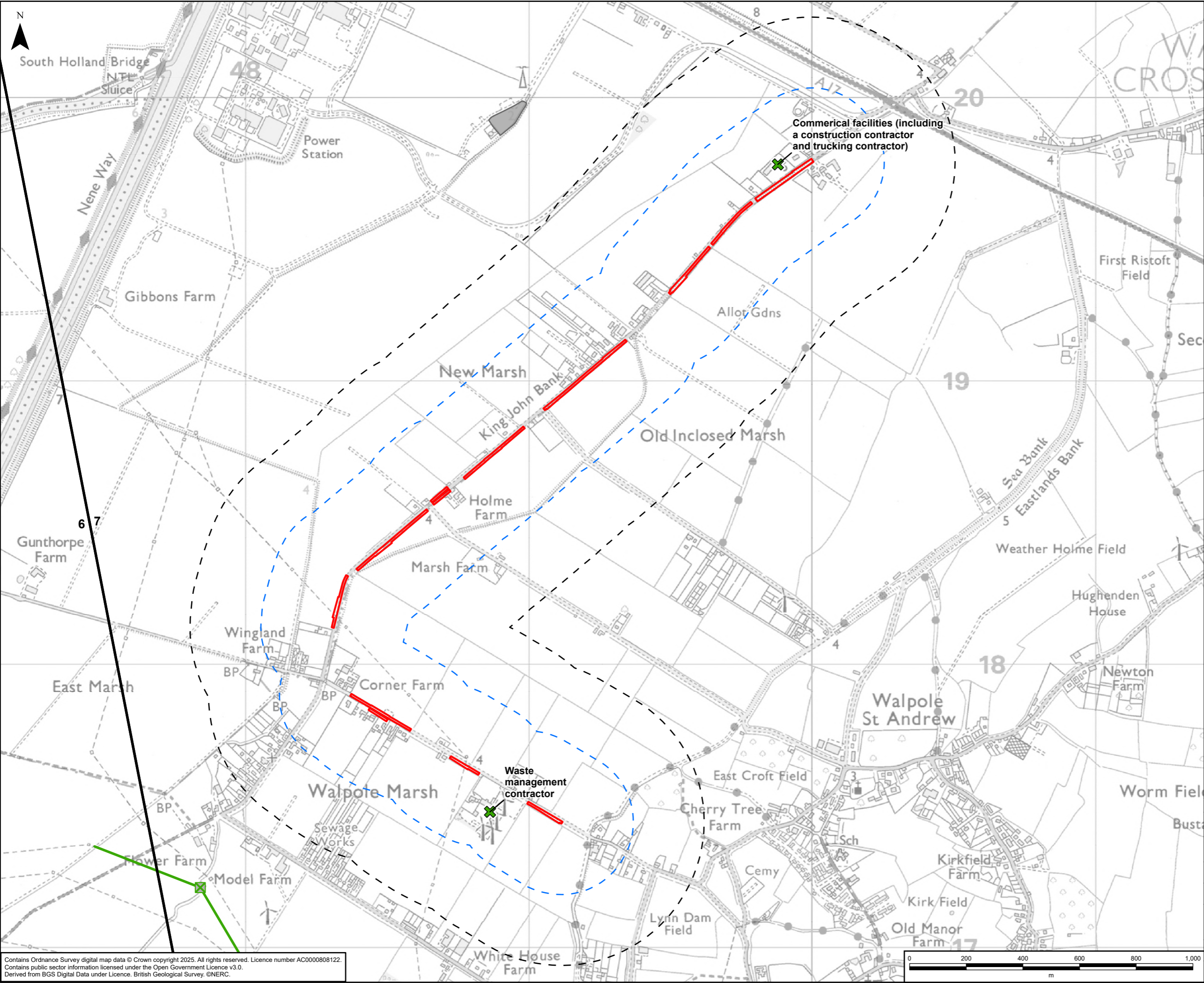

GRIMSBY TO WALPOLE LEGEND

Legend

- Draft Order Limits
- Route Section Break
- 250m Study Area
- 500m Study Area
- Existing Lattice Pylon - Not Affected
- Existing Overhead Line - Not Affected
- Historic Landfill Site (EA)
- Features of Contamination Potential
- Low

The potential contamination features shown on this drawing are represented by an indicative point location and not a polygon showing their extent. The extent of these features is discussed within the PEI Report where available/known.

LCC data sourced from the Lincolnshire Minerals and Waste Local Plan.
EA abstraction information has not been digitised as this is protected information.

A	28/04/2025	First Issue	LC	SG	DR
Rev	Date	Description	GIS	Chk	App

nationalgrid

Purpose: PEI REPORT - SECTION 7

Scheme: GRIMSBY TO WALPOLE

Document Title: FIGURE 7.5
LANDFILLS, WASTE AND POTENTIALLY CONTAMINATIVE PREVIOUS LAND USES

Creator: LC	Date: 28/04/2025	Checker: SG	Date: 28/04/2025	Approver: DR	Date: 28/04/2025
Document Type: FIGURE	Scale: 1:12,500	Format: A3	Sheets: 2 OF 2	Rev: A	

Contains Ordnance Survey digital map data © Crown copyright 2025. All rights reserved. Licence number AC0000808122.
Contains public sector information licensed under the Open Government Licence v3.0.
Derived from BGS Digital Data under Licence. British Geological Survey. ©NERC.