

The background image shows two women walking on a dirt path through a field of tall grass and wildflowers. The woman on the left is wearing a plaid shirt, a dark vest, and jeans, and is holding a leash for a black and white dog. The woman on the right is wearing a dark jacket and leggings. In the background, there are power lines and a cloudy sky.

The Great Grid Upgrade

Grimsby to Walpole

Preliminary Environmental Information Report

Volume 2 Part B Section Specific Assessments

Section 4 New Lincolnshire Connection Substation B to Refined
Weston Marsh Substation Siting Zone

Chapter 12 Air Quality

Figures

June 2025

Volume 2 Part B Section 4 Chapter 12 – Figure List

Figure number	Figure title
Figure 12.1	Construction Dust Study Area
Figure 12.2	Preliminary Affected Road Network and Local Authority Monitoring Locations

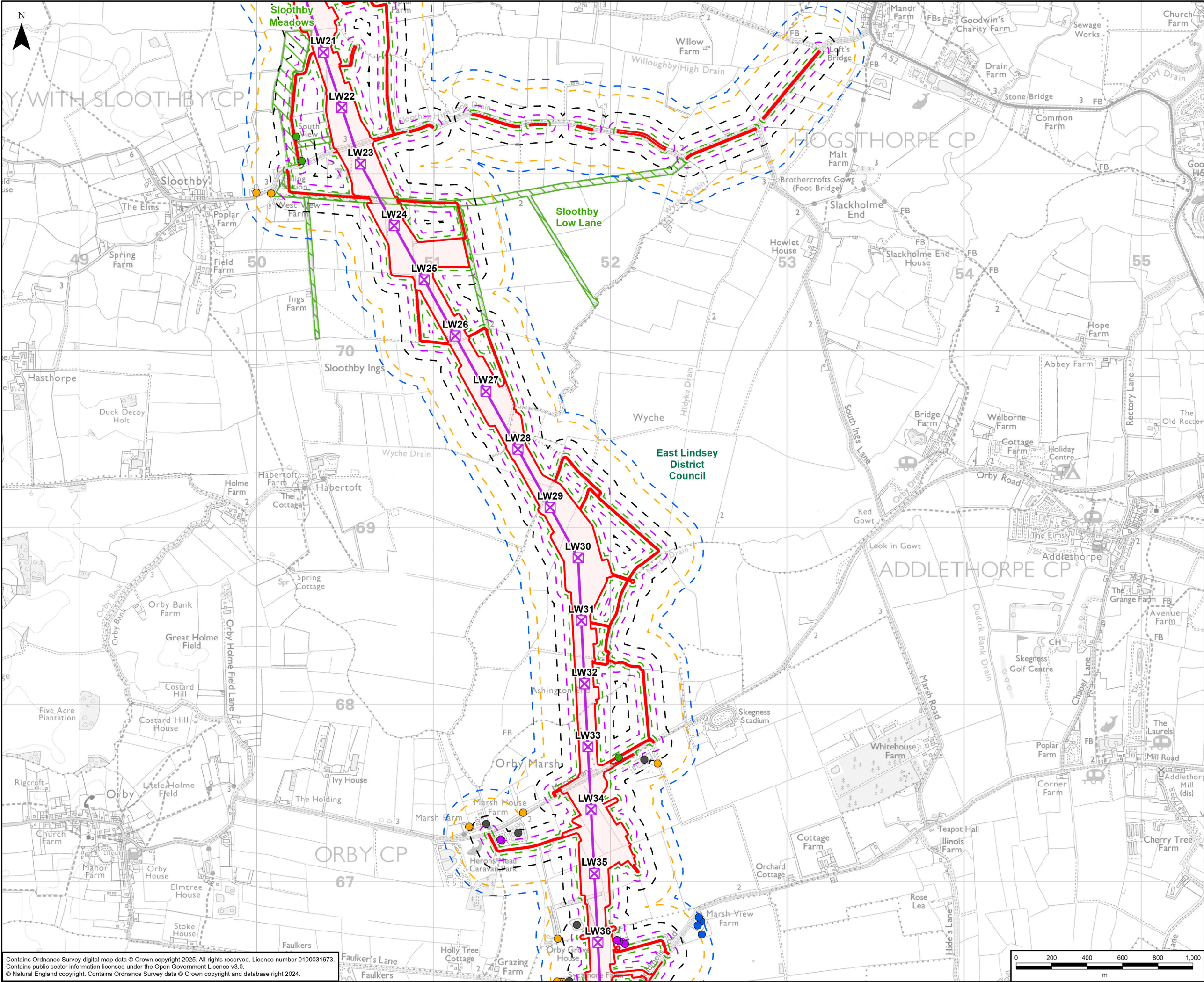

GRIMSBY TO WALPOLE LEGEND

Legend

- Draft Order Limits
- Indicative New Lattice Pylon
- Indicative New Overhead Line
- Local Authority Boundary

Construction Dust Buffer

- 20m
- 50m
- 100m
- 200m
- 250m

Human Receptor

- Within 20m
- Between 20m and 50m
- Between 50m and 100m
- Between 100m and 200m
- Between 200m and 250m

Ecological Receptor

- Local Wildlife Site

A	30/04/2025	First Issue	LC	AL	NM
Rev	Date	Description	GIS	Chk	App

nationalgrid

Purpose: PEI REPORT - SECTION 4

Scheme: GRIMSBY TO WALPOLE

Document Title: FIGURE 12.1
CONSTRUCTION DUST STUDY AREA

Creator: LC	Date: 30/04/2025	Checker: AL	Date: 30/04/2025	Approver: NM	Date: 30/04/2025
Document Type: FIGURE	Scale: 1:20,000	Format: A3	Sheets: 2 OF 12	Rev: A	

Contains Ordnance Survey digital map data © Crown copyright 2025. All rights reserved. Licence number 0100031673.
Contains public sector information licensed under the Open Government Licence v3.0.
© Natural England copyright. Contains Ordnance Survey data © Crown copyright and database right 2024.

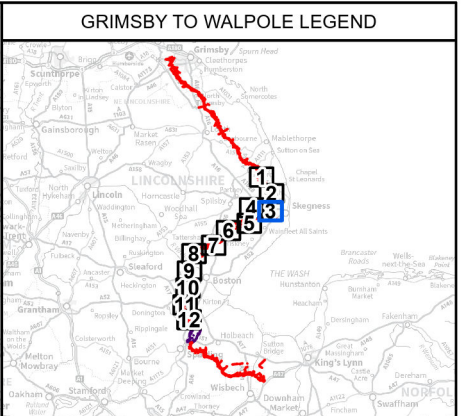
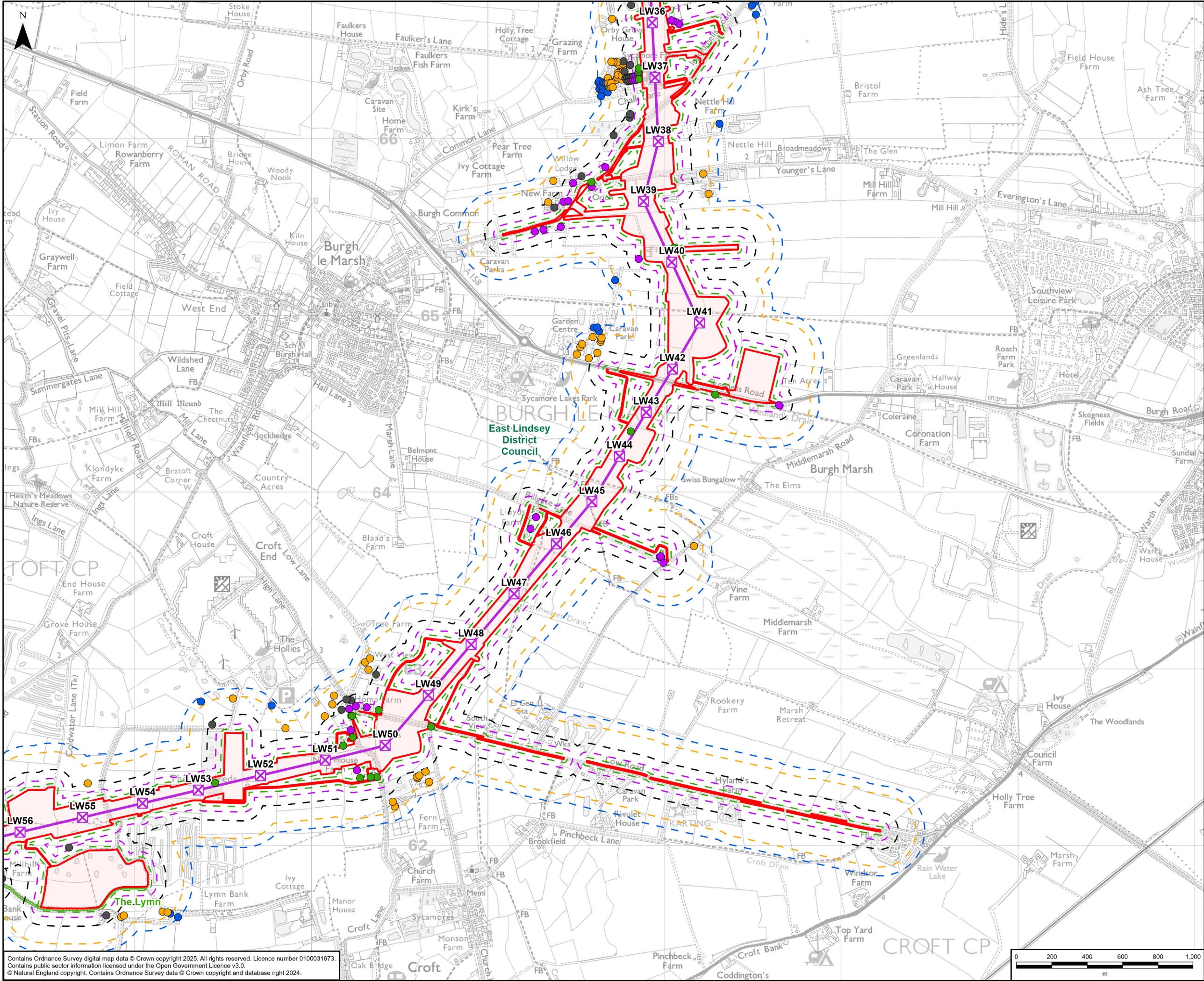

Legend

- Draft Order Limits
- X Indicative New Lattice Pylon
- Indicative New Overhead Line
- Local Authority Boundary

Construction Dust Buffer

- 20m
- 50m
- 100m
- 200m
- 250m

Human Receptor

- Within 20m
- Between 20m and 50m
- Between 50m and 100m
- Between 100m and 200m
- Between 200m and 250m

Ecological Receptor

- Local Wildlife Site

Contains Ordnance Survey digital map data © Crown copyright 2025. All rights reserved. Licence number 0100031673.
 Contains public sector information licensed under the Open Government Licence v3.0.
 © Natural England copyright. Contains Ordnance Survey data © Crown copyright and database right 2024.

A	30/04/2025	First Issue	LC	AL	NM
Rev	Date	Description	GIS	Chk	App
nationalgrid					
Purpose:		PEI REPORT - SECTION 4			
Scheme:		GRIMSBY TO WALPOLE			
Document Title:		FIGURE 12.1 CONSTRUCTION DUST STUDY AREA			
Creator:	Date:	Checker:	Date:	Approver:	Date:
LC	30/04/2025	AL	30/04/2025	NM	30/04/2025
Document Type:	Scale:	Format:	Sheets:	Rev:	
FIGURE	1:20,000	A3	3 OF 12	A	

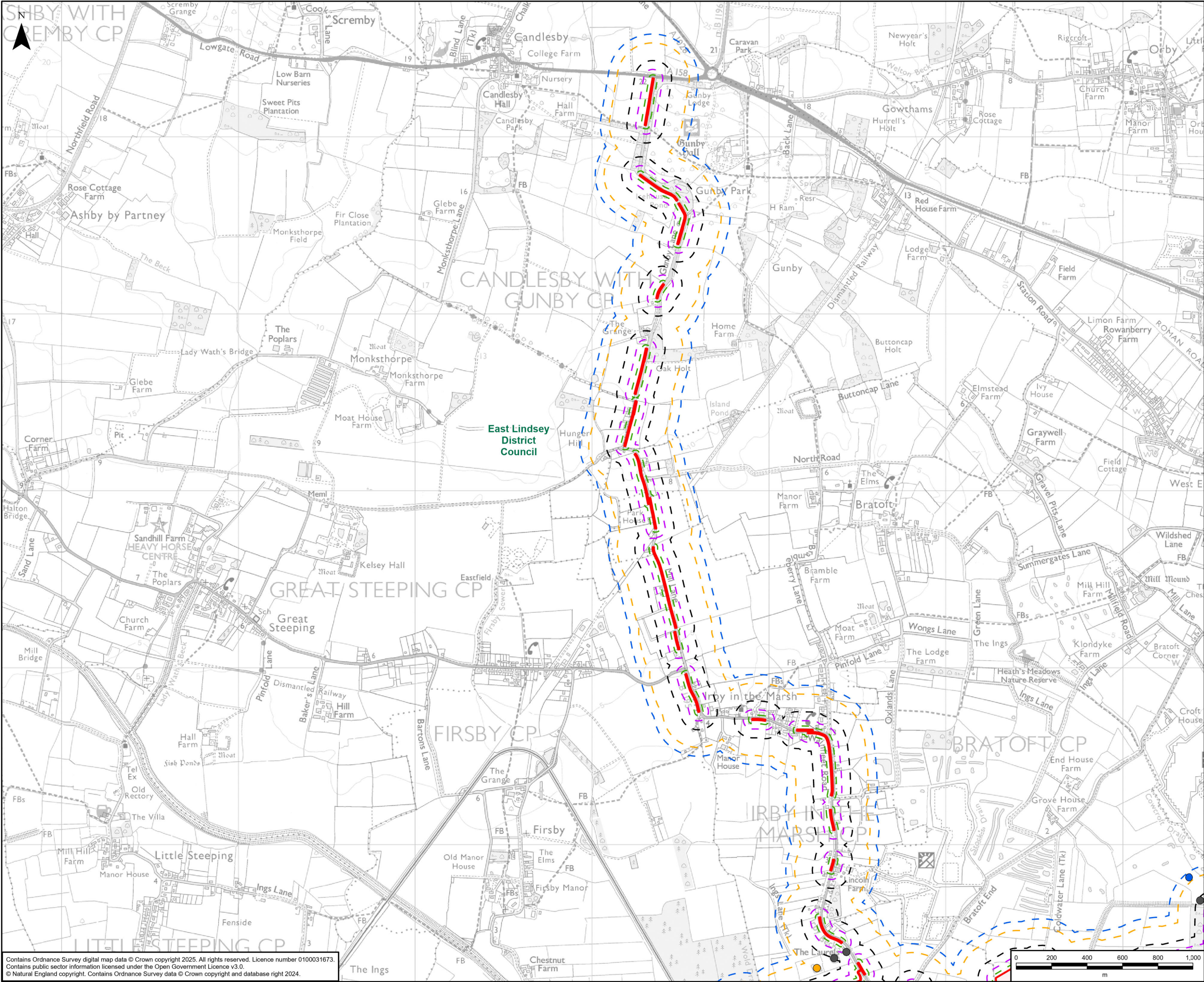

GRIMSBY TO WALPOLE LEGEND

Legend

- Draft Order Limits
- Indicative New Lattice Pylon
- Indicative New Overhead Line
- Local Authority Boundary

Construction Dust Buffer

- 20m
- 50m
- 100m
- 200m
- 250m

Human Receptor

- Within 20m
- Between 50m and 100m
- Between 100m and 200m
- Between 200m and 250m

A	30/04/2025	First Issue	LC	AL	NM
Rev	Date	Description	GIS	Chk	App

Purpose: PEI REPORT - SECTION 4

Scheme: GRIMSBY TO WALPOLE

Document Title: FIGURE 12.1
CONSTRUCTION DUST STUDY AREA

Creator: LC	Date: 30/04/2025	Checker: AL	Date: 30/04/2025	Approver: NM	Date: 30/04/2025
Document Type: FIGURE	Scale: 1:20,000	Format: A3	Sheets: 4 OF 12	Rev: A	

Contains Ordnance Survey digital map data © Crown copyright 2025. All rights reserved. Licence number 0100031673.
Contains public sector information licensed under the Open Government Licence v3.0.
© Natural England copyright. Contains Ordnance Survey data © Crown copyright and database right 2024.

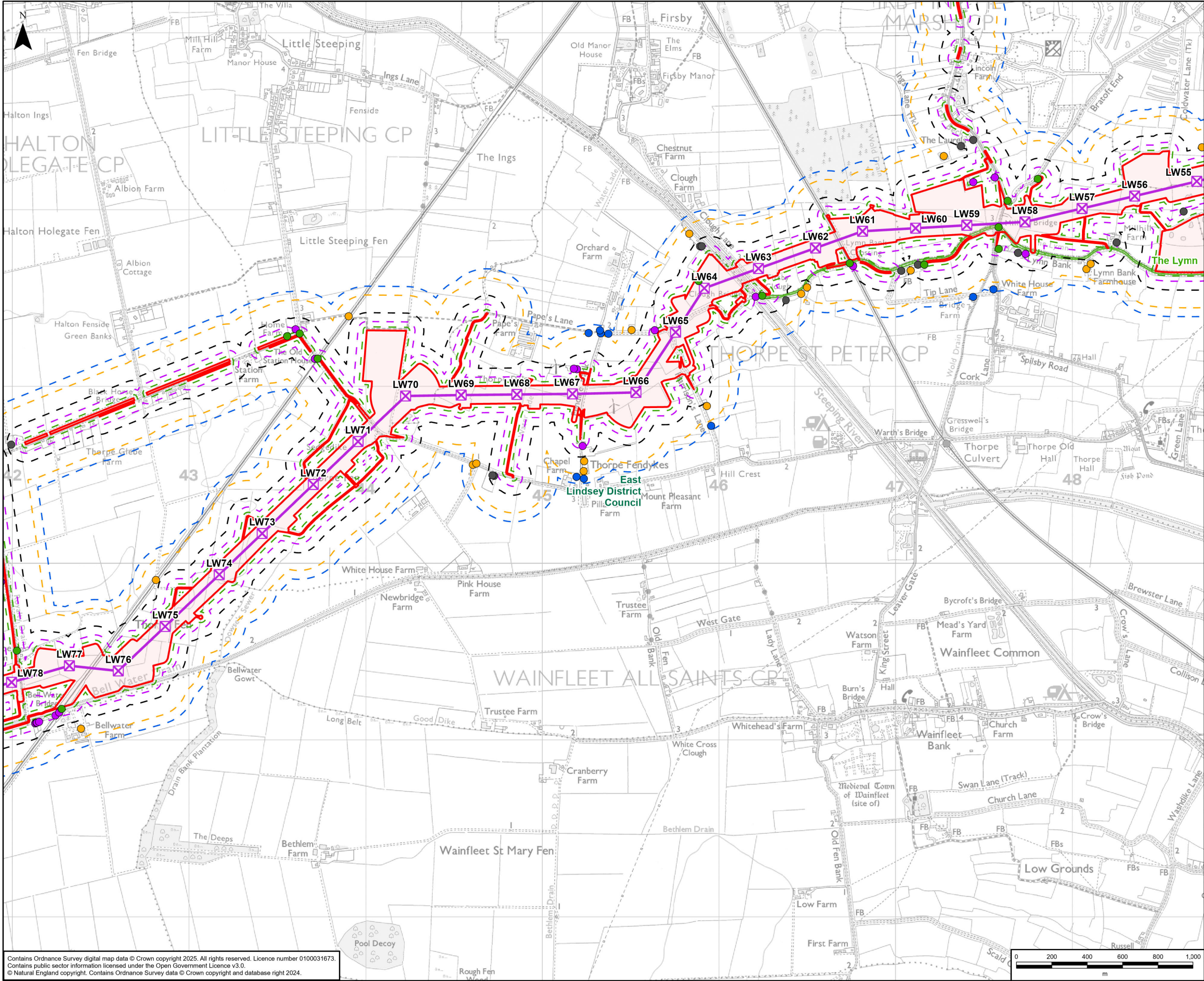

GRIMSBY TO WALPOLE LEGEND

Legend

- Draft Order Limits
- Indicative New Lattice Pylon
- Indicative New Overhead Line
- Local Authority Boundary

Construction Dust Buffer

- 20m
- 50m
- 100m
- 200m
- 250m

Human Receptor

- Within 20m
- Between 20m and 50m
- Between 50m and 100m
- Between 100m and 200m
- Between 200m and 250m

Ecological Receptor

- Local Wildlife Site

A	30/04/2025	First Issue	LC	AL	NM
Rev	Date	Description	GIS	Chk	App

nationalgrid

Purpose: PEI REPORT - SECTION 4

Scheme: GRIMSBY TO WALPOLE

Document Title: FIGURE 12.1
CONSTRUCTION DUST STUDY AREA

Creator: LC	Date: 30/04/2025	Checker: AL	Date: 30/04/2025	Approver: NM	Date: 30/04/2025
Document Type: FIGURE	Scale: 1:20,000	Format: A3	Sheets: 5 OF 12	Rev: A	

Contains Ordnance Survey digital map data © Crown copyright 2025. All rights reserved. Licence number 0100031673.
Contains public sector information licensed under the Open Government Licence v3.0.
© Natural England copyright. Contains Ordnance Survey data © Crown copyright and database right 2024.

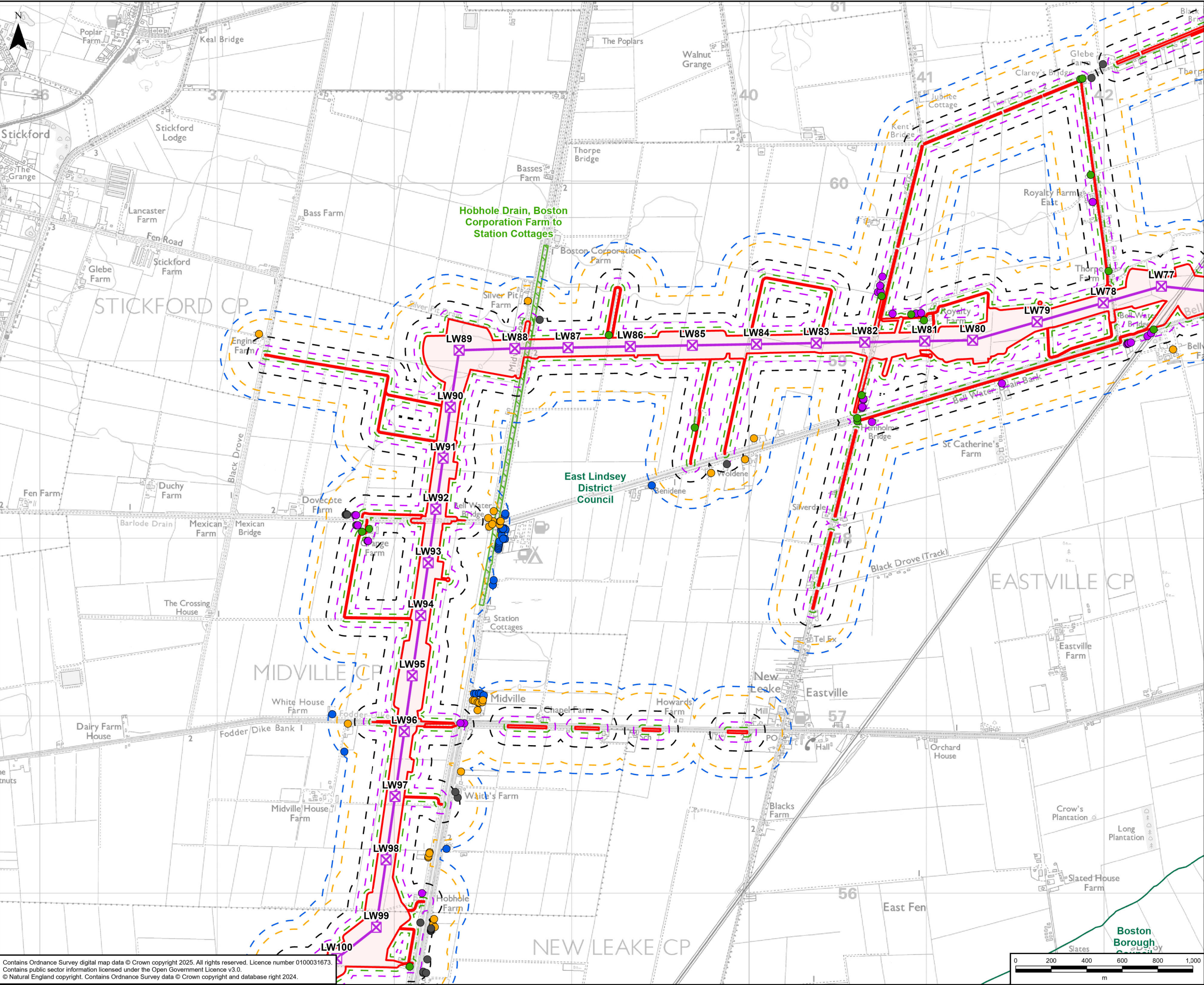

GRIMSBY TO WALPOLE LEGEND

Legend

- Draft Order Limits
- Indicative New Lattice Pylon
- Indicative New Overhead Line
- Local Authority Boundary

Construction Dust Buffer

- 20m
- 50m
- 100m
- 200m
- 250m

Human Receptor

- Within 20m
- Between 20m and 50m
- Between 50m and 100m
- Between 100m and 200m
- Between 200m and 250m

Ecological Receptor

- Local Wildlife Site

A	30/04/2025	First Issue	LC	AL	NM
Rev	Date	Description	GIS	Chk	App

Purpose: PEI REPORT - SECTION 4

Scheme: GRIMSBY TO WALPOLE

Document Title: FIGURE 12.1 CONSTRUCTION DUST STUDY AREA

Creator: LC	Date: 30/04/2025	Checker: AL	Date: 30/04/2025	Approver: NM	Date: 30/04/2025
Document Type: FIGURE	Scale: 1:20,000	Format: A3	Sheets: 6 OF 12	Rev: A	

Contains Ordnance Survey digital map data © Crown copyright 2025. All rights reserved. Licence number 0100031673.
Contains public sector information licensed under the Open Government Licence v3.0.
© Natural England copyright. Contains Ordnance Survey data © Crown copyright and database right 2024.

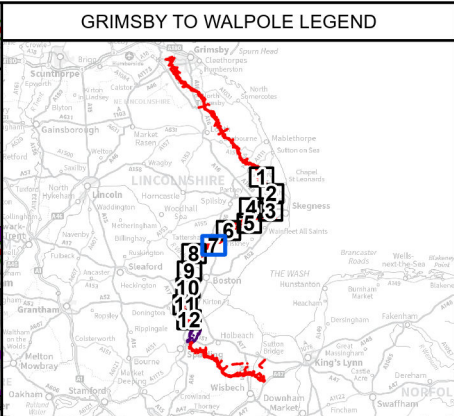
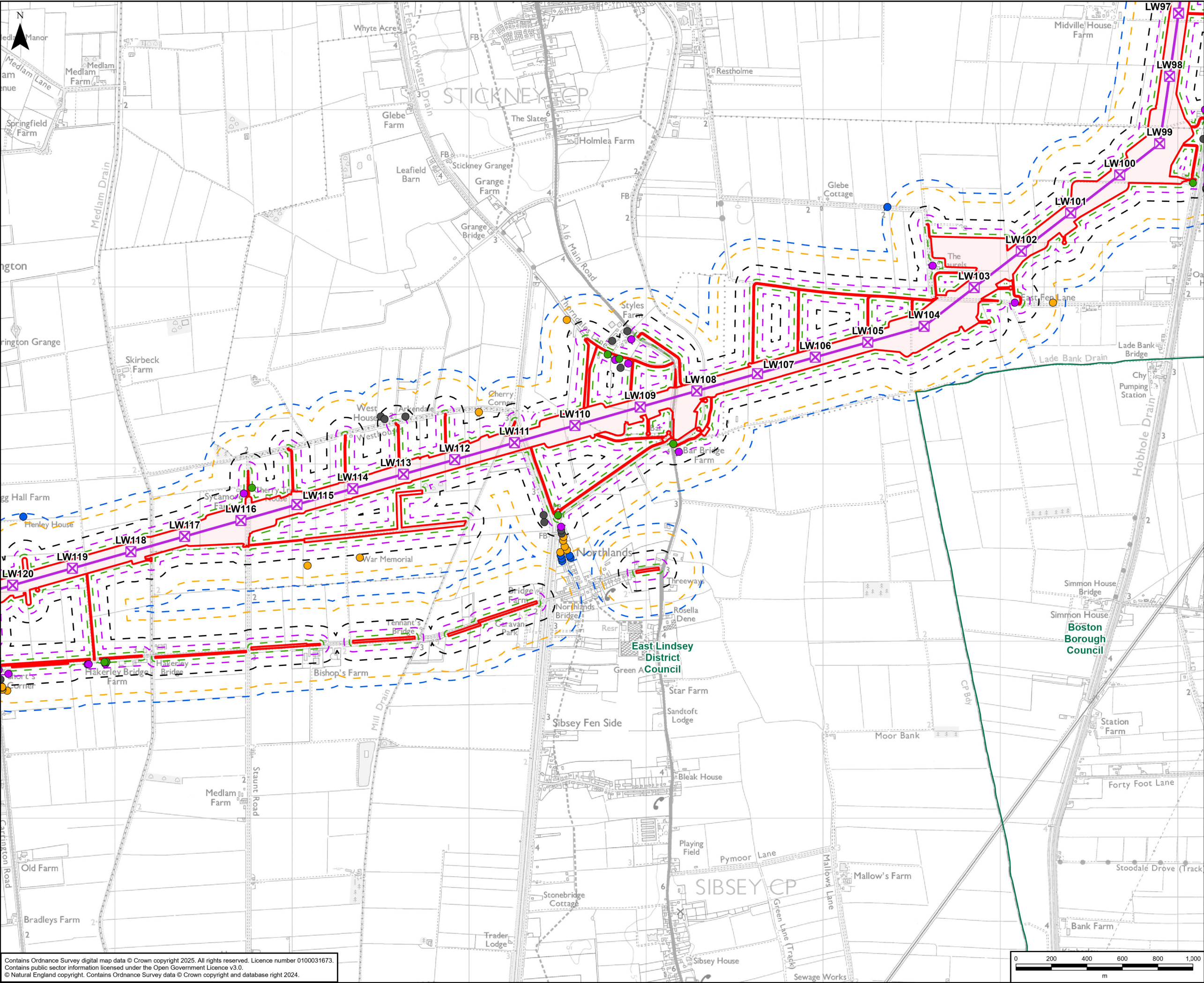

- Legend**
- Draft Order Limits
 - Indicative New Lattice Pylon
 - Indicative New Overhead Line
 - Local Authority Boundary
- Construction Dust Buffer**
- 20m
 - 50m
 - 100m
 - 200m
 - 250m
- Human Receptor**
- Within 20m
 - Between 20m and 50m
 - Between 50m and 100m
 - Between 100m and 200m
 - Between 200m and 250m

Contains Ordnance Survey digital map data © Crown copyright 2025. All rights reserved. Licence number 0100031673.
Contains public sector information licensed under the Open Government Licence v3.0.
© Natural England copyright. Contains Ordnance Survey data © Crown copyright and database right 2024.

A	30/04/2025	First Issue	LC	AL	NM
Rev	Date	Description	GIS	Chk	App
nationalgrid					
Purpose: PEI REPORT - SECTION 4					
Scheme: GRIMSBY TO WALPOLE					
Document Title: FIGURE 12.1 CONSTRUCTION DUST STUDY AREA					
Creator: LC	Date: 30/04/2025	Checker: AL	Date: 30/04/2025	Approver: NM	Date: 30/04/2025
Document Type: FIGURE	Scale: 1:20,000	Format: A3	Sheets: 7 OF 12	Rev: A	

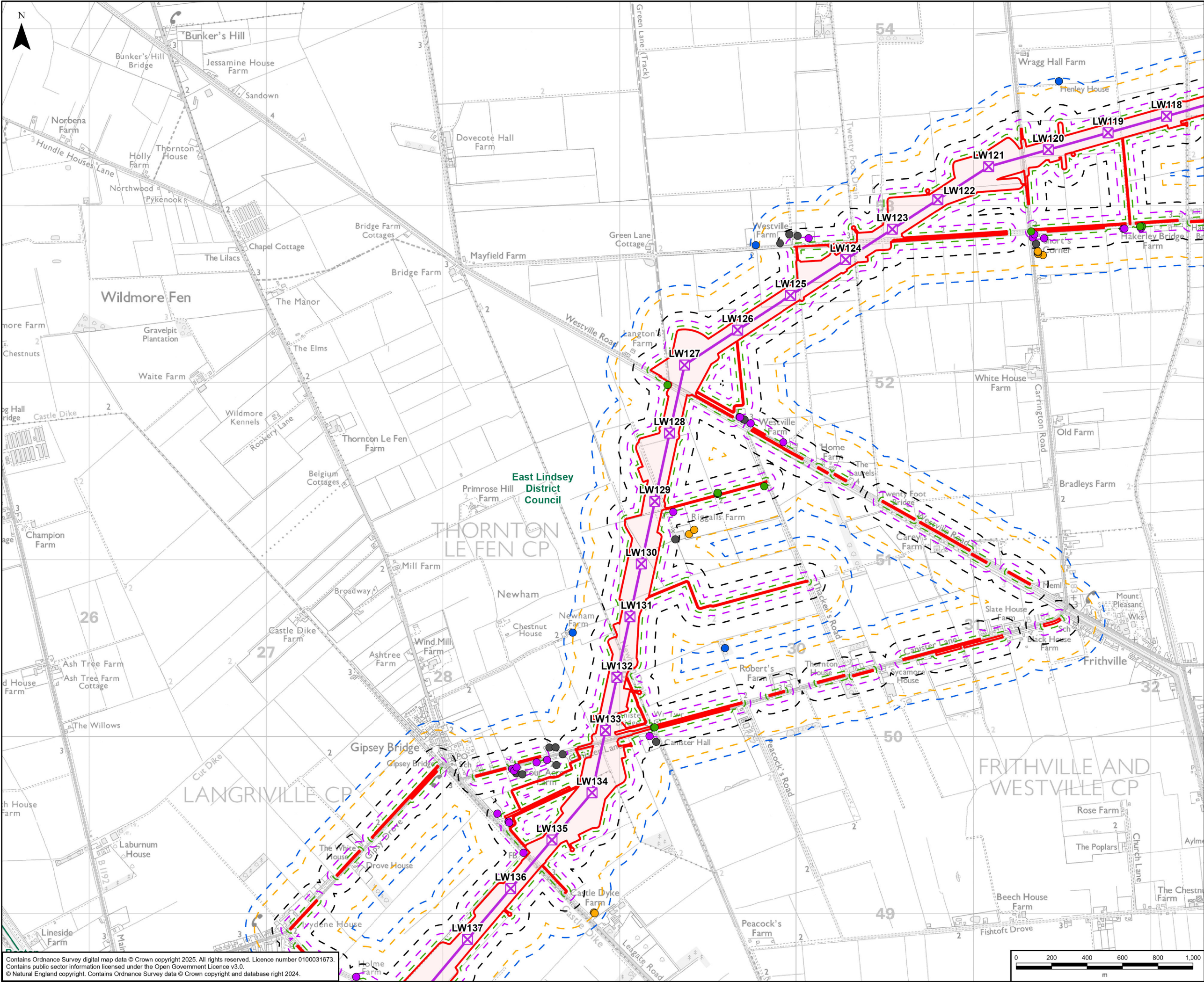

GRIMSBY TO WALPOLE LEGEND

Legend

- Draft Order Limits
- Indicative New Lattice Pylon
- Indicative New Overhead Line
- Local Authority Boundary

Construction Dust Buffer

- 20m
- 50m
- 100m
- 200m
- 250m

Human Receptor

- Within 20m
- Between 20m and 50m
- Between 50m and 100m
- Between 100m and 200m
- Between 200m and 250m

A	30/04/2025	First Issue	LC	AL	NM
Rev	Date	Description	GIS	Chk	App

Purpose: PEI REPORT - SECTION 4

Scheme: GRIMSBY TO WALPOLE

Document Title: FIGURE 12.1 CONSTRUCTION DUST STUDY AREA

Creator: LC	Date: 30/04/2025	Checker: AL	Date: 30/04/2025	Approver: NM	Date: 30/04/2025
Document Type: FIGURE	Scale: 1:20,000	Format: A3	Sheets: 8 OF 12	Rev: A	

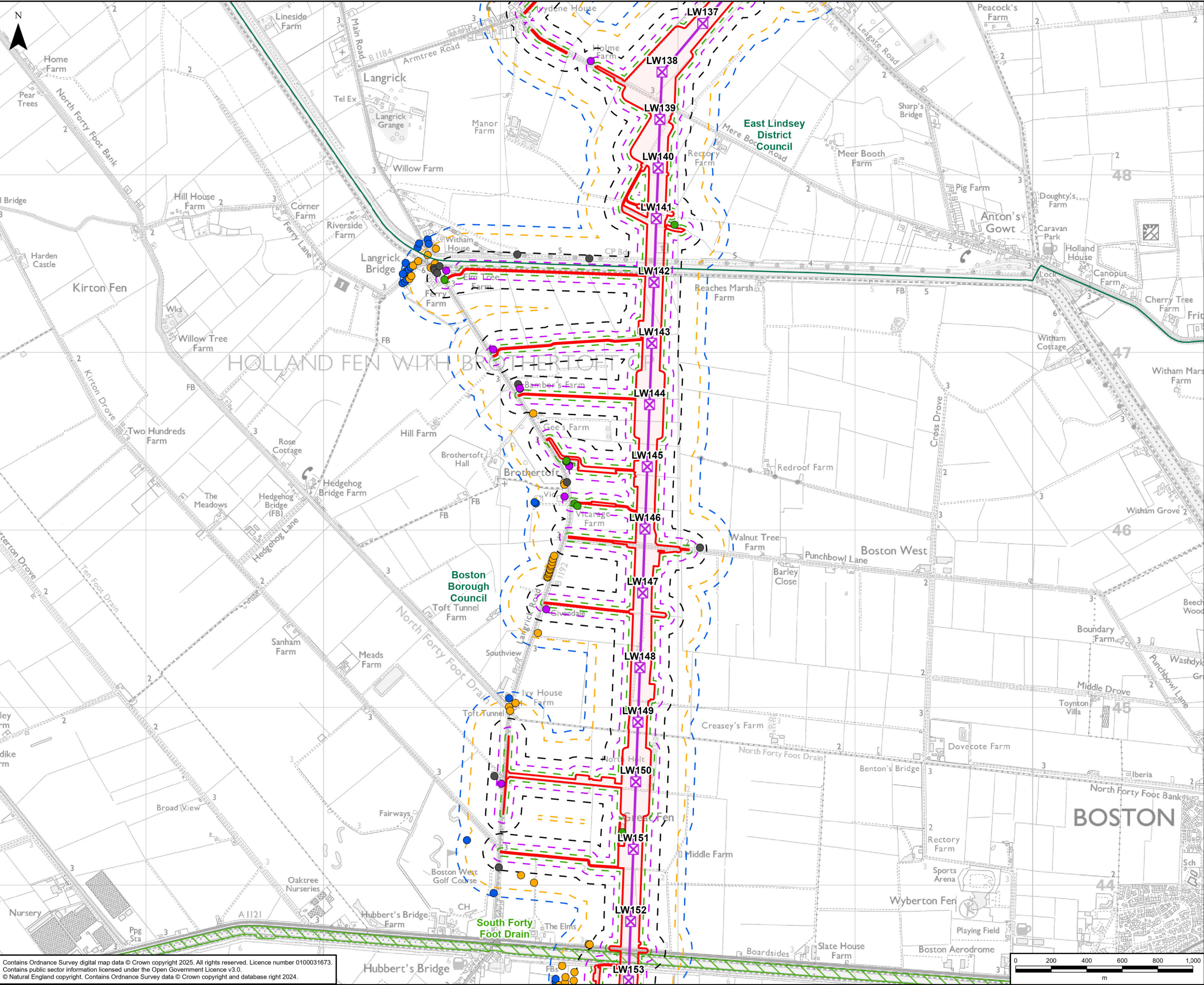

GRIMSBY TO WALPOLE LEGEND

Legend

- Draft Order Limits
- Indicative New Lattice Pylon
- Indicative New Overhead Line
- Local Authority Boundary

Construction Dust Buffer

- 20m
- 50m
- 100m
- 200m
- 250m

Human Receptor

- Within 20m
- Between 20m and 50m
- Between 50m and 100m
- Between 100m and 200m
- Between 200m and 250m

Ecological Receptor

- Local Wildlife Site

A	30/04/2025	First Issue	LC	AL	NM
Rev	Date	Description	GIS	Chk	App

nationalgrid

Purpose: PEI REPORT - SECTION 4

Scheme: GRIMSBY TO WALPOLE

Document Title: FIGURE 12.1
CONSTRUCTION DUST STUDY AREA

Creator: LC	Date: 30/04/2025	Checker: AL	Date: 30/04/2025	Approver: NM	Date: 30/04/2025
Document Type: FIGURE	Scale: 1:20,000	Format: A3	Sheets: 9 OF 12	Rev: A	

Contains Ordnance Survey digital map data © Crown copyright 2025. All rights reserved. Licence number 0100031673.
Contains public sector information licensed under the Open Government Licence v3.0.
© Natural England copyright. Contains Ordnance Survey data © Crown copyright and database right 2024.

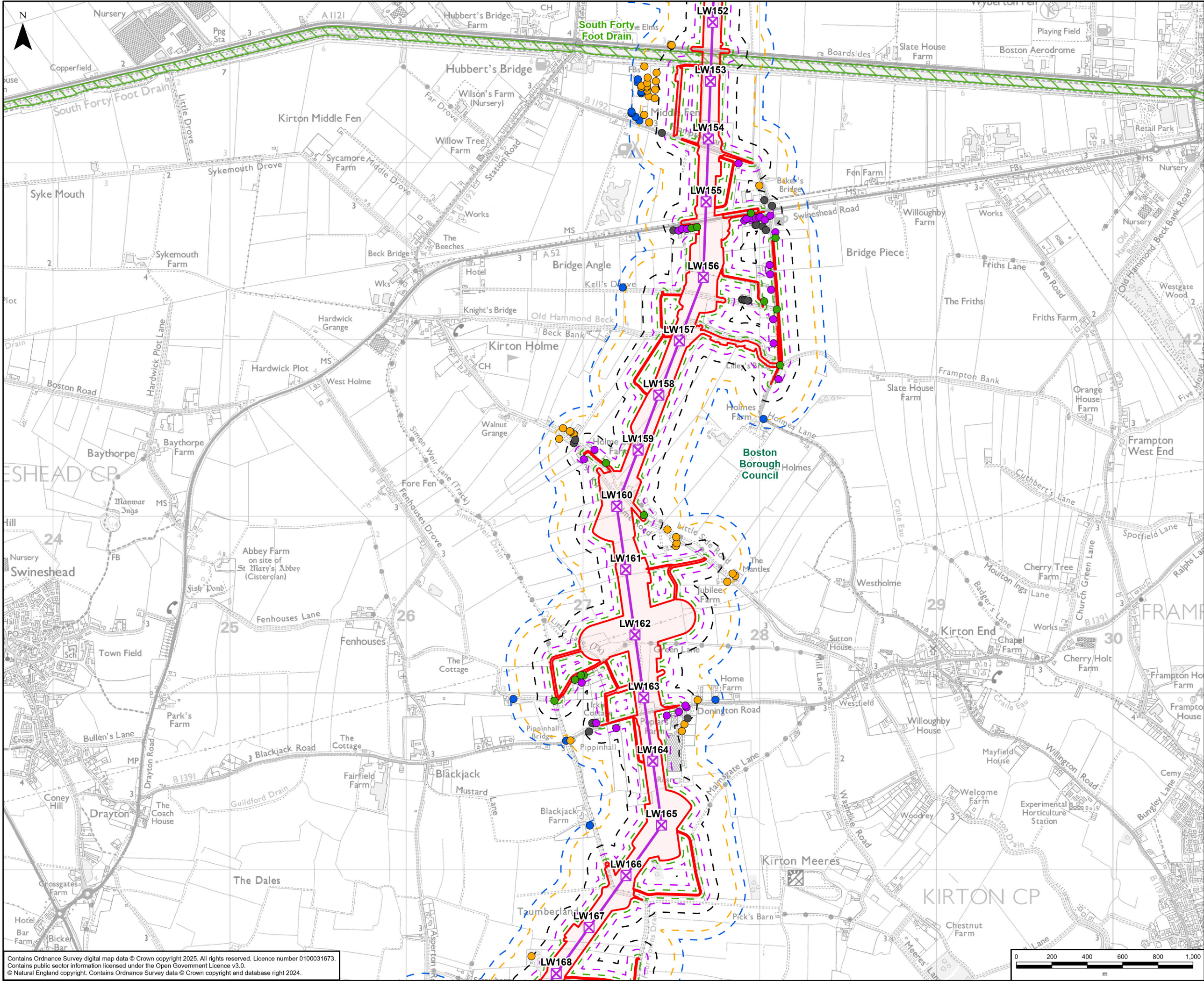

GRIMSBY TO WALPOLE LEGEND

Legend

- Draft Order Limits
- Indicative New Lattice Pylon
- Indicative New Overhead Line
- Local Authority Boundary
- Construction Dust Buffer
 - 20m
 - 50m
 - 100m
 - 200m
 - 250m
- Human Receptor
 - Within 20m
 - Between 20m and 50m
 - Between 50m and 100m
 - Between 100m and 200m
 - Between 200m and 250m
- Ecological Receptor
 - Local Wildlife Site

A	30/04/2025	First Issue	LC	AL	NM
Rev	Date	Description	GIS	Chk	App

nationalgrid

Purpose: PEI REPORT - SECTION 4

Scheme: GRIMSBY TO WALPOLE

Document Title: FIGURE 12.1
CONSTRUCTION DUST STUDY AREA

Creator: LC	Date: 30/04/2025	Checker: AL	Date: 30/04/2025	Approver: NM	Date: 30/04/2025
Document Type: FIGURE	Scale: 1:20,000	Format: A3	Sheets: 10 OF 12	Rev: A	

Contains Ordnance Survey digital map data © Crown copyright 2025. All rights reserved. Licence number 0100031673.
Contains public sector information licensed under the Open Government Licence v3.0.
© Natural England copyright. Contains Ordnance Survey data © Crown copyright and database right 2024.

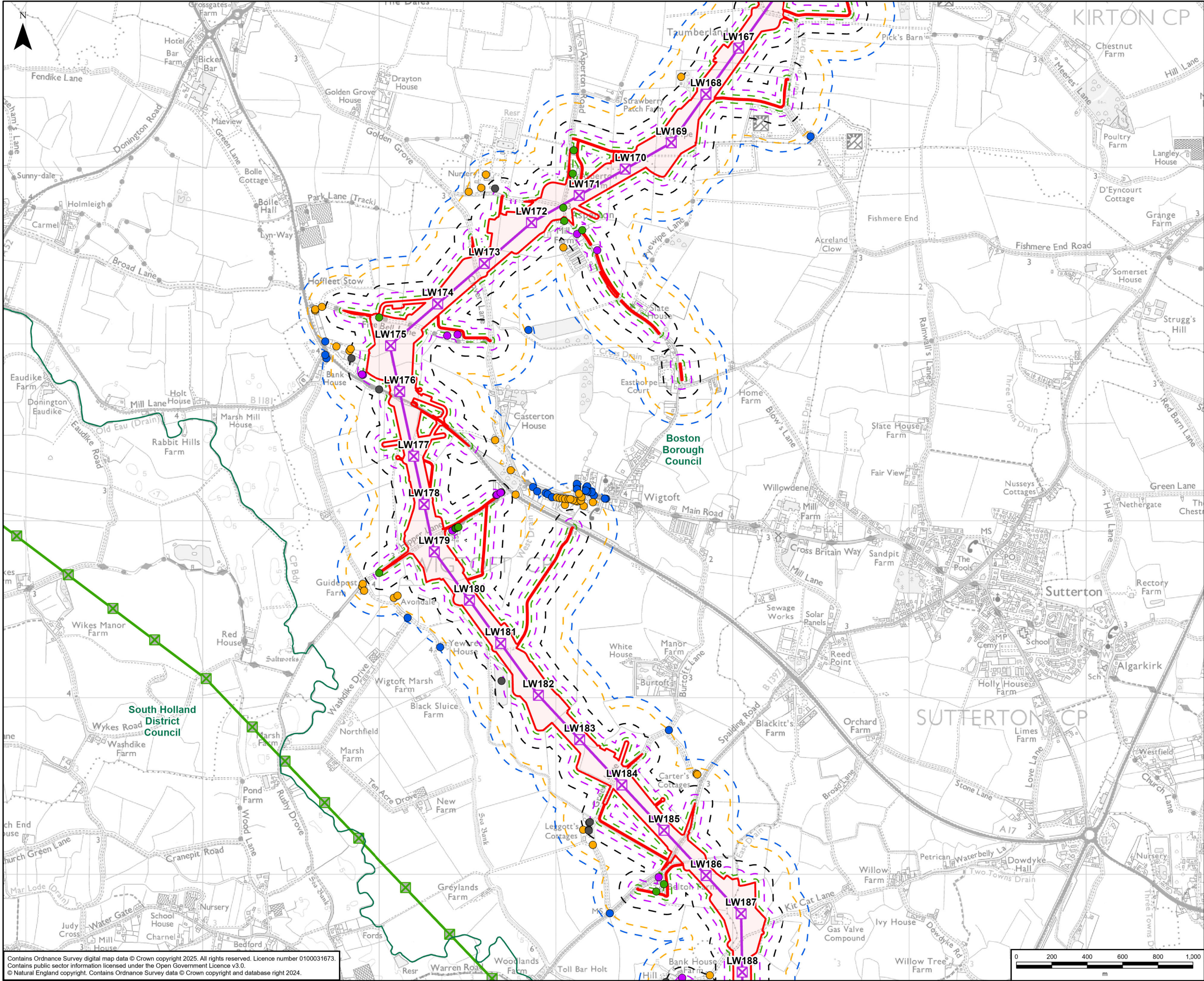

GRIMSBY TO WALPOLE LEGEND

Legend

- Draft Order Limits
- Indicative New Lattice Pylon
- Existing Lattice Pylon - Not Affected
- Indicative New Overhead Line
- Existing Overhead Line - Not Affected
- Local Authority Boundary

Construction Dust Buffer

- 20m
- 50m
- 100m
- 200m
- 250m

Human Receptor

- Within 20m
- Between 20m and 50m
- Between 50m and 100m
- Between 100m and 200m
- Between 200m and 250m

A	30/04/2025	First Issue	LC	AL	NM
Rev	Date	Description	GIS	Chk	App

Purpose:	PEI REPORT - SECTION 4
Scheme:	GRIMSBY TO WALPOLE
Document Title:	FIGURE 12.1 CONSTRUCTION DUST STUDY AREA

Creator:	Date:	Checker:	Date:	Approver:	Date:
LC	30/04/2025	AL	30/04/2025	NM	30/04/2025
Document Type:	Scale:	Format:	Sheets:	Rev:	
FIGURE	1:20,000	A3	11 OF 12	A	

Contains Ordnance Survey digital map data © Crown copyright 2025. All rights reserved. Licence number 0100031673.
Contains public sector information licensed under the Open Government Licence v3.0.
© Natural England copyright. Contains Ordnance Survey data © Crown copyright and database right 2024.

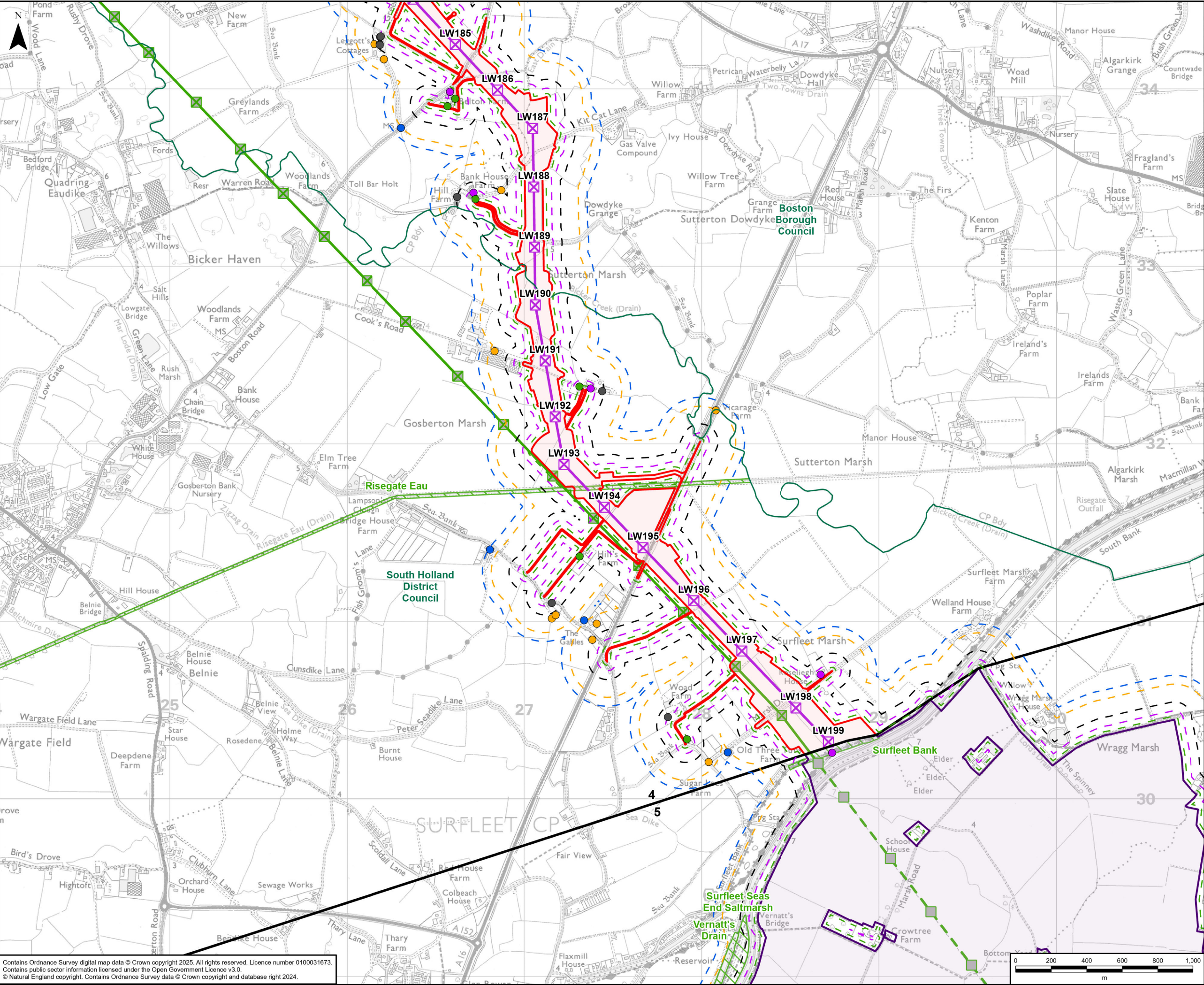

GRIMSBY TO WALPOLE LEGEND

Legend

- Draft Order Limits
- Refined Weston Marsh Substation Siting Zone
- Route Section Break
- Indicative New Lattice Pylon
- Existing Lattice Pylon - Within Weston Marsh Siting Zone that May Be Modified
- Existing Lattice Pylon - Not Affected
- Indicative New Overhead Line
- Existing Overhead Line - Not Affected
- Existing Overhead Line - Within Weston Marsh Siting Zone that May Be Modified
- Local Authority Boundary

Construction Dust Buffer

- 20m
- 50m
- 100m
- 200m
- 250m

Human Receptor

- Within 20m
- Between 20m and 50m
- Between 50m and 100m
- Between 100m and 200m
- Between 200m and 250m

Ecological Receptor

- Local Wildlife Site

A	30/04/2025	First Issue	LC	AL	NM
Rev	Date	Description	GIS	Chk	App

nationalgrid

Purpose: PEI REPORT - SECTION 4

Scheme: GRIMSBY TO WALPOLE

Document Title: FIGURE 12.1 CONSTRUCTION DUST STUDY AREA

Creator: LC	Date: 30/04/2025	Checker: AL	Date: 30/04/2025	Approver: NM	Date: 30/04/2025
Document Type: FIGURE	Scale: 1:20,000	Format: A3	Sheets: 12 OF 12	Rev: A	

0 200 400 600 800 1,000

m

Contains Ordnance Survey digital map data © Crown copyright 2025. All rights reserved. Licence number 0100031673. Contains public sector information licensed under the Open Government Licence v3.0. © Natural England copyright. Contains Ordnance Survey data © Crown copyright and database right 2024.

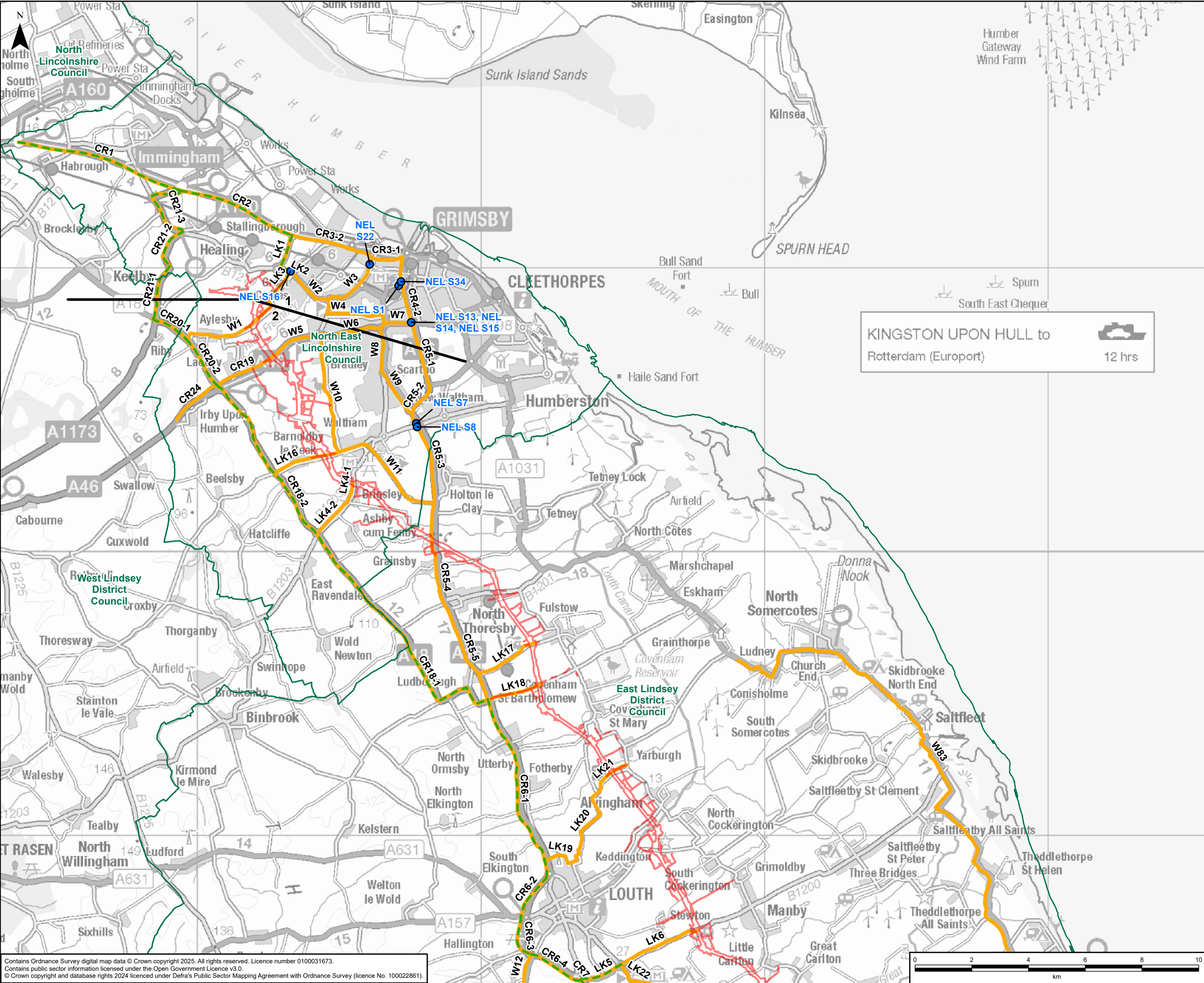

GRIMSBY TO WALPOLE LEGEND

Legend

Draft Order Limits

Route Section Break

Air Quality Monitoring Location

Affected Road Network

Construction Traffic Route

Local Authority Boundary

CR: Core Route

LK: Local Link

W: Workers Access Route

NOTE:

For further explanation of construction traffic routes see the Traffic and Movement chapter of PEI Report Volume 3 Part A Appendix 4B Environmental Impact Assessment Methodologies and Scope.

A	06/05/2025	First Issue	LC	AL	NM
Rev	Date	Description	GIS	Chk	App

Purpose:

PEI REPORT - SECTION 4

Scheme:

GRIMSBY TO WALPOLE

Document Title:

FIGURE 12.2
PRELIMINARY AFFECTED ROAD NETWORK AND LOCAL
AUTHORITY MONITORING LOCATIONS

Creator:	Date:	Checker:	Date:	Approver:	Date:
LC	06/05/2025	AL	06/05/2025	NM	06/05/2025

Document Type:	Scale:	Format:	Sheets:	Rev:
FIGURE	1:125,000	A3	1 OF 4	A

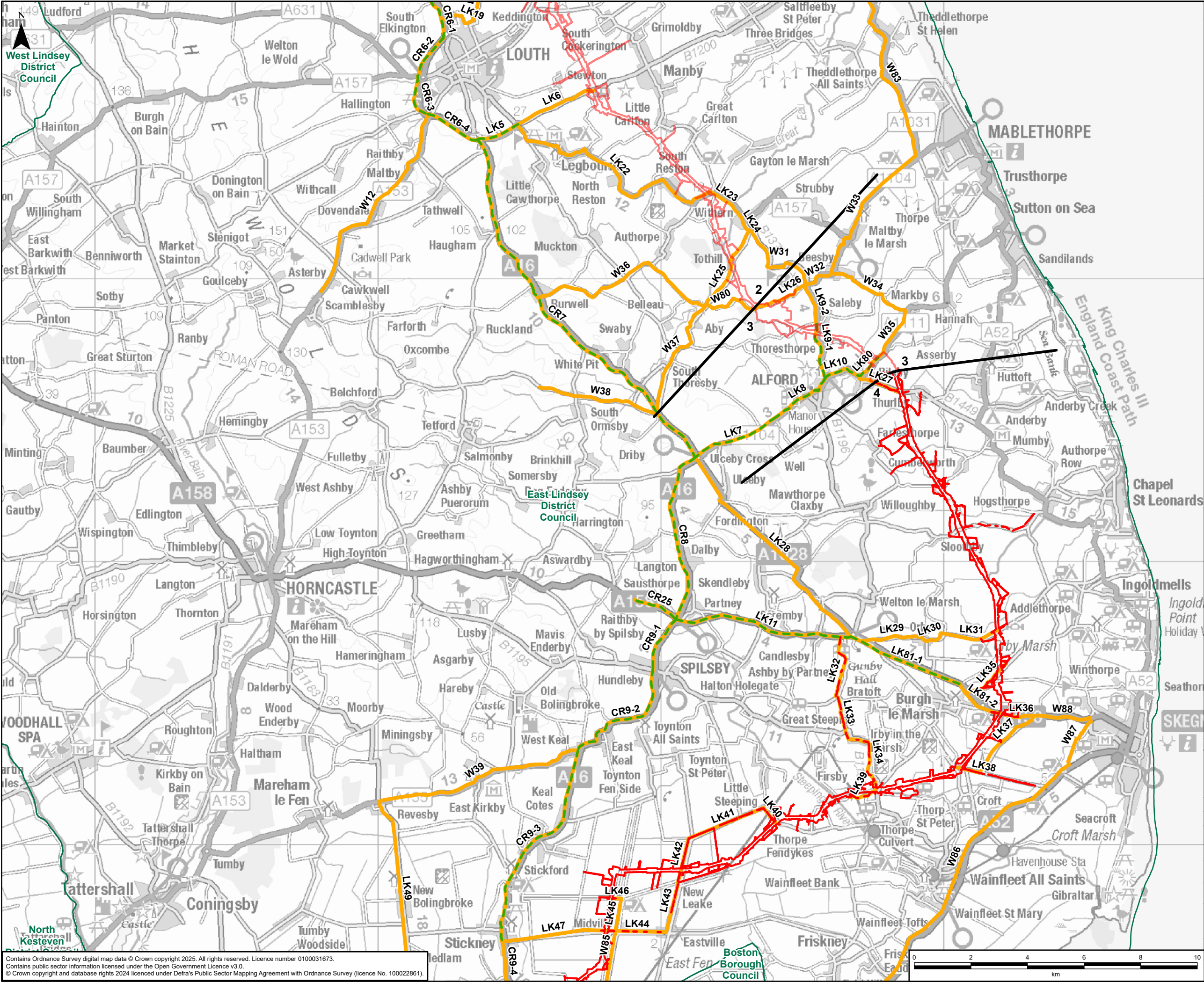

GRIMSBY TO WALPOLE LEGEND

Legend

Draft Order Limits

Route Section Break

Affected Road Network

Construction Traffic Route

Local Authority Boundary

CR: Core Route

LK: Local Link

W: Workers Access Route

NOTE:

For further explanation of construction traffic routes see the Traffic and Movement chapter of PEI Report Volume 3 Part A Appendix 4B Environmental Impact Assessment Methodologies and Scope.

A	06/05/2025	First Issue	LC	AL	NM
Rev	Date	Description	GIS	Chk	App

nationalgrid

Purpose: PEI REPORT - SECTION 4

Scheme: GRIMSBY TO WALPOLE

Document Title: FIGURE 12.2
PRELIMINARY AFFECTED ROAD NETWORK AND LOCAL AUTHORITY MONITORING LOCATIONS

Creator: LC	Date: 06/05/2025	Checker: AL	Date: 06/05/2025	Approver: NM	Date: 06/05/2025
Document Type: FIGURE	Scale: 1:125,000	Format: A3	Sheets: 2 OF 4	Rev: A	

Contains Ordnance Survey digital map data © Crown copyright 2025. All rights reserved. Licence number 0100031673.
Contains public sector information licensed under the Open Government Licence v3.0.
© Crown copyright and database rights 2024 licenced under Defra's Public Sector Mapping Agreement with Ordnance Survey (licence No. 100022861).
Document Path: \\eu.aecomnet.com\EMIA\UK\IUKNCL2\Jobs\60721024 Grimsby to Walpole\02_Maps\PEIR\Volume 2\Part B\G2W_PEIR_2_B_Chapter_12_Air_Quality_Figures.aprx

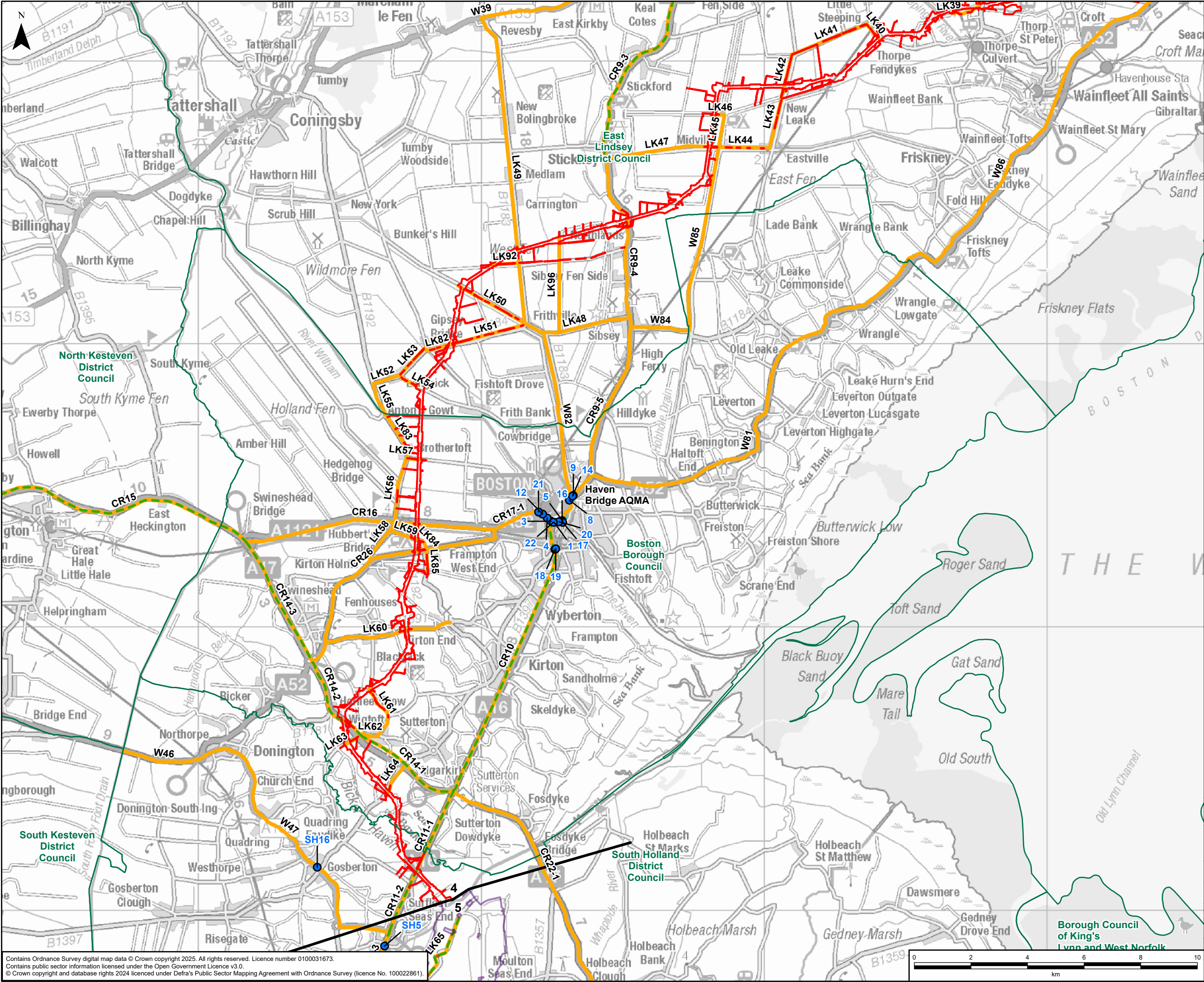

GRIMSBY TO WALPOLE LEGEND

Legend

- Draft Order Limits
- Refined Weston Marsh Substation Siting Zone
- Route Section Break
- Air Quality Monitoring Location
- Affected Road Network
- Construction Traffic Route
- Air Quality Management Area
- Local Authority Boundary

CR: Core Route
LK: Local Link
W: Workers Access Route

NOTE:
For further explanation of construction traffic routes see the Traffic and Movement chapter of
PEI Report Volume 3 Part A Appendix 4B
Environmental Impact Assessment
Methodologies and Scope.

A	06/05/2025	First Issue	LC	AL	NM
Rev	Date	Description	GIS	Chk	App

nationalgrid

Purpose: PEI REPORT - SECTION 4

Scheme: GRIMSBY TO WALPOLE

Document Title: **FIGURE 12.2**
PRELIMINARY AFFECTED ROAD NETWORK AND LOCAL
AUTHORITY MONITORING LOCATIONS

Creator: LC	Date: 06/05/2025	Checker: AL	Date: 06/05/2025	Approver: NM	Date: 06/05/2025
Document Type: FIGURE	Scale: 1:125,000	Format: A3	Sheets: 3 OF 4	Rev: A	

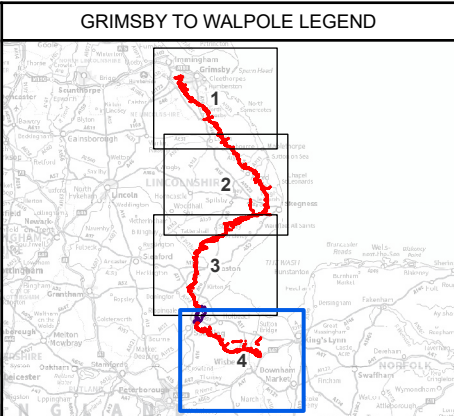
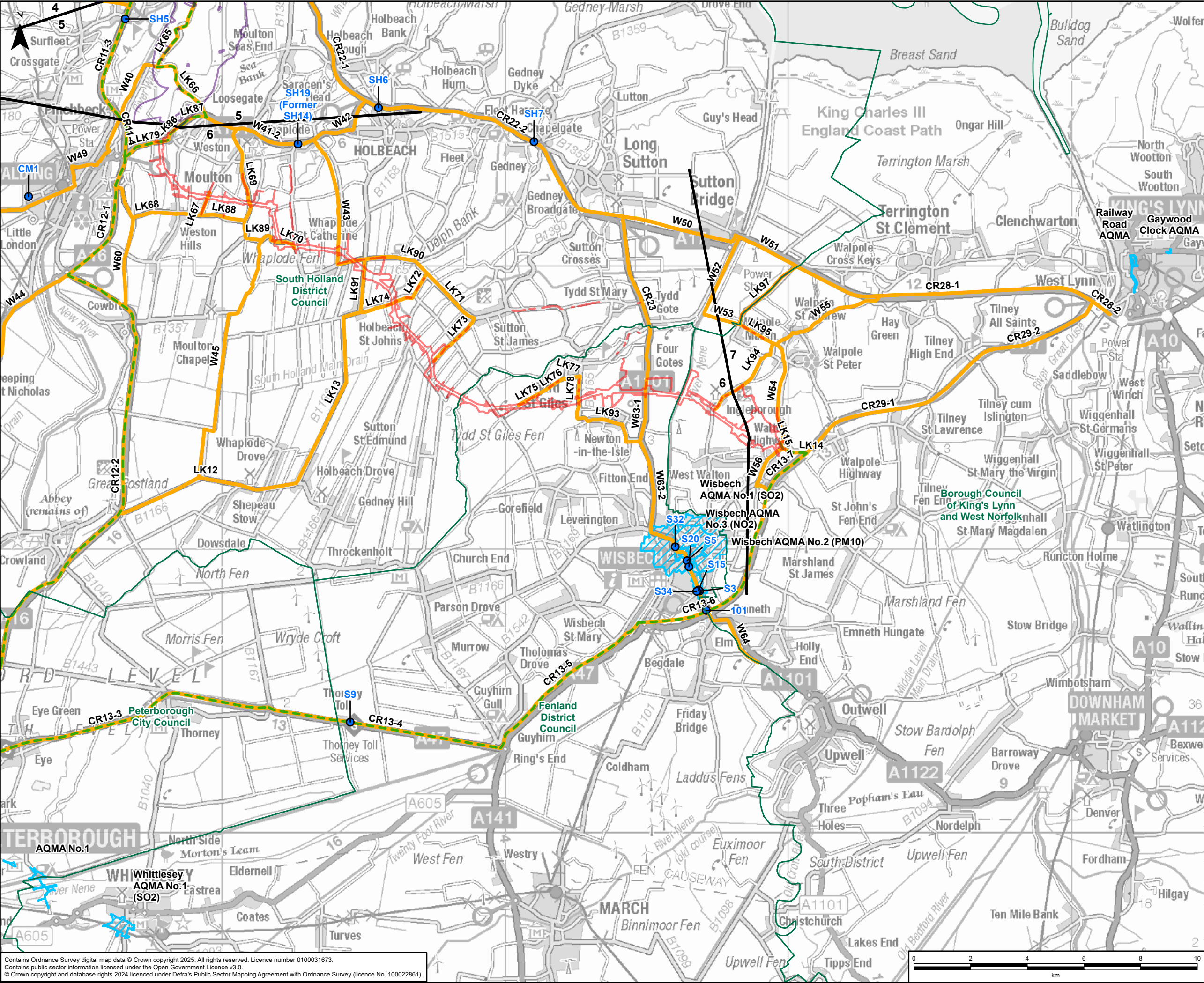

Legend

- Draft Order Limits
- Refined Weston Marsh Substation Siting Zone
- Route Section Break
- Air Quality Monitoring Location
- Affected Road Network
- Construction Traffic Route
- Air Quality Management Area
- Local Authority Boundary

CR: Core Route
LK: Local Link
W: Workers Access Route

NOTE:
For further explanation of construction traffic routes see the Traffic and Movement chapter of
PEI Report Volume 3 Part A Appendix 4B
Environmental Impact Assessment
Methodologies and Scope.

A	06/05/2025	First Issue	LC	AL	NM
Rev	Date	Description	GIS	Chk	App
nationalgrid					
Purpose:		PEI REPORT - SECTION 4			
Scheme:		GRIMSBY TO WALPOLE			
Document Title:		FIGURE 12.2 PRELIMINARY AFFECTED ROAD NETWORK AND LOCAL AUTHORITY MONITORING LOCATIONS			
Creator:	Date:	Checker:	Date:	Approver:	Date:
LC	06/05/2025	AL	06/05/2025	NM	06/05/2025
Document Type:	Scale:	Format:	Sheets:	Rev:	
FIGURE	1:125,000	A3	4 OF 4	A	